

Soils Map

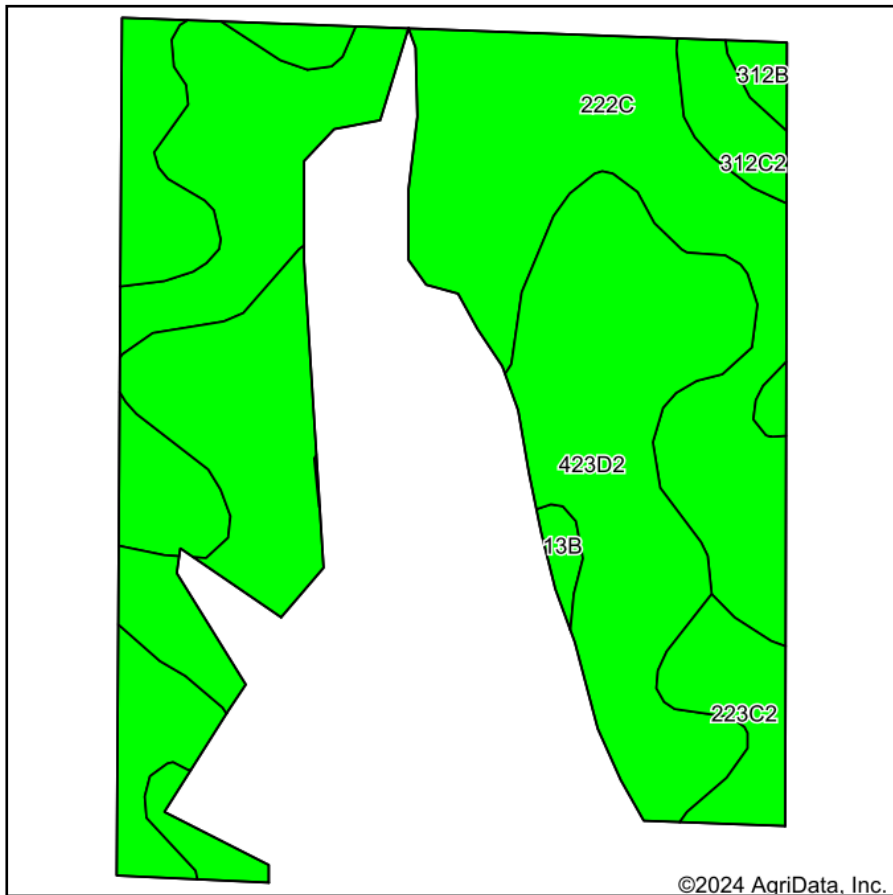

Soils data provided by USDA and NRCS.

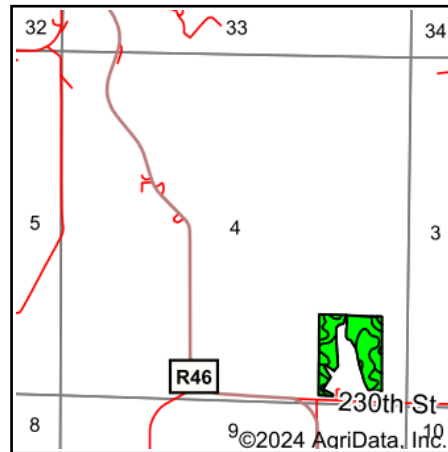

State: **Iowa**
 County: **Decatur**
 Location: **4-68N-25W**
 Township: **Eden**
 Acres: **17.67**
 Date: **6/25/2024**



Maps Provided By:



Area Symbol: IA053, Soil Area Version: 29

Code	Soil Description	Acres	Percent of field	CSR2 Legend	Non-Irr Class *c	CSR2**	*n NCCPI Overall	*n NCCPI Corn	*n NCCPI Small Grains	*n NCCPI Soybeans	
222C	Clarinda silty clay loam, 5 to 9 percent slopes	8.00	45.3%		IVw	31	59	59	53	50	
423D2	Bucknell clay loam, 9 to 14 percent slopes, moderately eroded	6.90	39.0%		IVe	8	60	57	60	44	
312C2	Seymour silty clay loam, 5 to 9 percent slopes, moderately eroded	1.59	9.0%		IIIe	56	62	62	59	57	
223C2	Rinda silty clay loam, 5 to 9 percent slopes, moderately eroded	0.86	4.9%		IVw	45	60	60	51	46	
312B	Seymour silt loam, 2 to 5 percent slopes	0.17	1.0%		IIIe	64	70	70	70	65	
13B	Olmitz-Zook-Vesser complex, 0 to 5 percent slopes	0.15	0.8%		IIw	76	79	76	55	73	
Weighted Average						3.88	25.6	*n 60	*n 58.8	*n 56.4	*n 48.4

**IA has updated the CSR values for each county to CSR2.

*n: The aggregation method is "Weighted Average using all components"

*c: Using Capabilities Class Dominant Condition Aggregation Method