

Soils Map

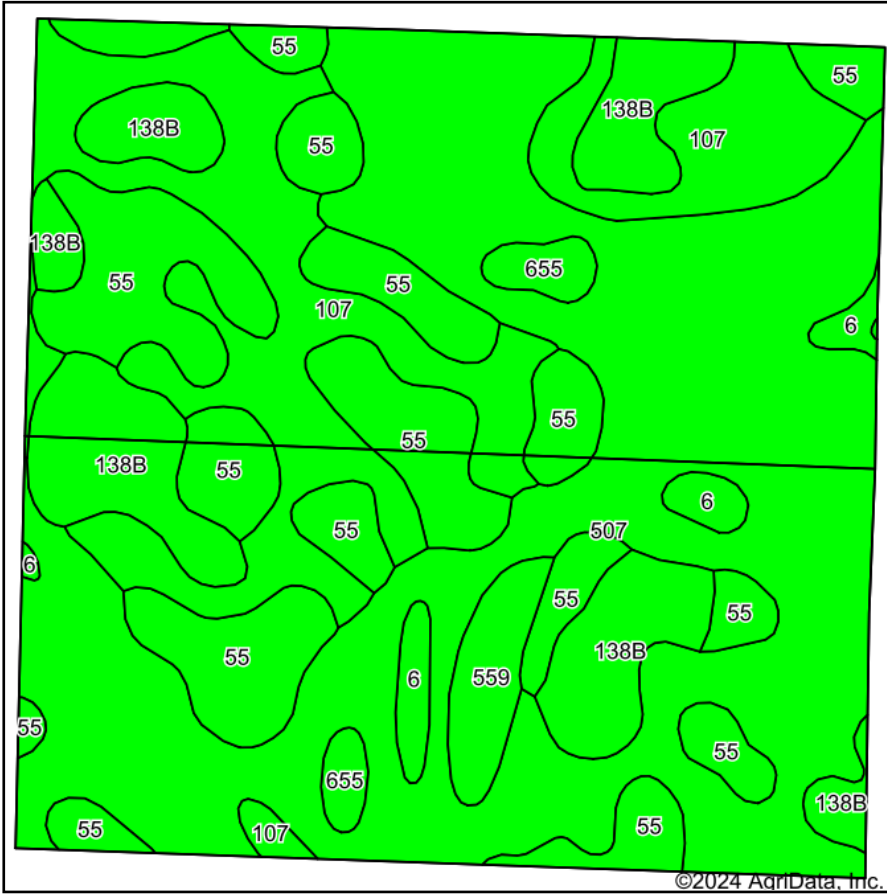

Soils data provided by USDA and NRCS.

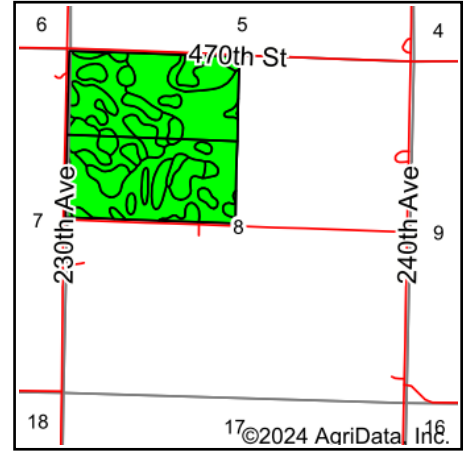

State: **Iowa**
 County: **Pocahontas**
 Location: **8-92N-32W**
 Township: **Roosevelt**
 Acres: **154.81**
 Date: **6/12/2024**



Maps Provided By:



© AgriData, Inc. 2023

www.AgriDataInc.com



Area Symbol: IA151, Soil Area Version: 30

Code	Soil Description	Acres	Percent of field	CSR2 Legend	Non-Irr Class *c	CSR2**	*n NCCPI Overall	*n NCCPI Corn	*n NCCPI Small Grains	*n NCCPI Soybeans	
507	Canisteo clay loam, 0 to 2 percent slopes	68.33	44.3%		llw	84	81	71	65	81	
55	Nicollet clay loam, 1 to 3 percent slopes	32.87	21.2%		lw	89	81	81	74	81	
107	Webster clay loam, 0 to 2 percent slopes	28.25	18.2%		llw	86	83	78	70	82	
138B	Clarion loam, 2 to 6 percent slopes	17.55	11.3%		lle	89	83	78	72	83	
559	Talcot clay loam, 32 to 40 inches to sand and gravel, 0 to 2 percent slopes	3.06	2.0%		llw	54	64	64	62	55	
6	Okoboji silty clay loam, 0 to 1 percent slopes	2.69	1.7%		llw	59	77	74	74	74	
655	Crippin loam, 1 to 3 percent slopes	2.06	1.3%		le	91	86	71	68	86	
Weighted Average						1.79	85.1	*n 81.3	*n 75.1	*n 68.8	*n 80.8

**IA has updated the CSR values for each county to CSR2.

*n: The aggregation method is "Weighted Average using all components"

*c: Using Capabilities Class Dominant Condition Aggregation Method

Soils data provided by USDA and NRCS.