

Soils Map

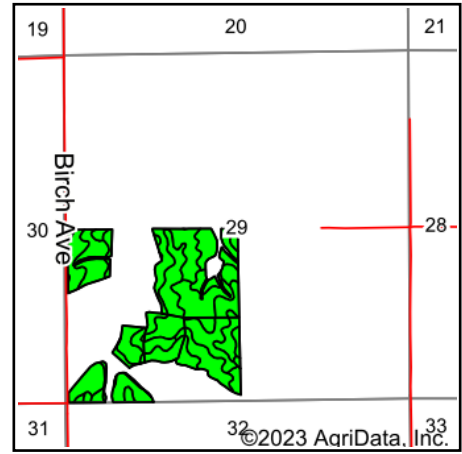

State: **Iowa**
 County: **Washington**
 Location: **29-77N-9W**
 Township: **Lime Creek**
 Acres: **93.13**
 Date: **11/28/2023**

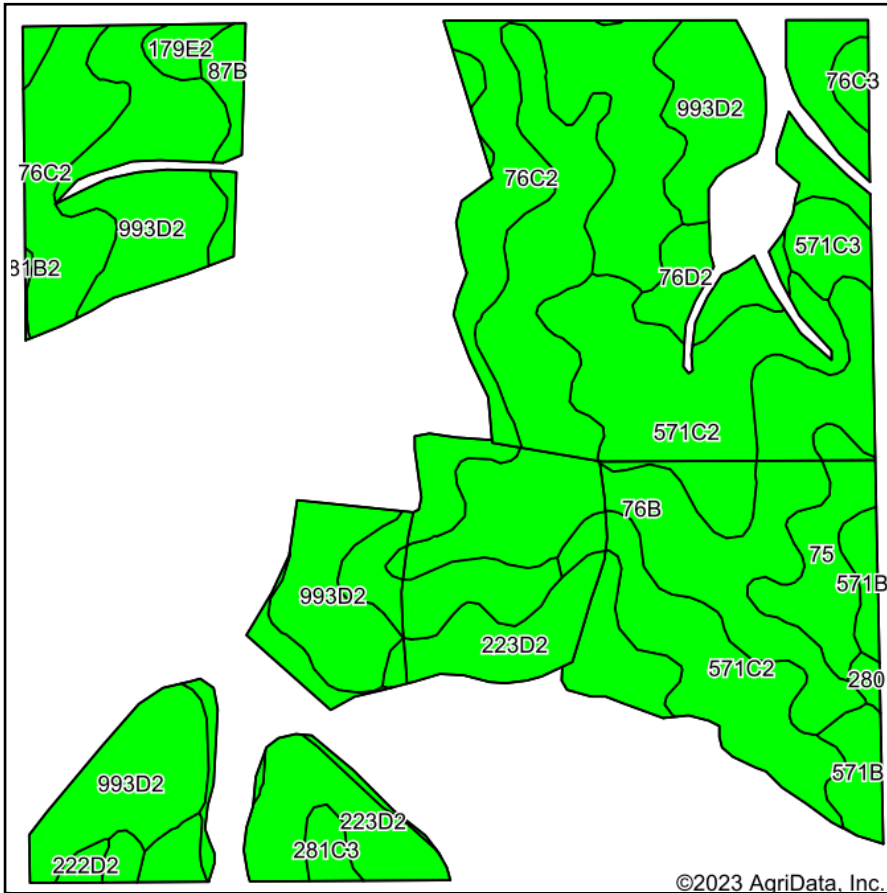

HIGH POINT
 LAND COMPANY

Maps Provided By:



© AgriData, Inc. 2023 www.AgriDataInc.com



Soils data provided by USDA and NRCS.

Area Symbol: IA183, Soil Area Version: 30

Code	Soil Description	Acres	Percent of field	CSR2 Legend	Non-Irr Class *c	CSR2**	CSR	*n NCCPI Overall	*n NCCPI Corn	*n NCCPI Small Grains	*n NCCPI Soybeans
993D2	Gara-Armstrong complex, 9 to 14 percent slopes, moderately eroded	20.00	21.5%		IVe	33	20	72	72	56	52
76B	Ladoga silt loam, 2 to 5 percent slopes	18.45	19.8%		IIe	86	85	91	91	74	77
76C2	Ladoga silt loam, 5 to 9 percent slopes, eroded	17.44	18.7%		IIIe	75	65	85	85	66	67
571C2	Hedrick silt loam, 5 to 9 percent slopes, moderately eroded	13.92	14.9%		IIIe	75	62	87	87	69	75
223D2	Rinda silty clay loam, 9 to 14 percent slopes, moderately eroded	9.06	9.7%		IVe	11	9	63	63	55	50
75	Givin silt loam, 0 to 2 percent slopes	3.09	3.3%		Iw	84	85	91	91	80	83
87B	Colo-Zook silty clay loams, 0 to 3 percent slopes	2.55	2.7%		IIw	68	60	71	69	38	70
76D2	Ladoga silt loam, 9 to 14 percent slopes, eroded	2.02	2.2%		IIIe	49	55	81	81	64	62
571C3	Hedrick silty clay loam, 5 to 9 percent slopes, severely eroded	1.46	1.6%		IVe	68	57	81	81	62	60
571B	Hedrick silt loam, 2 to 5 percent slopes	1.35	1.4%		IIe	85	82	94	94	79	87
281C3	Otley silty clay loam, 5 to 9 percent slopes, severely eroded	1.04	1.1%		IVe	74	65	72	72	60	58
571B2	Hedrick silt loam, 2 to 5 percent slopes, moderately eroded	0.83	0.9%		IIe	82	77	89	89	71	78
179E2	Gara loam, 14 to 18 percent slopes, moderately eroded	0.68	0.7%		VIe	34	33	72	72	52	51
76C3	Ladoga silty clay loam, 5 to 9 percent slopes, severely eroded	0.58	0.6%		IIIe	69	60	77	77	60	54
222D2	Clarinda silty clay loam, 9 to 14 percent slopes, moderately eroded	0.32	0.3%		IVe	15	10	65	65	54	50



280	Mahaska silty clay loam, 0 to 2 percent slopes	0.27	0.3%		lw	94	95	87	87	80	78	
281B2	Otley silty clay loam, 2 to 5 percent slopes, eroded	0.07	0.1%		lile	88	85	82	82	69	66	
Weighted Average						3.04	61.1	53.6	*n 81	*n 81	*n 64.4	*n 65.8

**IA has updated the CSR values for each county to CSR2.
 *n: The aggregation method is "Weighted Average using all components"
 *c: Using Capabilities Class Dominant Condition Aggregation Method
 Soils data provided by USDA and NRCS.