

Soils Map

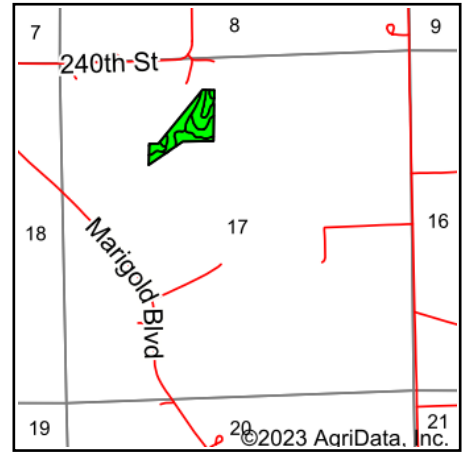

State: **Iowa**
 County: **Jefferson**
 Location: **17-71N-9W**
 Township: **Cedar**
 Acres: **11.21**
 Date: **8/19/2023**

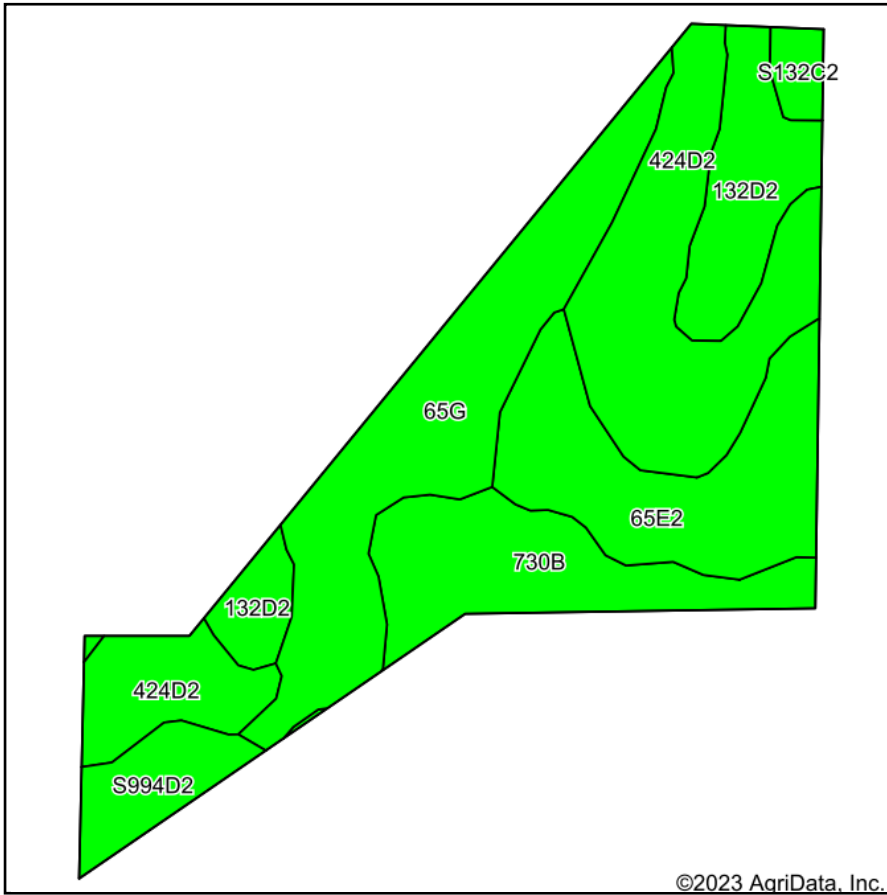

Maps Provided By:



Soils data provided by USDA and NRCS.

©2023 AgriData, Inc.

© AgriData, Inc. 2023

www.AgriDataInc.com

Area Symbol: IA101, Soil Area Version: 30

Code	Soil Description	Acres	Percent of field	CSR2 Legend	Non-Irr Class *c	CSR2**	CSR	*n NCCPI Overall	*n NCCPI Corn	*n NCCPI Small Grains	*n NCCPI Soybeans	
424D2	Lindley-Keswick complex, 9 to 14 percent slopes, moderately erod	3.00	26.8%		IVe	21	15	66	65	55	47	
65G	Lindley loam, 25 to 40 percent slopes	2.63	23.5%		VIIe	7	5	19	19	16	10	
65E2	Lindley loam, 14 to 18 percent slopes, moderately eroded	1.96	17.5%		VIe	29	28	66	66	56	53	
730B	Nodaway-Coppock-Cantril complex, 2 to 5 percent slopes	1.52	13.6%		IIw	74	61	76	76	63	71	
132D2	Weller silty clay loam, 9 to 14 percent slopes, moderately eroded	1.33	11.9%		IVe	34	28	78	78	67	63	
S994D2	Galland-Douds loams, heavy loess, 9 to 14 percent slopes, moderately eroded	0.58	5.2%		IVe	24		71	71	56	52	
S132C2	Weller silty clay loam, 5 to 9 percent slopes, moderately eroded	0.19	1.7%		IIIe	59		81	81	70	67	
Weighted Average						4.77	28.6	*-	*n 58.3	*n 58	*n 48.8	*n 45.1

**IA has updated the CSR values for each county to CSR2.

*- CSR weighted average cannot be calculated on the current soils data, use prior data version for csr values.

*n: The aggregation method is "Weighted Average using all components"

*c: Using Capabilities Class Dominant Condition Aggregation Method

Soils data provided by USDA and NRCS.