

Soils Map

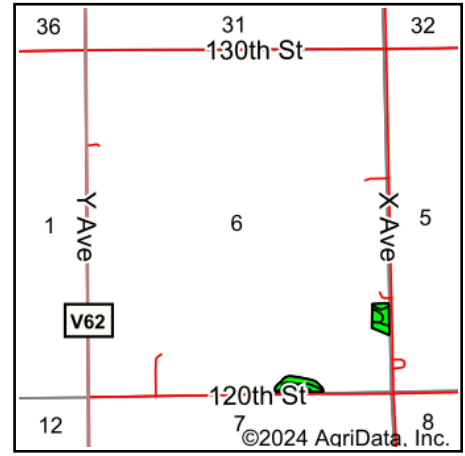

State: **Iowa**
 County: **Fayette**
 Location: **6-92N-10W**
 Township: **Fremont**
 Acres: **7.06**
 Date: **4/30/2024**

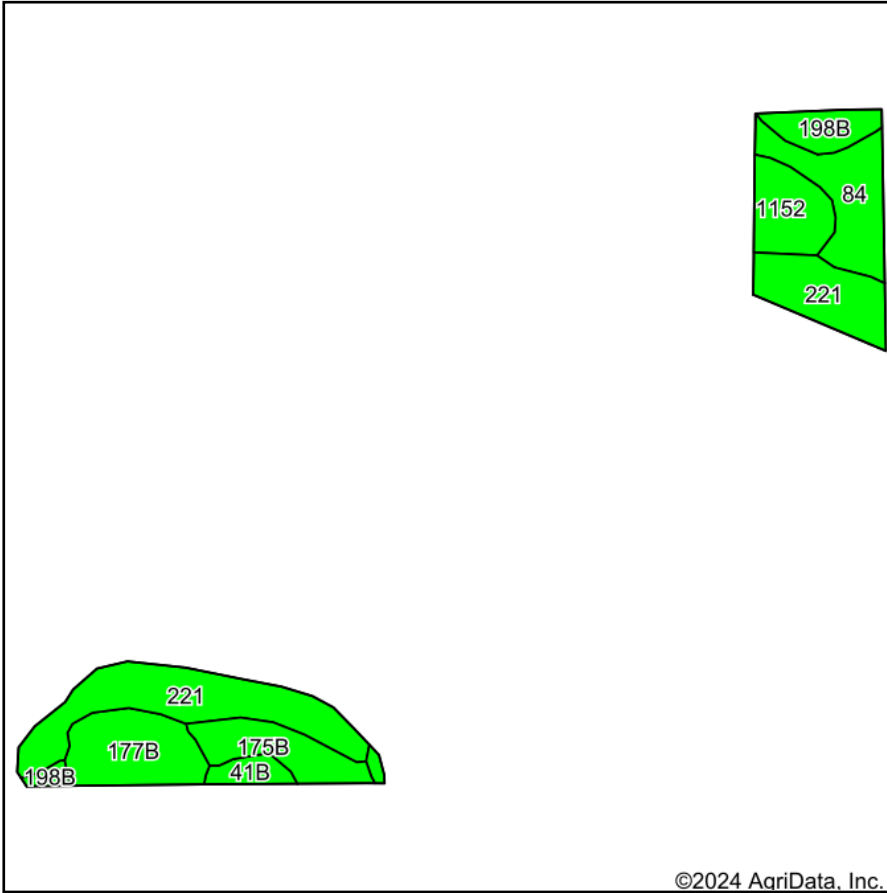

Maps Provided By:



Soils data provided by USDA and NRCS.

©2024 AgriData, Inc.

© AgriData, Inc. 2023

www.AgriDataInc.com

Area Symbol: IA065, Soil Area Version: 28

Code	Soil Description	Acres	Percent of field	CSR2 Legend	Non-Irr Class *c	Irr Class *c	CSR2**	CSR	*n NCCPI Overall	*n NCCPI Corn	*n NCCPI Small Grains	*n NCCPI Soybeans
221	Klossner muck, 1 to 4 percent slopes	2.64	37.4%		Illw		48	50	88	88	80	87
84	Clyde clay loam, 0 to 3 percent slopes	1.07	15.2%		llw		88	75	90	90	77	85
177B	Saude loam, 2 to 5 percent slopes	1.06	15.0%		lls		55	59	77	77	67	60
1152	Marshan clay loam, 0 to 2 percent slopes, rarely flooded	0.78	11.0%		llw		54	67	81	81	65	60
175B	Dickinson fine sandy loam, 2 to 5 percent slopes	0.74	10.5%		llle		50	55	61	61	53	36
198B	Floyd loam, 1 to 4 percent slopes	0.53	7.5%		llw		89	80	88	83	66	88
41B	Sparta loamy sand, 2 to 5 percent slopes	0.24	3.4%		IVs	lle	42	40	61	61	50	36
Weighted Average							2.55	59.5	*n 82.1	*n 81.8	*n 71	*n 72.7

**IA has updated the CSR values for each county to CSR2.

*n: The aggregation method is "Weighted Average using all components"

*c: Using Capabilities Class Dominant Condition Aggregation Method

*- Irr Class weighted average cannot be calculated on the current soils data due to missing data.

Soils data provided by USDA and NRCS.