

Soils Map

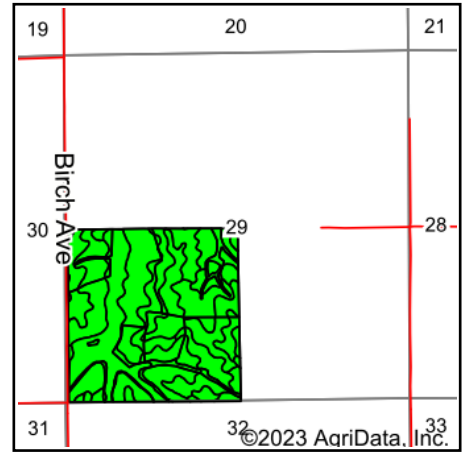

State: **Iowa**
 County: **Washington**
 Location: **29-77N-9W**
 Township: **Lime Creek**
 Acres: **162.68**
 Date: **11/28/2023**

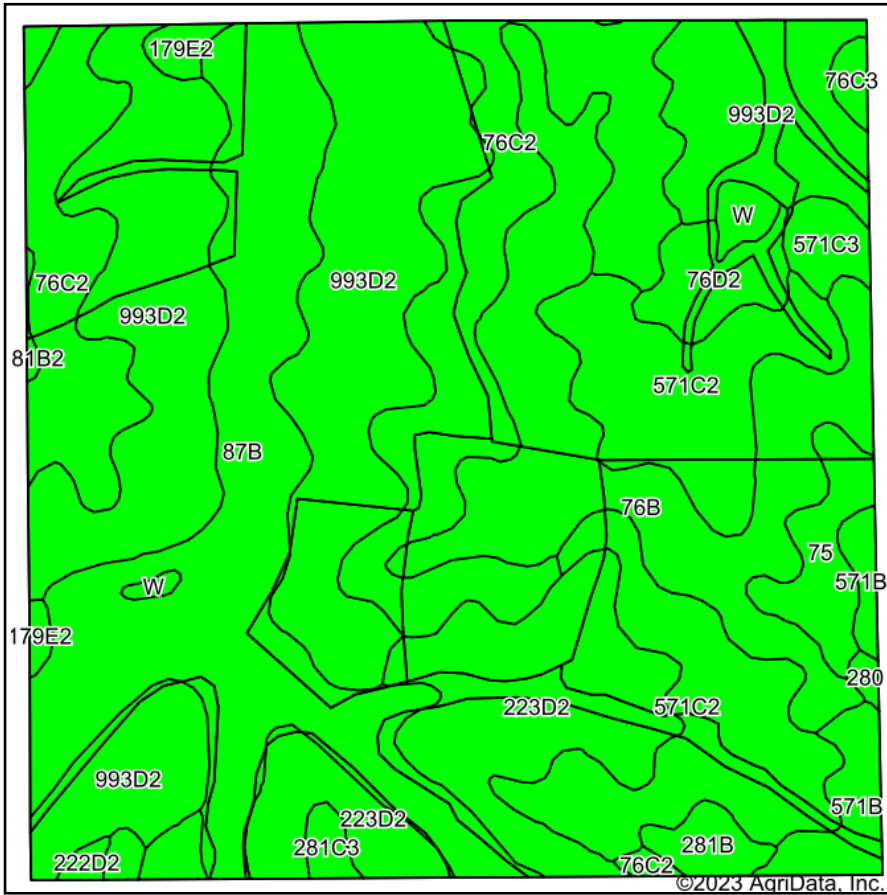

HIGH POINT
 LAND COMPANY

Maps Provided By:



© AgriData, Inc. 2023

www.AgriDataInc.com



Soils data provided by USDA and NRCS.

Area Symbol: IA183, Soil Area Version: 30

Code	Soil Description	Acres	Percent of field	CSR2 Legend	Non-Irr Class *c	CSR2**	CSR	*n NCCPI Overall	*n NCCPI Corn	*n NCCPI Small Grains	*n NCCPI Soybeans
993D2	Gara-Armstrong complex, 9 to 14 percent slopes, moderately eroded	43.57	26.8%		IVe	33	20	72	72	56	52
87B	Colo-Zook silty clay loams, 0 to 3 percent slopes	25.36	15.6%		IIw	68	60	71	69	38	70
76C2	Ladoga silt loam, 5 to 9 percent slopes, eroded	24.43	15.0%		IIIe	75	65	85	85	66	67
571C2	Hedrick silt loam, 5 to 9 percent slopes, moderately eroded	18.95	11.6%		IIIe	75	62	87	87	69	75
76B	Ladoga silt loam, 2 to 5 percent slopes	18.45	11.3%		Ile	86	85	91	91	74	77
223D2	Rinda silty clay loam, 9 to 14 percent slopes, moderately eroded	15.66	9.6%		IVe	11	9	63	63	55	50
75	Givin silt loam, 0 to 2 percent slopes	3.09	1.9%		Iw	84	85	91	91	80	83
76D2	Ladoga silt loam, 9 to 14 percent slopes, eroded	2.71	1.7%		IIIe	49	55	81	81	64	62
571B	Hedrick silt loam, 2 to 5 percent slopes	2.41	1.5%		Ile	85	82	94	94	79	87
571C3	Hedrick silty clay loam, 5 to 9 percent slopes, severely eroded	1.47	0.9%		IVe	68	57	81	81	62	60
281B	Otley silty clay loam, 2 to 5 percent slopes	1.38	0.8%		Ile	91	90	89	89	78	77
281C3	Otley silty clay loam, 5 to 9 percent slopes, severely eroded	1.04	0.6%		IVe	74	65	72	72	60	58
179E2	Gara loam, 14 to 18 percent slopes, moderately eroded	1.00	0.6%		VIe	34	33	72	72	52	51
W	Water	0.99	0.6%			0	0				
571B2	Hedrick silt loam, 2 to 5 percent slopes, moderately eroded	0.83	0.5%		Ile	82	77	89	89	71	78
76C3	Ladoga silty clay loam, 5 to 9 percent slopes, severely eroded	0.58	0.4%		IIIe	69	60	77	77	60	54



222D2	Clarinda silty clay loam, 9 to 14 percent slopes, moderately eroded	0.32	0.2%		IVe	15	10	65	65	54	50
280	Mahaska silty clay loam, 0 to 2 percent slopes	0.27	0.2%		Iw	94	95	87	87	80	78
281B2	Otley silty clay loam, 2 to 5 percent slopes, eroded	0.17	0.1%		Ille	88	85	82	82	69	66
Weighted Average					*-	56.9	48.7	*n 77.6	*n 77.3	*n 59.1	*n 63.8

**IA has updated the CSR values for each county to CSR2.

*n: The aggregation method is "Weighted Average using all components"

*c: Using Capabilities Class Dominant Condition Aggregation Method

*- Non Irr Class weighted average cannot be calculated on the current soils data due to missing data.

Soils data provided by USDA and NRCS.