

Soils Map

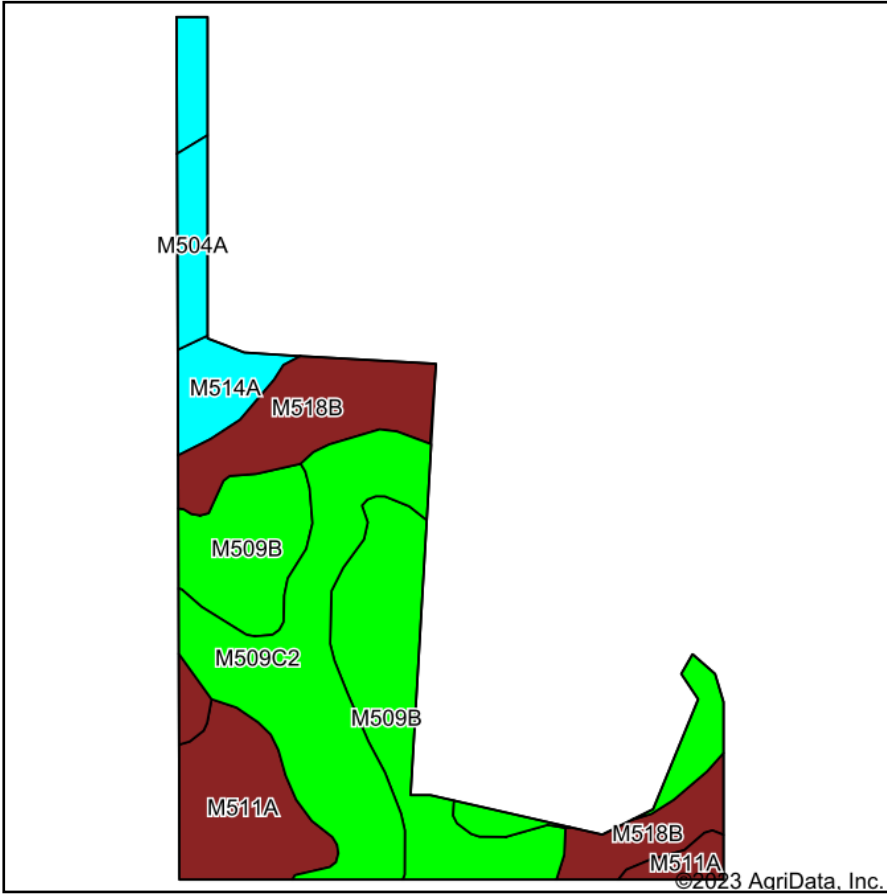

Soils data provided by USDA and NRCS.

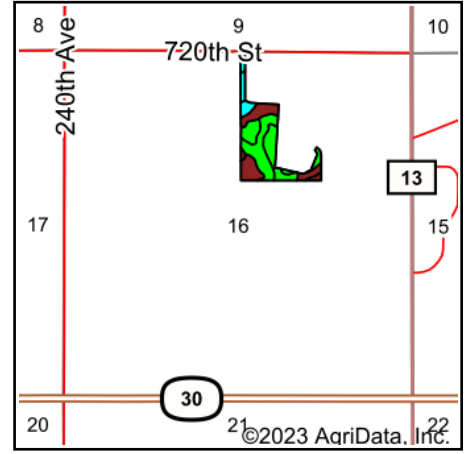

State: **Minnesota**
 County: **Dodge**
 Location: **16-105N-16W**
 Township: **Vernon**
 Acres: **19.02**
 Date: **10/9/2023**



Maps Provided By:



Area Symbol: MN039, Soil Area Version: 19

Code	Soil Description	Acres	Percent of field	PI Legend	Non-Irr Class *c	Productivity Index	*n NCCPI Overall	*n NCCPI Corn	*n NCCPI Small Grains	*n NCCPI Soybeans
M509C2	Mantorville loam, 6 to 12 percent slopes, moderately eroded	5.69	29.9%		Ille	71	60	60	48	38
M509B	Mantorville loam, 2 to 6 percent slopes	5.24	27.5%		Ile	75	65	65	53	45
M518B	Clyde-Floyd complex, 1 to 4 percent slopes	3.47	18.2%		Ilw	92	87	83	68	87
M511A	Readlyn silt loam, 1 to 3 percent slopes	2.58	13.6%		lw	100	79	79	54	65
M514A	Lawler-Marshan complex, 0 to 2 percent slopes	1.35	7.1%		Ils	69	75	75	59	51
M504A	Marshan clay loam, 0 to 2 percent slopes, rarely flooded	0.69	3.6%		Ilw	62	81	81	65	60
Weighted Average					2.16	79.4	*n 70.7	*n 70	*n 55.2	*n 54.3

*n: The aggregation method is "Weighted Average using all components"

*c: Using Capabilities Class Dominant Condition Aggregation Method

Soils data provided by USDA and NRCS.