

# Soils Map

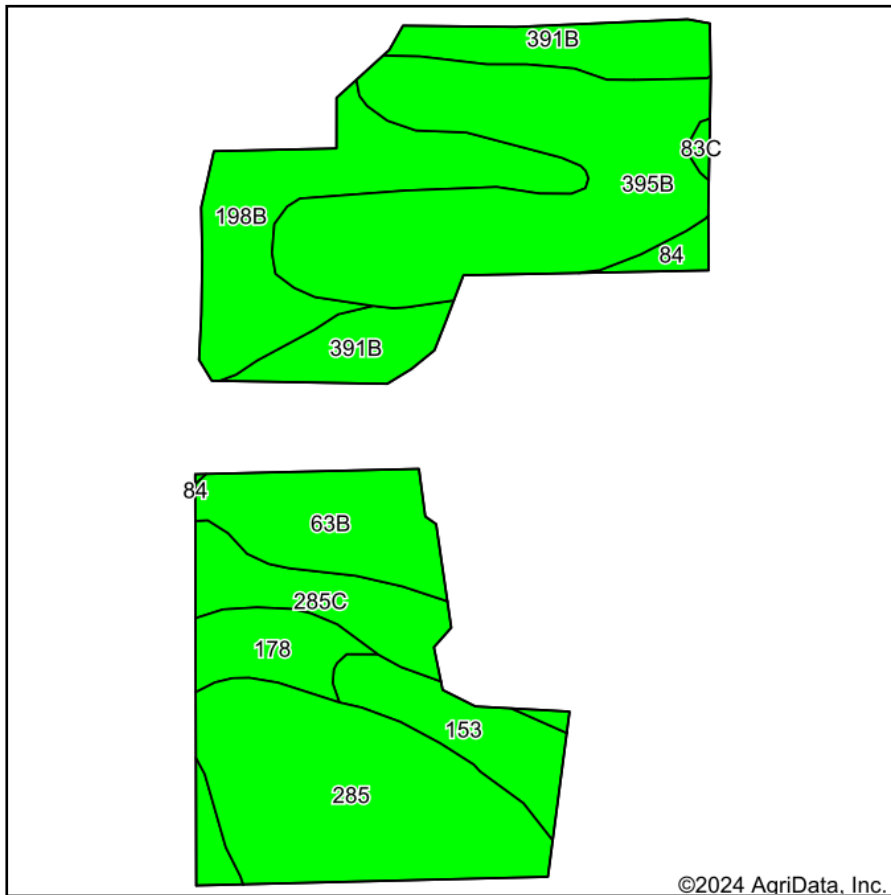

Soils data provided by USDA and NRCS.

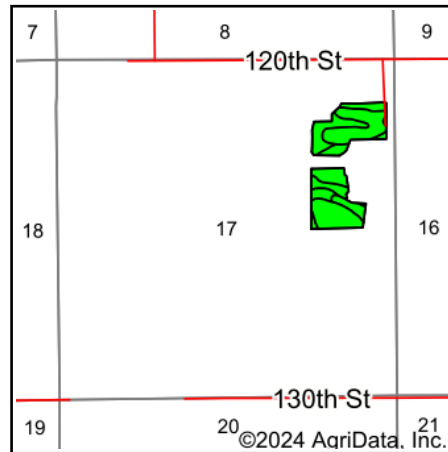

State: **Iowa**  
 County: **Bremer**  
 Location: **17-93N-14W**  
 Township: **Polk**  
 Acres: **30.62**  
 Date: **2/12/2024**



Maps Provided By:



© AgriData, Inc. 2023

www.AgriDataInc.com



Area Symbol: IA017, Soil Area Version: 28

Code	Soil Description	Acres	Percent of field	CSR2 Legend	Non-Irr Class *c	Irr Class *c	CSR2**	*n NCCPI Overall	*n NCCPI Corn	*n NCCPI Small Grains	*n NCCPI Soybeans	*n NCCPI Cotton
395B	Marquis loam, 2 to 5 percent slopes	8.11	26.5%		Ile		91	90	90	74	80	
285	Burkhardt sandy loam, 0 to 2 percent slopes, rarely flooded	6.30	20.6%		IIIs	Ile	23	43	41	43	19	9
198B	Floyd loam, 1 to 4 percent slopes	4.41	14.4%		IIW		89	88	83	66	88	
391B	Clyde-Floyd complex, 1 to 4 percent slopes	3.05	10.0%		IIW		87	89	87	72	86	
63B	Chelsea loamy fine sand, 2 to 5 percent slopes	2.73	8.9%		IVs		19	51	51	42	29	
285C	Burkhardt sandy loam, 2 to 9 percent slopes, rarely flooded	2.01	6.6%		IIle	Ile	13	43	40	43	19	9
153	Shandep loam, ponded, 0 to 1 percent slopes, occasionally flooded	1.86	6.1%		VIIIW		28	45	45	35	33	
178	Waukee loam, 0 to 2 percent slopes, rarely flooded	1.70	5.6%		IIs		69	84	84	70	71	9
84	Clyde silty clay loam, 0 to 3 percent slopes	0.34	1.1%		IIW		88	90	90	76	85	
83C	Kenyon loam, 5 to 9 percent slopes	0.11	0.4%		IIle		85	88	88	70	75	
<b>Weighted Average</b>					<b>2.82</b>	<b>*-</b>	<b>59.7</b>	<b>*n 70.3</b>	<b>*n 68.8</b>	<b>*n 58.8</b>	<b>*n 57.3</b>	<b>*n 2.9</b>

Soils data provided by USDA and NRCS.

Maps Provided By:



© AgriData, Inc. 2023

www.AgriDataInc.com

\*\*IA has updated the CSR values for each county to CSR2.

\*n: The aggregation method is "Weighted Average using all components"

\*\*IA has updated the CSR values for each county to CSR2.\*c: Using Capabilities Class Dominant Condition Aggregation Method

\*\*IA has updated the CSR values for each county to CSR2.\*c: Using Capabilities Class Dominant Condition Aggregation Method\*- Irr Class weighted average cannot be calculated on the current soils data due to missing data.