

Soils Map

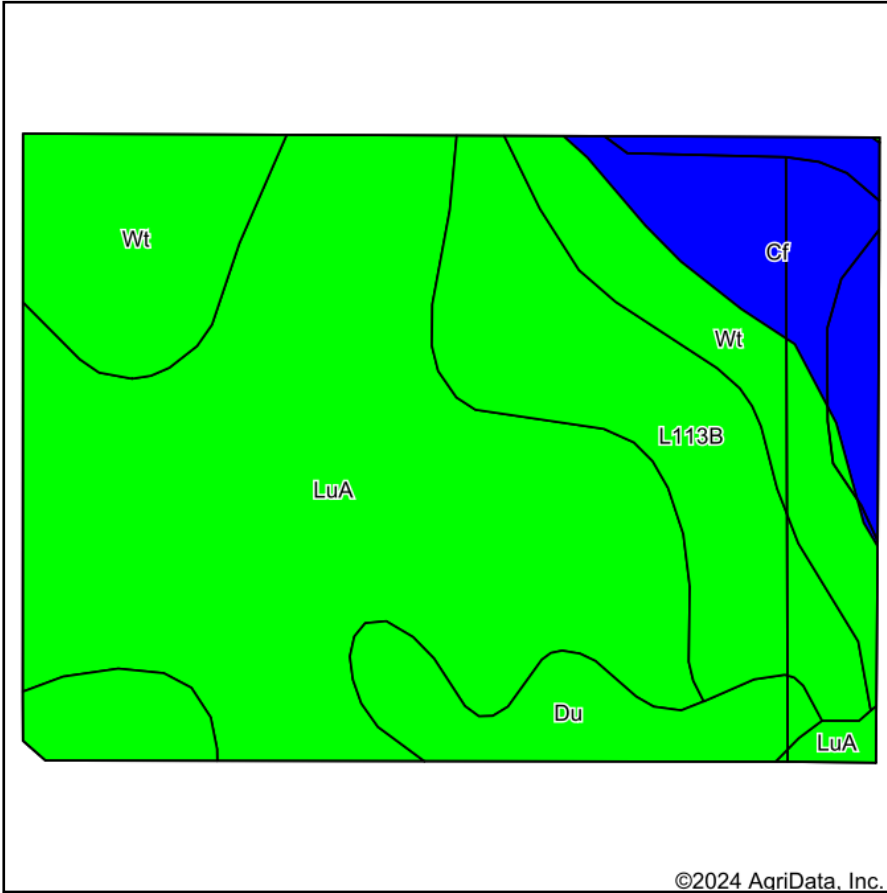

Soils data provided by USDA and NRCS.

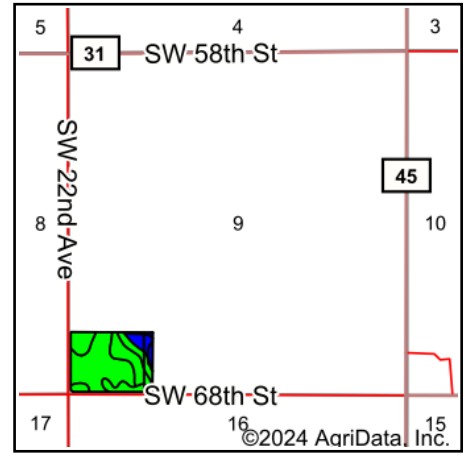

State: **Minnesota**
 County: **Steele**
 Location: **9-106N-20W**
 Township: **Somerset**
 Acres: **26.83**
 Date: **2/23/2024**



Maps Provided By:



© AgriData, Inc. 2023

www.AgriDataInc.com



Area Symbol: MN147, Soil Area Version: 19

Code	Soil Description	Acres	Percent of field	PI Legend	Non-Irr Class *c	Productivity Index	*n NCCPI Overall	*n NCCPI Corn	*n NCCPI Small Grains	*n NCCPI Soybeans
LuA	Le Sueur loam, 1 to 3 percent slopes	12.83	47.8%		lw	97	90	90	76	84
Wt	Webster clay loam, 0 to 2 percent slopes	5.30	19.8%		llw	93	83	78	70	82
L113B	Reedslake-Le Sueur complex, 1 to 6 percent slopes	4.28	16.0%		lle	98	81	78	73	81
Cf	Canisteo clay loam, depressional, 0 to 1 percent slopes	2.60	9.7%		lllw	86	75	67	61	75
Du	Dundas silt loam, 0 to 2 percent slopes	1.82	6.8%		llw	91	86	84	76	85
Weighted Average					1.62	94.9	*n 85.5	*n 83.1	*n 72.9	*n 82.3

*n: The aggregation method is "Weighted Average using all components"

*c: Using Capabilities Class Dominant Condition Aggregation Method

Soils data provided by USDA and NRCS.