

Soils Map

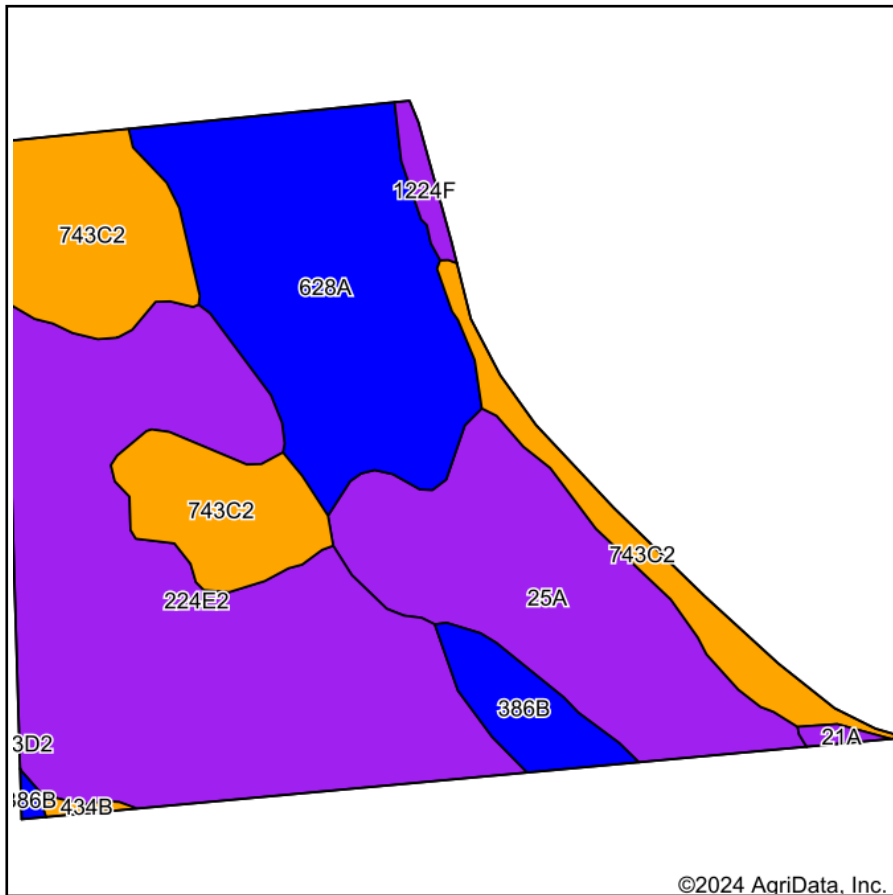

Soils data provided by USDA and NRCS.

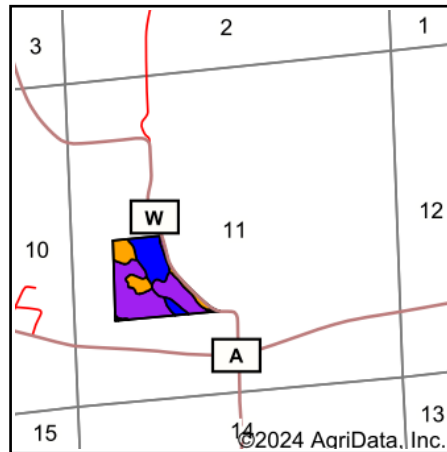

State: **Wisconsin**
 County: **Monroe**
 Location: **11-16N-1E**
 Township: **Clifton**
 Acres: **32.5**
 Date: **2/13/2024**



Maps Provided By:



© AgriData, Inc. 2023

www.AgriDataInc.com



Area Symbol: WI081, Soil Area Version: 19

Code	Soil Description	Acres	Percent of field	Non-Irr Class Legend	Non-Irr Class *c	*n NCCPI Overall	*n NCCPI Corn	*n NCCPI Small Grains	*n NCCPI Soybeans
224E2	Elevasil sandy loam, 20 to 30 percent slopes, moderately eroded	12.00	36.9%		Vle	10	10	10	4
628A	Orion silt loam, 0 to 3 percent slopes, occasionally flooded	7.03	21.6%		IIw	89	79	55	89
743C2	Council fine sandy loam, 6 to 12 percent slopes, moderately eroded	6.04	18.6%		IIIe	74	74	64	63
25A	Dawsil mucky peat, 0 to 1 percent slopes	5.76	17.7%		VIIw	36	13	36	9
386B	Jackson silt loam, 1 to 6 percent slopes	1.16	3.6%		IIe	86	86	77	81
1224F	Boone-Elevasil complex, 15 to 45 percent slopes, rocky	0.31	1.0%		VIIIs	15	15	14	7
21A	Palms muck, 0 to 1 percent slopes, frequently flooded	0.11	0.3%		VIIw	4	2	3	1
434B	Bilson sandy loam, 1 to 6 percent slopes	0.09	0.3%		IIIs	66	66	57	53
Weighted Average					4.62	*n 46.5	*n 40.2	*n 36.9	*n 37.1

*n: The aggregation method is "Weighted Average using all components"

*c: Using Capabilities Class Dominant Condition Aggregation Method

Soils data provided by USDA and NRCS.