

# Soils Map

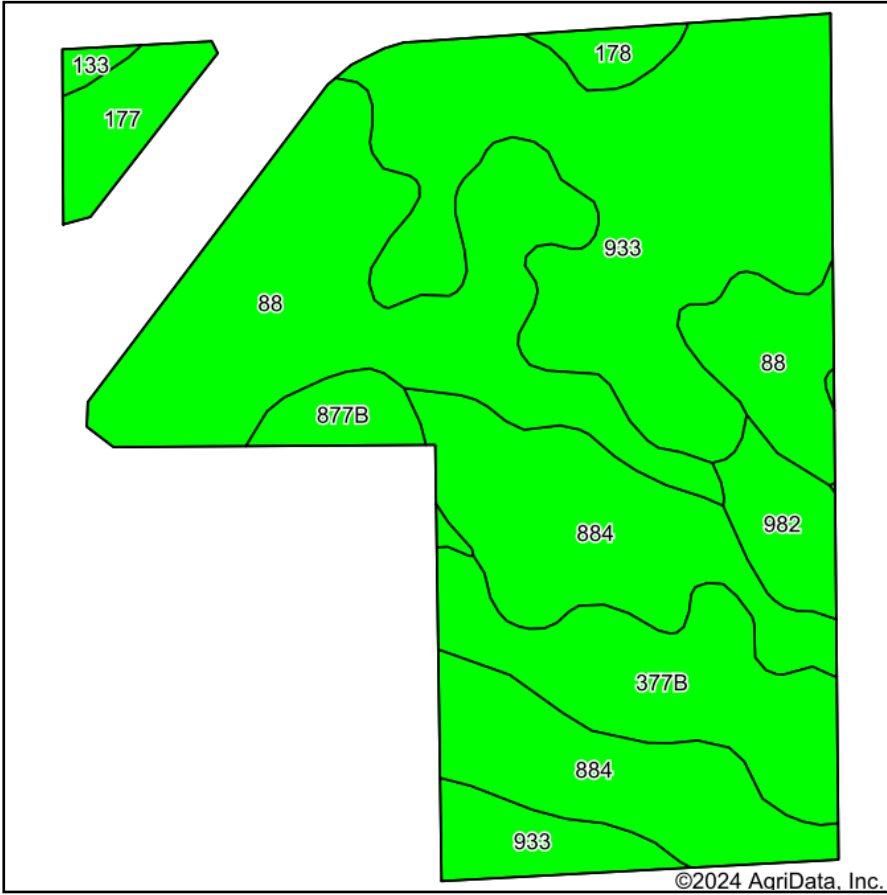

Soils data provided by USDA and NRCS.

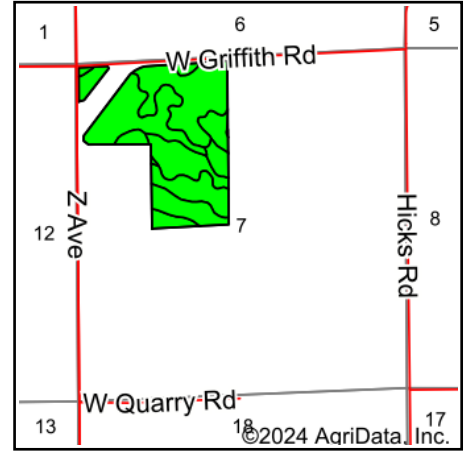

State: **Iowa**  
 County: **Black Hawk**  
 Location: **7-87N-14W**  
 Township: **Lincoln**  
 Acres: **92.06**  
 Date: **2/8/2024**



Maps Provided By:



Area Symbol: IA013, Soil Area Version: 31

Code	Soil Description	Acres	Percent of field	CSR2 Legend	Non-Irr Class *c	CSR2**	*n NCCPI Overall	*n NCCPI Corn	*n NCCPI Small Grains	*n NCCPI Soybeans	
933	Sawmill silty clay loam, shallow loess, 0 to 2 percent slopes, occasionally flooded	27.88	30.3%		Ilw	78	77	77	34	75	
88	Nevin silty clay loam, 0 to 2 percent slopes	25.08	27.2%		lw	95	96	95	75	89	
884	Klingmore silty clay loam, 1 to 3 percent slopes	19.27	20.9%		l	95	99	99	82	90	
377B	Dinsdale silty clay loam, 2 to 5 percent slopes	9.86	10.7%		lle	94	88	88	68	75	
982	Maxmore silty clay loam, 0 to 2 percent slopes	3.09	3.4%		Ilw	94	91	91	81	89	
177	Saude loam, 0 to 2 percent slopes	2.94	3.2%		lls	60	79	79	68	62	
877B	Dinsmore silty clay loam, 2 to 5 percent slopes	2.19	2.4%		lle	95	98	98	79	89	
178	Waukee loam, 0 to 2 percent slopes	1.31	1.4%		lls	69	84	84	73	71	
133	Colo silty clay loam, 0 to 2 percent slopes, occasionally flooded	0.44	0.5%		Ilw	78	77	77	34	75	
<b>Weighted Average</b>						<b>1.52</b>	<b>88.1</b>	<b>*n 89.1</b>	<b>*n 88.8</b>	<b>*n 63.1</b>	<b>*n 82.3</b>

\*\*IA has updated the CSR values for each county to CSR2.

\*n: The aggregation method is "Weighted Average using all components"

\*\*IA has updated the CSR values for each county to CSR2.\*c: Using Capabilities Class Dominant Condition Aggregation Method

Soils data provided by USDA and NRCS.