

Soils Map

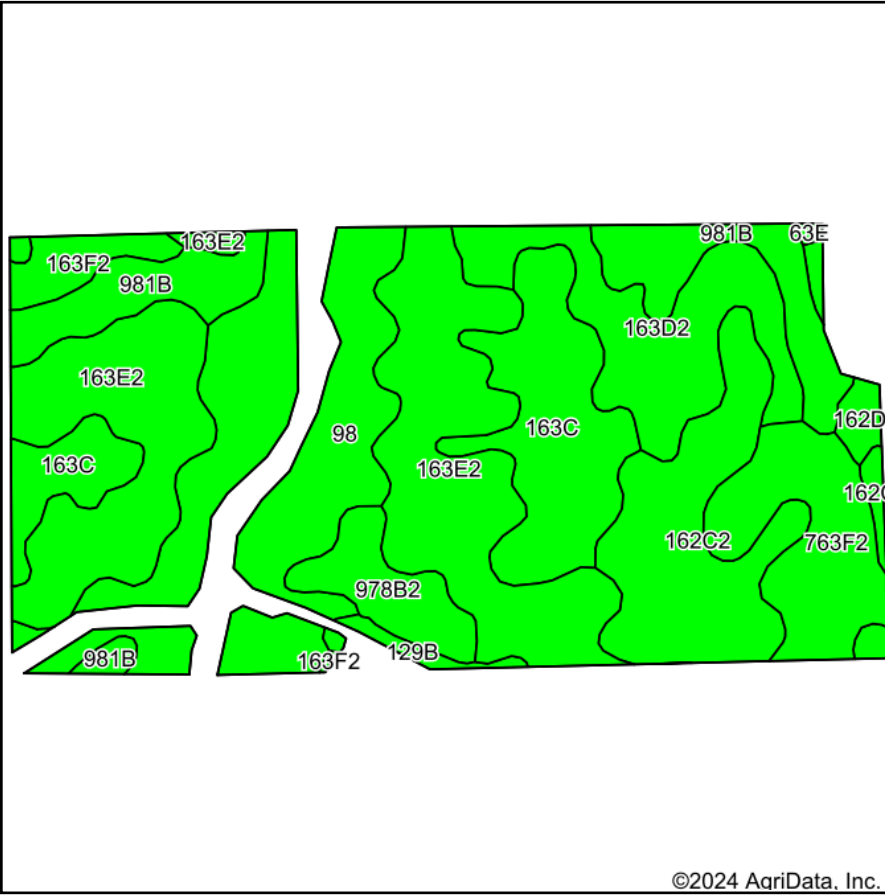

©2024 AgriData, Inc.

Soils data provided by USDA and NRCS.

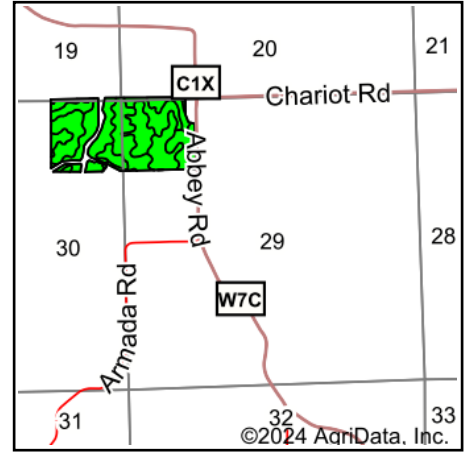

State: **Iowa**
 County: **Clayton**
 Location: **29-94N-6W**
 Township: **Marion**
 Acres: **72.21**
 Date: **2/1/2024**



Maps Provided By:



© AgriData, Inc. 2023

www.AgriDataInc.com



Area Symbol: IA043, Soil Area Version: 27

Code	Soil Description	Acres	Percent of field	CSR2 Legend	Non-Irr Class *c	CSR2**	*n NCCPI Overall	*n NCCPI Corn	*n NCCPI Small Grains	*n NCCPI Soybeans
163E2	Fayette silt loam, 14 to 18 percent slopes, moderately eroded	18.22	25.2%		IVe	35	74	74	62	58
98	Huntsville silt loam, 0 to 2 percent slopes	12.98	18.0%		lw	89	84	84	71	74
163C	Fayette silt loam, 5 to 9 percent slopes	8.87	12.3%		IIIe	75	86	86	75	74
162C2	Downs silt loam, 5 to 9 percent slopes, moderately eroded	8.20	11.4%		IIIe	80	85	85	72	72
981B	Worthen silt loam, 2 to 5 percent slopes	6.56	9.1%		Ile	94	89	89	77	83
163D2	Fayette silt loam, 9 to 14 percent slopes, moderately eroded	6.50	9.0%		IIIe	46	78	78	66	62
763F2	Exette silt loam, 18 to 25 percent slopes, moderately eroded	5.41	7.5%		VIe	28	55	55	41	46
978B2	Festina silt loam, 1 to 6 percent slopes, moderately eroded	2.58	3.6%		Ile	84	81	81	72	72
163F2	Fayette silt loam, 18 to 25 percent slopes, moderately eroded	1.45	2.0%		VIe	18	59	59	40	42
162D2	Downs silt loam, 9 to 14 percent slopes, moderately eroded	0.80	1.1%		IIIe	54	81	81	69	67

Soils data provided by USDA and NRCS.



Code	Soil Description	Acres	Percent of field	CSR2 Legend	Non-Irr Class *c	CSR2**	*n NCCPI Overall	*n NCCPI Corn	*n NCCPI Small Grains	*n NCCPI Soybeans	
129B	Arenzville-Chaseburg complex, 1 to 5 percent slopes	0.54	0.7%		Ilw	73	85	85	72	83	
63E	Chelsea loamy fine sand, 14 to 25 percent slopes	0.10	0.1%		Vlls	5	32	32	26	21	
Weighted Average						3.05	62.4	*n 78.9	*n 78.9	*n 66.5	*n 66.6

**IA has updated the CSR values for each county to CSR2.

*n: The aggregation method is "Weighted Average using all components"

**IA has updated the CSR values for each county to CSR2.*c: Using Capabilities Class Dominant Condition Aggregation Method