

Soils Map

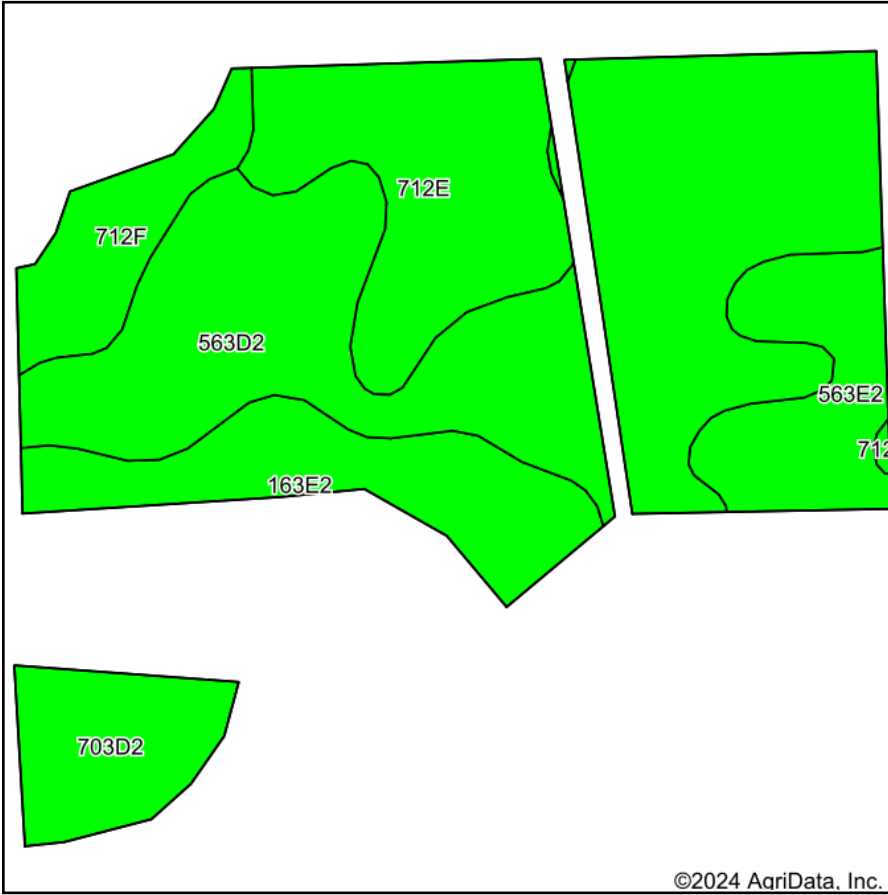

Soils data provided by USDA and NRCS.

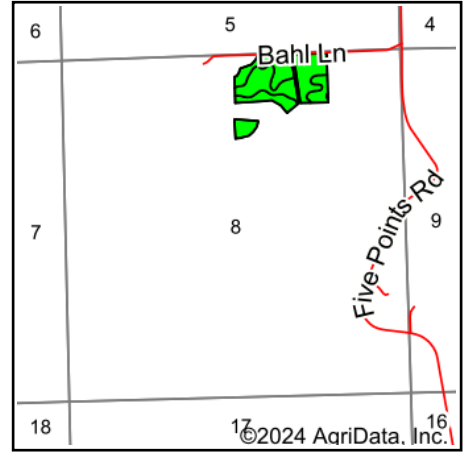

State: **Iowa**
 County: **Dubuque**
 Location: **8-89N-1E**
 Township: **Center**
 Acres: **25.23**
 Date: **1/30/2024**



Maps Provided By:



© AgriData, Inc. 2023

www.AgriDataInc.com



Area Symbol: IA061, Soil Area Version: 25

Code	Soil Description	Acres	Percent of field	CSR2 Legend	Non-Irr Class *c	CSR2**	*n NCCPI Overall	*n NCCPI Corn	*n NCCPI Small Grains	*n NCCPI Soybeans	
563D2	Rozetta-Eleroy silt loams, 9 to 14 percent slopes, moderately eroded	12.16	48.2%		IIIe	42	74	73	64	63	
712E	Schapville silt loam, 9 to 18 percent slopes	4.14	16.4%		IVe	22	57	51	57	38	
163E2	Fayette silt loam, 14 to 18 percent slopes, moderately eroded	2.99	11.9%		IVe	35	74	74	62	58	
563E2	Rozetta-Eleroy silt loams, 14 to 18 percent slopes, moderately eroded	2.31	9.2%		IIIe	30	71	71	61	60	
703D2	Dubuque silt loam, 9 to 14 percent slopes, moderately eroded	1.91	7.6%		IVe	13	52	51	51	44	
712F	Schapville silt loam, 18 to 30 percent slopes	1.72	6.8%		VIe	5	25	25	20	13	
Weighted Average						3.56	32.1	*n 65.9	*n 64.4	*n 58.4	*n 53.2

**IA has updated the CSR values for each county to CSR2.

*n: The aggregation method is "Weighted Average using all components"

**IA has updated the CSR values for each county to CSR2.*c: Using Capabilities Class Dominant Condition Aggregation Method