

Soils Map

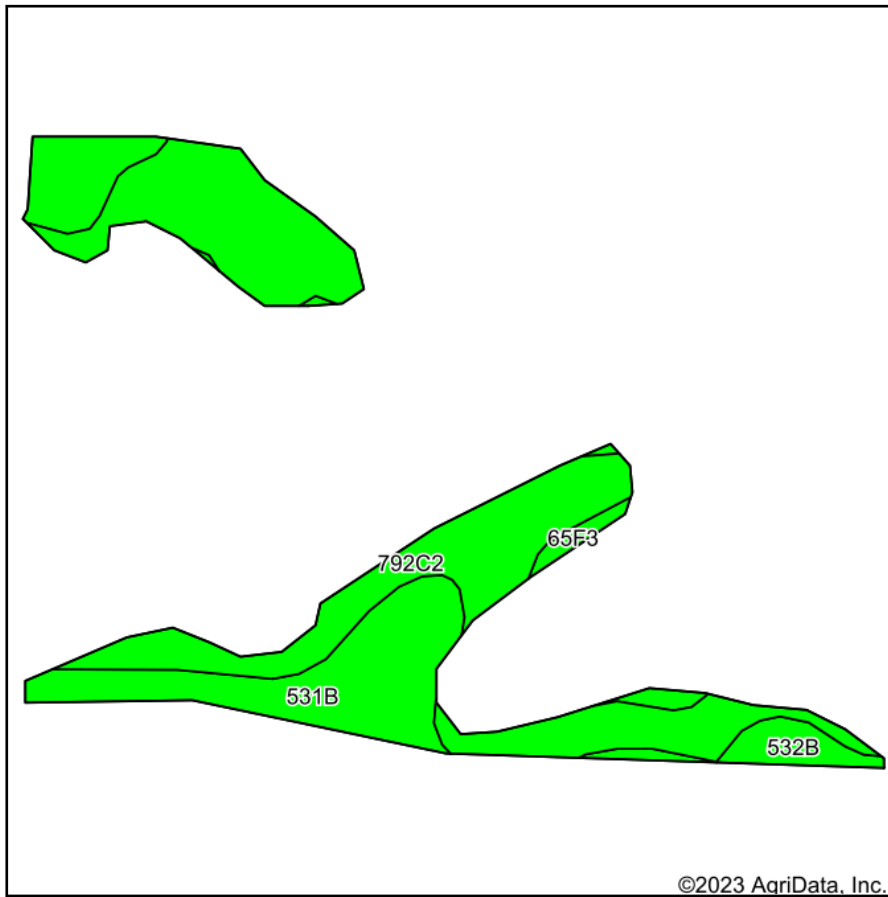

Soils data provided by USDA and NRCS.

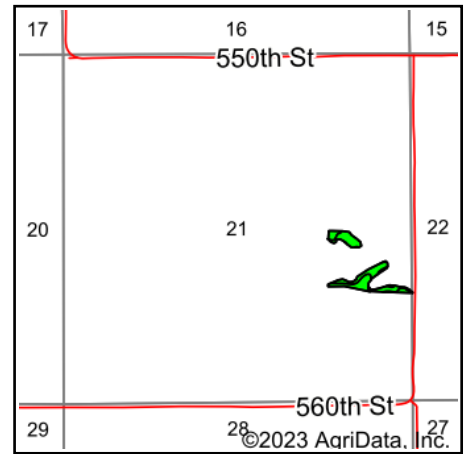

State: **Iowa**
 County: **Appanoose**
 Location: **21-68N-17W**
 Township: **Caldwell**
 Acres: **5.71**
 Date: **12/28/2023**



Maps Provided By:



© AgriData, Inc. 2023

www.AgriDataInc.com



Area Symbol: IA007, Soil Area Version: 30

| Code | Soil Description | Acres | Percent of field | CSR2 Legend | Non-Irr Class *c | CSR2** | *n NCCPI Overall | *n NCCPI Corn | *n NCCPI Small Grains | *n NCCPI Soybeans |
|------------------|--|-------|------------------|-------------|------------------|--------|------------------|---------------|-----------------------|-------------------|
| 792C2 | Armstrong loam, 5 to 9 percent slopes, moderately eroded | 3.39 | 59.4% | | IIIe | 31 | 65 | 65 | 58 | 47 |
| 531B | Kniffin silt loam, 2 to 5 percent slopes | 1.88 | 32.9% | | IIIe | 55 | 69 | 64 | 69 | 66 |
| 532B | Rathbun silt loam, 2 to 5 percent slopes | 0.26 | 4.6% | | IIIe | 55 | 79 | 79 | 72 | 62 |
| 65F3 | Lindley soils, 18 to 24 percent slopes, severely eroded | 0.18 | 3.2% | | VIIe | 7 | 56 | 56 | 36 | 35 |
| Weighted Average | | | | | 3.13 | 39.2 | *n 66.7 | *n 65 | *n 61.6 | *n 53.6 |

**IA has updated the CSR values for each county to CSR2.

*n: The aggregation method is "Weighted Average using all components"

*c: Using Capabilities Class Dominant Condition Aggregation Method

Soils data provided by USDA and NRCS.