

Soils Map

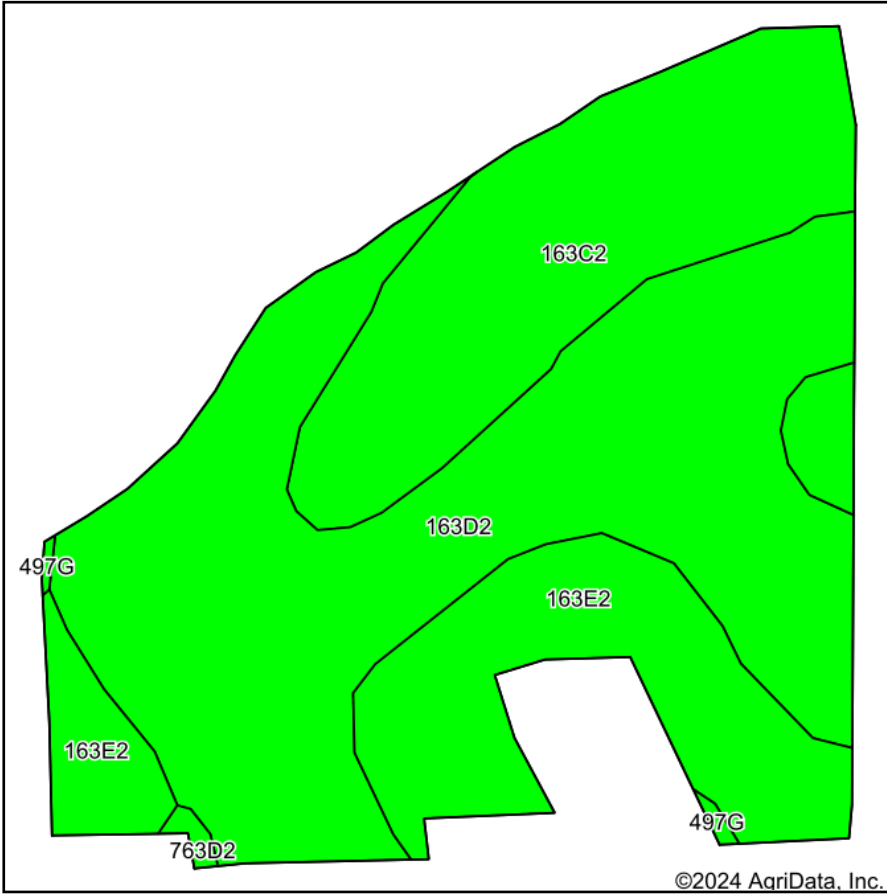

Soils data provided by USDA and NRCS.

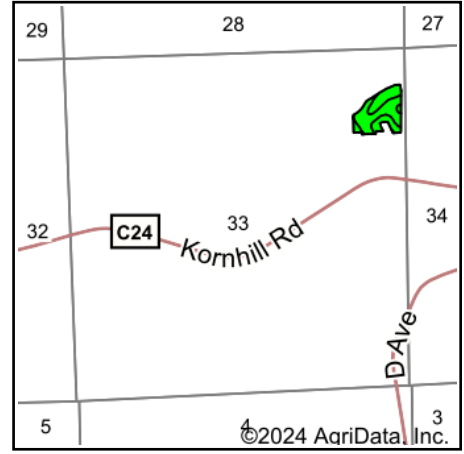

State: **Iowa**
 County: **Fayette**
 Location: **33-93N-7W**
 Township: **Illyria**
 Acres: **9.19**
 Date: **1/8/2024**



Maps Provided By:



Area Symbol: IA065, Soil Area Version: 28

Code	Soil Description	Acres	Percent of field	CSR2 Legend	Non-Irr Class *c	CSR2**	*n NCCPI Overall	*n NCCPI Corn	*n NCCPI Small Grains	*n NCCPI Soybeans
163D2	Fayette silt loam, 9 to 14 percent slopes, moderately eroded	4.83	52.6%		IIIe	46	78	78	66	62
163C2	Fayette silt loam, 5 to 9 percent slopes, moderately eroded	2.31	25.1%		IIIe	72	81	81	69	66
163E2	Fayette silt loam, 14 to 18 percent slopes, moderately eroded	2.05	22.3%		IVe	35	74	74	62	58
Weighted Average						3.22	*n 77.9	*n 77.9	*n 65.9	*n 62.1

**IA has updated the CSR values for each county to CSR2.

*n: The aggregation method is "Weighted Average using all components"

*c: Using Capabilities Class Dominant Condition Aggregation Method

Soils data provided by USDA and NRCS.