

# Soils Map

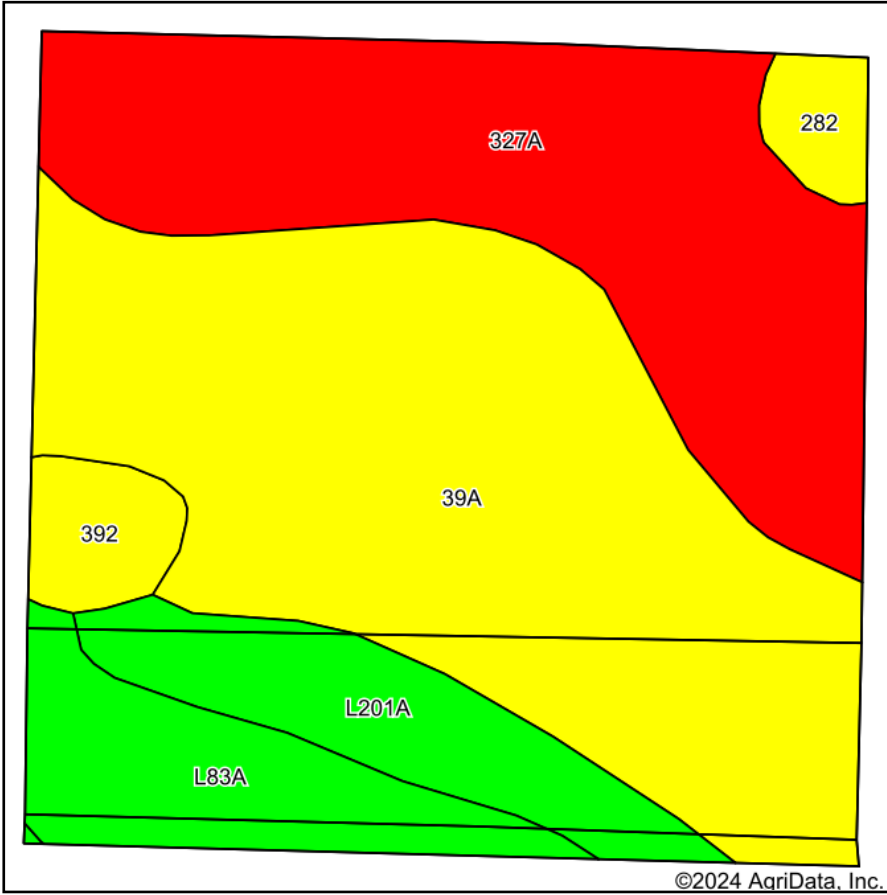

Soils data provided by USDA and NRCS.

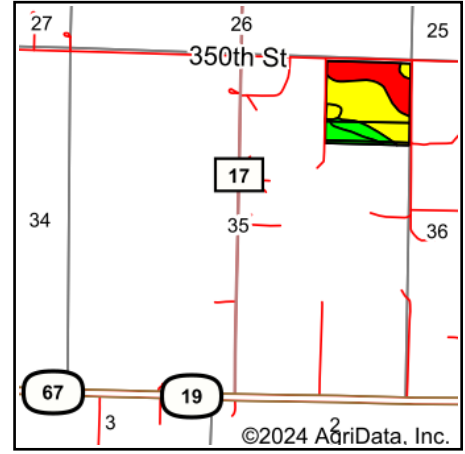

State: **Minnesota**  
 County: **Redwood**  
 Location: **35-113N-36W**  
 Township: **Delhi**  
 Acres: **38.43**  
 Date: **1/23/2024**



Maps Provided By:



Area Symbol: MN127, Soil Area Version: 22

Code	Soil Description	Acres	Percent of field	PI Legend	Non-Irr Class *c	Productivity Index	*n NCCPI Overall	*n NCCPI Corn	*n NCCPI Small Grains	*n NCCPI Soybeans
39A	Wadena loam, 0 to 2 percent slopes	17.76	46.2%	Yellow	Ils	66	61	61	59	52
327A	Dickman sandy loam, 0 to 2 percent slopes	11.74	30.5%	Red	IIIs	49	53	53	48	36
L83A	Webster clay loam, 0 to 2 percent slopes	3.55	9.2%	Green	IIw	93	83	78	70	82
L201A	Normania loam, 1 to 3 percent slopes	3.45	9.0%	Green	Ie	99	83	76	71	83
392	Biscay clay loam, 0 to 2 percent slopes	1.16	3.0%	Yellow	IIw	70	69	69	60	66
282	Hanska fine sandy loam	0.77	2.0%	Yellow	IIw	61	72	72	58	51
<b>Weighted Average</b>					<b>2.22</b>	<b>66.3</b>	<b>*n 63</b>	<b>*n 61.9</b>	<b>*n 57.7</b>	<b>*n 53.1</b>

\*n: The aggregation method is "Weighted Average using all components"

\*c: Using Capabilities Class Dominant Condition Aggregation Method

Soils data provided by USDA and NRCS.