

# Soils Map

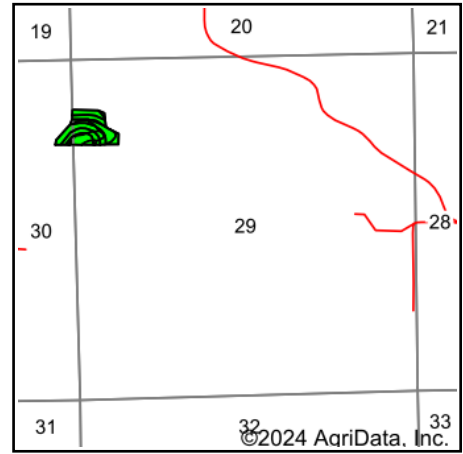

State: **Iowa**  
 County: **Allamakee**  
 Location: **30-98N-4W**  
 Township: **Center**  
 Acres: **8.59**  
 Date: **1/19/2024**

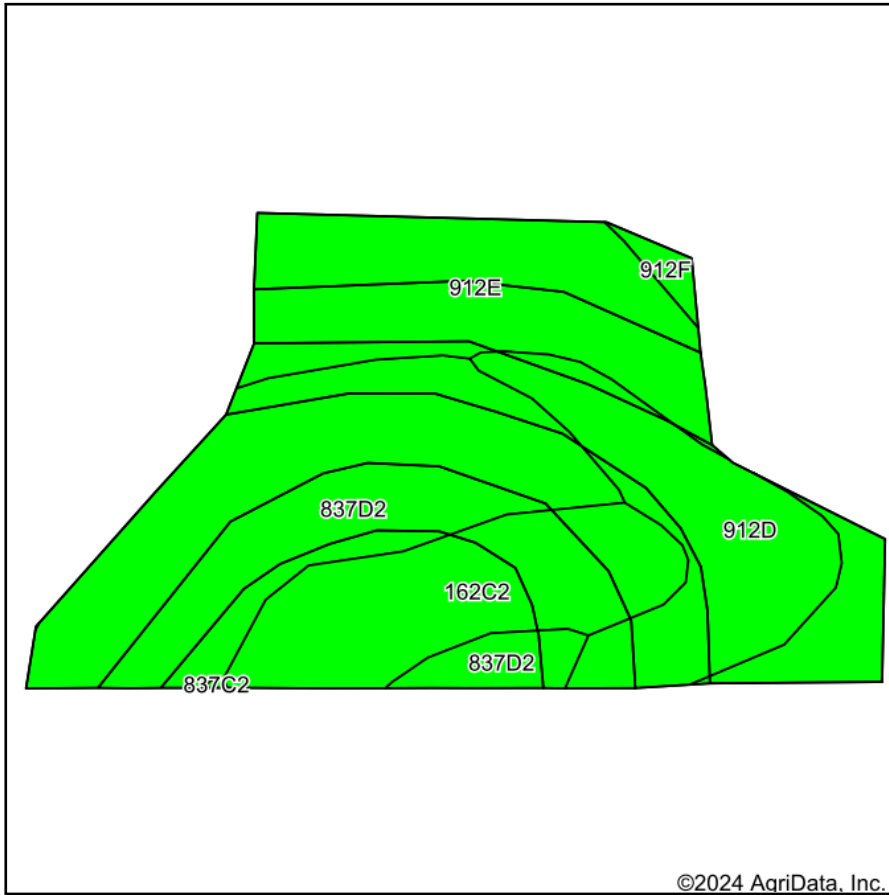

Maps Provided By:



Soils data provided by USDA and NRCS.

Area Symbol: IA005, Soil Area Version: 26

| Code                    | Soil Description   | Acres | Percent of field | CSR2 Legend | Non-Irr Class *c | CSR2**      | CSR         | *n NCCPI Overall | *n NCCPI Corn  | *n NCCPI Small Grains | *n NCCPI Soybeans |                |
|-------------------------|--|-------|------------------|-------------|------------------|-------------|-------------|------------------|----------------|-----------------------|-------------------|----------------|
| 837D2                   | Village silt loam, 9 to 14 percent slopes, moderately eroded | 3.14  | 36.6%            |             | IIIe             | 40          | 28          | 62               | 62             | 60                    | 47                |                |
| 912E                    | Paintcreek silt loam, 14 to 18 percent slopes                | 2.34  | 27.2%            |             | VIe              | 10          | 10          | 53               | 49             | 53                    | 45                |                |
| 162C2                   | Downs silt loam, 5 to 9 percent slopes, moderately eroded    | 1.52  | 17.7%            |             | IIIe             | 80          | 73          | 85               | 85             | 72                    | 72                |                |
| 912D                    | Paintcreek silt loam, 9 to 14 percent slopes                 | 1.50  | 17.5%            |             | IVe              | 23          | 13          | 57               | 51             | 56                    | 48                |                |
| 912F                    | Paintcreek silt loam, 18 to 30 percent slopes                | 0.09  | 1.0%             |             | VIe              | 5           | 5           | 26               | 26             | 22                    | 19                |                |
| <b>Weighted Average</b> |  |       |                  |             |                  | <b>4.02</b> | <b>35.6</b> | <b>28.2</b>      | <b>*n 62.4</b> | <b>*n 60.2</b>        | <b>*n 59.1</b>    | <b>*n 50.8</b> |

\*\*IA has updated the CSR values for each county to CSR2.

\*n: The aggregation method is "Weighted Average using all components"

\*\*IA has updated the CSR values for each county to CSR2.\*c: Using Capabilities Class Dominant Condition Aggregation Method