

Soils Map

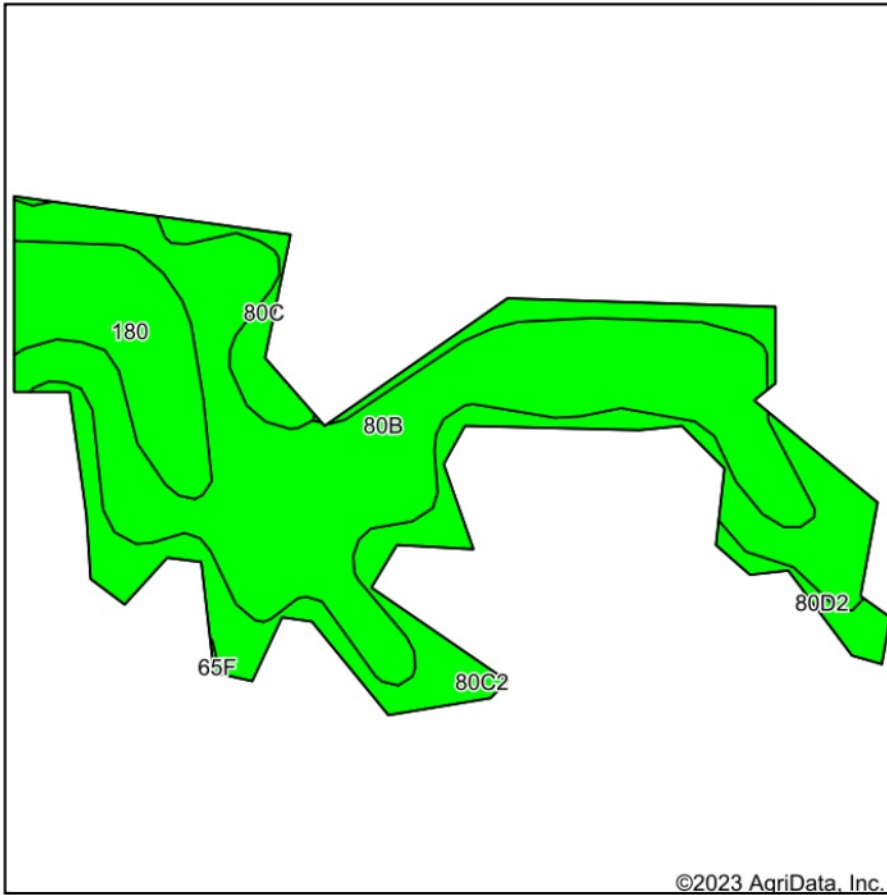

Soils data provided by USDA and NRCS.

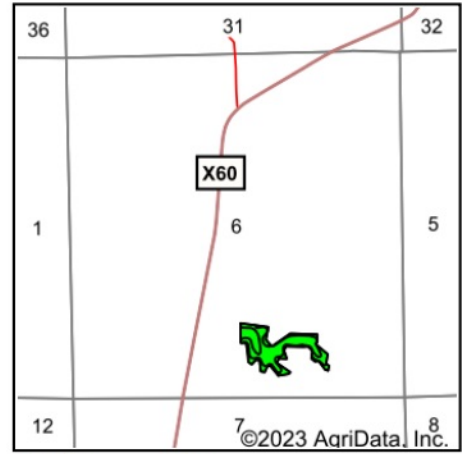

State: Iowa
 County: Des Moines
 Location: 6-70N-2W
 Township: Tama
 Acres: 11.39
 Date: 11/7/2023



Maps Provided By:



© AgriData, Inc. 2023

www.AgriDataInc.com



Area Symbol: IA057, Soil Area Version: 28

Code	Soil Description	Acres	Percent of field	CSR2 Legend	Non-Irr Class *c	CSR2**	CSR	*n NCCPI Overall	*n NCCPI Corn	*n NCCPI Small Grains	*n NCCPI Soybeans	
80B	Clinton silt loam, 2 to 5 percent slopes	6.15	54.0%		lle	80	80	82	82	70	73	
80C2	Clinton silt loam, 5 to 9 percent slopes, eroded	3.03	26.6%		llle	69	60	74	74	63	61	
180	Keomah silt loam, 1 to 3 percent slopes	1.51	13.3%		lw	76	76	90	90	78	79	
80C	Clinton silt loam, 5 to 9 percent slopes	0.44	3.9%		llle	72	65	79	79	67	70	
80D2	Clinton silt loam, 9 to 14 percent slopes, eroded	0.26	2.3%		llle	46	50	71	71	61	57	
Weighted Average						2.19	75.5	72.9	*n 80.6	*n 80.6	*n 68.9	*n 70.1

**IA has updated the CSR values for each county to CSR2.

*n: The aggregation method is "Weighted Average using all components"

*c: Using Capabilities Class Dominant Condition Aggregation Method

Soils data provided by USDA and NRCS.