

Soils Map

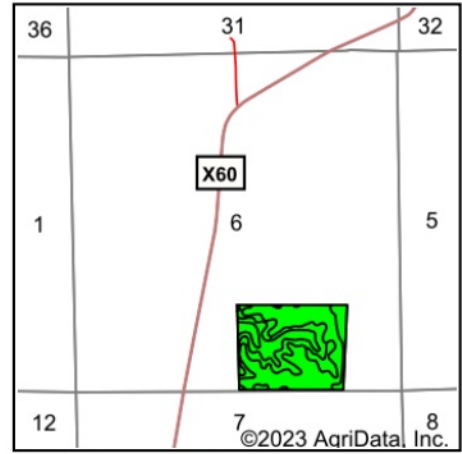

State: Iowa
 County: Des Moines
 Location: 6-70N-2W
 Township: Tama
 Acres: 52.45
 Date: 11/7/2023

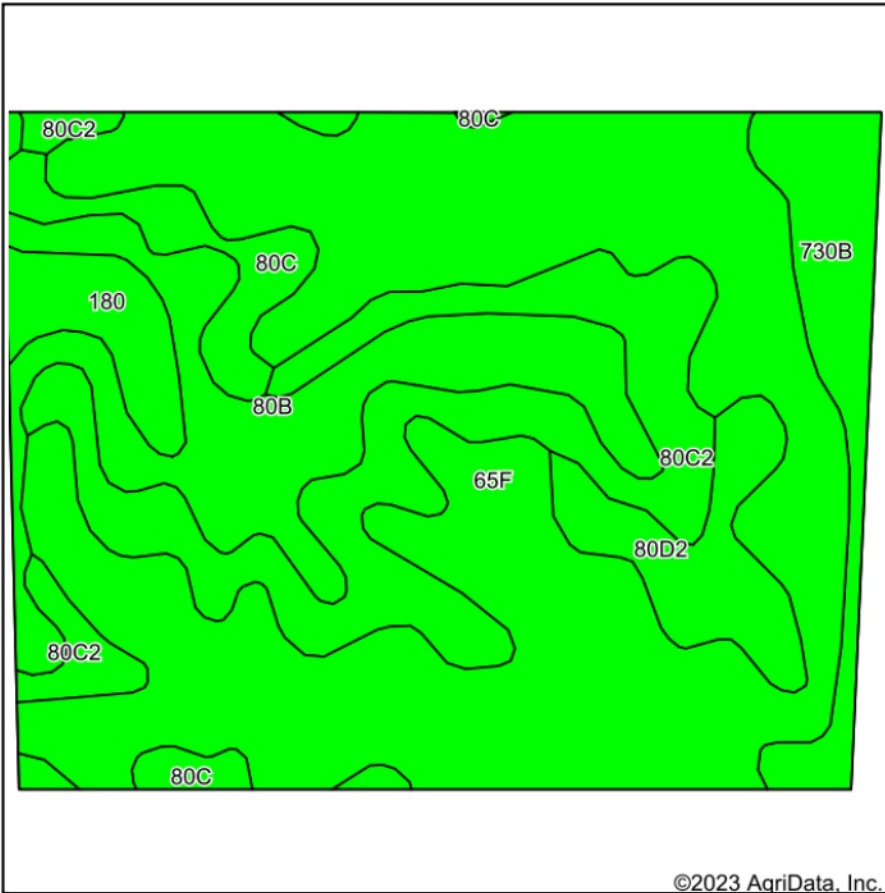

Maps Provided By:
surety
 CUSTOMIZED ONLINE MAPPING
 © AgriData, Inc. 2023 www.AgriDataInc.com



Soils data provided by USDA and NRCS.

Area Symbol: IA057, Soil Area Version: 28

Code	Soil Description	Acres	Percent of field	CSR2 Legend	Non-Irr Class *c	CSR2**	CSR	*n NCCPI Overall	*n NCCPI Corn	*n NCCPI Small Grains	*n NCCPI Soybeans	
65F	Lindley loam, 18 to 25 percent slopes	26.22	50.0%		Vlle	14	10	58	58	40	43	
80C2	Clinton silt loam, 5 to 9 percent slopes, eroded	9.31	17.8%		llle	69	60	74	74	63	61	
80B	Clinton silt loam, 2 to 5 percent slopes	6.98	13.3%		lle	80	80	82	82	70	73	
730B	Nodaway-Cantril-Klum complex, 2 to 5 percent slopes	3.21	6.1%		llw	73	50	80	79	59	72	
80D2	Clinton silt loam, 9 to 14 percent slopes, eroded	2.67	5.1%		llle	46	50	71	71	61	57	
80C	Clinton silt loam, 5 to 9 percent slopes	2.34	4.5%		llle	72	65	79	79	67	70	
180	Keomah silt loam, 1 to 3 percent slopes	1.72	3.3%		lw	76	76	90	90	78	79	
Weighted Average						4.74	42.4	37.3	*n 68	*n 68	*n 52.8	*n 55.1

**IA has updated the CSR values for each county to CSR2.

*n: The aggregation method is "Weighted Average using all components"

*c: Using Capabilities Class Dominant Condition Aggregation Method