

Soils Map

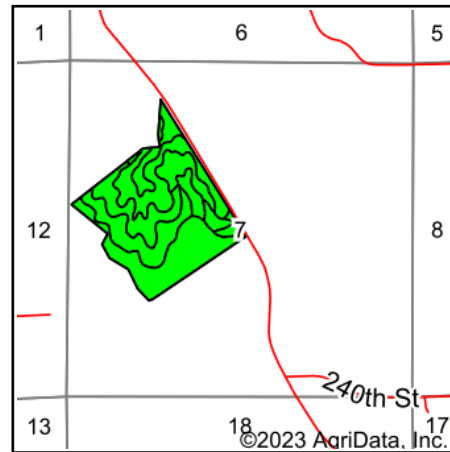

State: **Iowa**
 County: **Jefferson**
 Location: **7-71N-9W**
 Township: **Cedar**
 Acres: **92.35**
 Date: **11/17/2023**

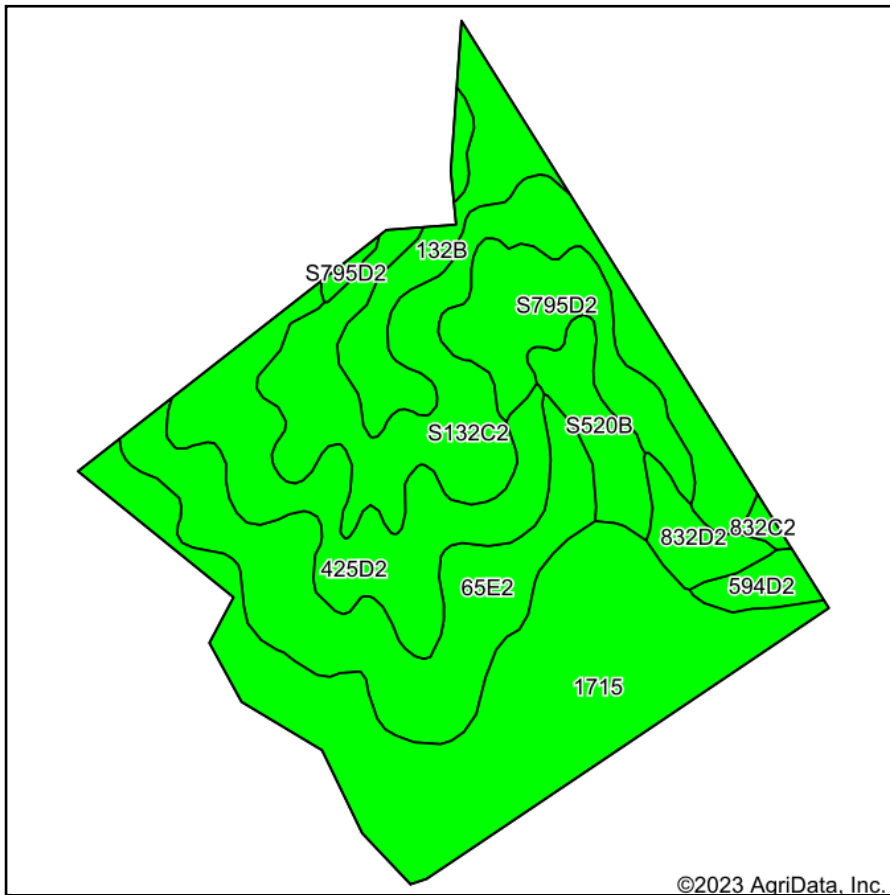

Maps Provided By:



Soils data provided by USDA and NRCS.

©2023 AgriData, Inc.

© AgriData, Inc. 2023

www.AgriDataInc.com

Area Symbol: IA101, Soil Area Version: 31

Code	Soil Description	Acres	Percent of field	CSR2 Legend	Non-Irr Class *c	CSR2**	CSR	*n NCCPI Overall	*n NCCPI Corn	*n NCCPI Small Grains	*n NCCPI Soybeans	
1715	Nodaway-Vesser-Ackmore complex, 0 to 2 percent slopes	26.16	28.3%		Ilw	74	80	86	83	54	83	
S132C2	Weller silty clay loam, 5 to 9 percent slopes, moderately eroded	17.54	19.0%		Ille	59		81	81	69	67	
65E2	Lindley loam, 14 to 18 percent slopes, moderately eroded	15.04	16.3%		Vle	29	28	66	66	56	53	
425D2	Keswick clay loam, 9 to 14 percent slopes, moderately eroded	12.37	13.4%		IVe	8	12	52	51	51	38	
S795D2	Ashgrove silty clay loam, 9 to 14 percent slopes, moderately eroded	7.52	8.1%		IVe	7		50	50	46	39	
132B	Weller silt loam, 2 to 5 percent slopes	6.10	6.6%		Ille	67	60	89	89	77	80	
S520B	Coppock silt loam, 2 to 5 percent slopes, rarely flooded	3.44	3.7%		Ilw	80		90	90	77	89	
832D2	Weller silty clay loam, terrace, 9 to 14 percent slopes, moderately eroded	2.27	2.5%		IVe	35	28	80	80	67	63	
594D2	Galland clay loam, 9 to 14 percent slopes, moderately eroded	1.51	1.6%		IVe	8	5	59	59	56	44	
832C2	Weller silty clay loam, terrace, 5 to 9 percent slopes, moderately eroded	0.40	0.4%		IVe	61	40	84	84	70	69	
Weighted Average						3.43	47.2	*-	*n 74.1	*n 73.1	*n 58.9	*n 64.3

**IA has updated the CSR values for each county to CSR2.

*- CSR weighted average cannot be calculated on the current soils data, use prior data version for csr values.

*n: The aggregation method is "Weighted Average using all components"

*c: Using Capabilities Class Dominant Condition Aggregation Method

Soils data provided by USDA and NRCS.