

Soils Map

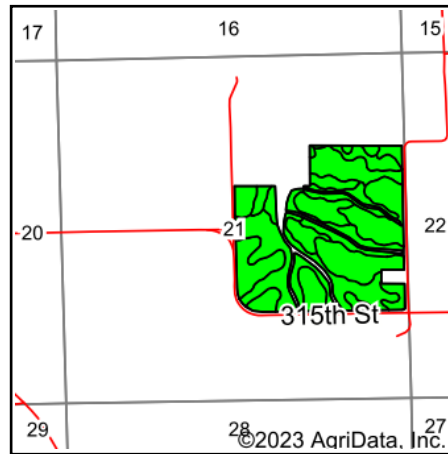

State: **Iowa**
 County: **Delaware**
 Location: **21-87N-4W**
 Township: **Union**
 Acres: **122.81**
 Date: **9/25/2023**

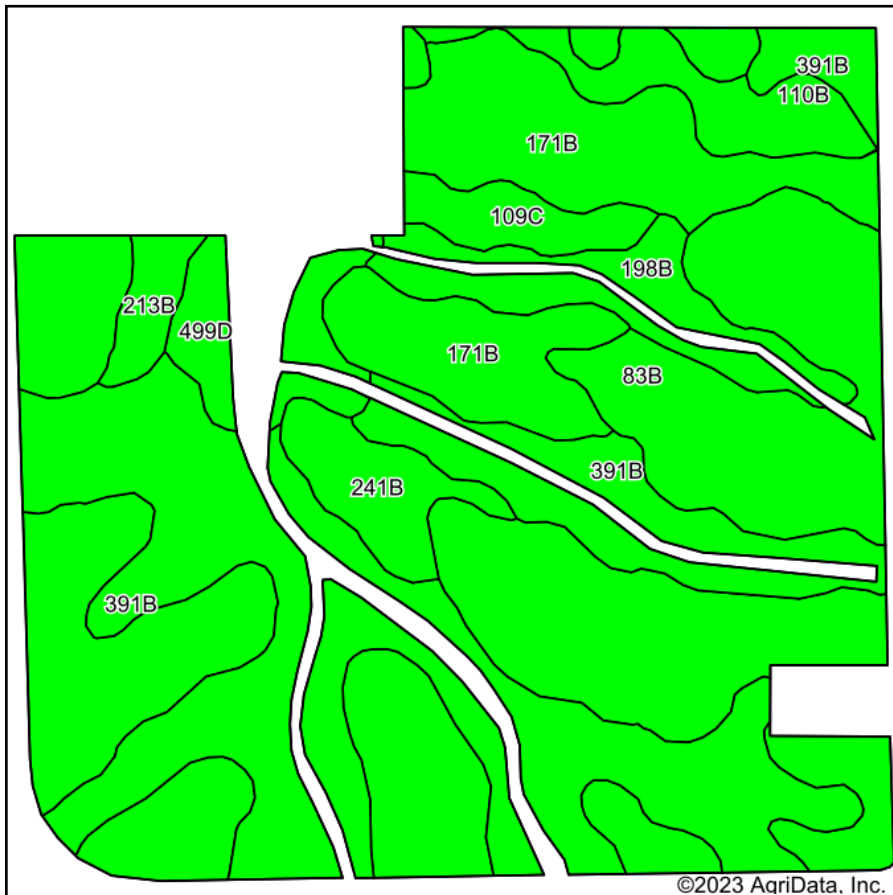

Maps Provided By:



Soils data provided by USDA and NRCS.

Area Symbol: IA055, Soil Area Version: 29

Code	Soil Description	Acres	Percent of field	CSR2 Legend	Non-Irr Class *c	Irr Class *c	CSR2**	CSR	Corn Bu	Soybeans Bu	*n NCCPI Overall	*n NCCPI Corn	*n NCCPI Small Grains	*n NCCPI Soybeans		
83B	Kenyon loam, 2 to 5 percent slopes	48.86	39.8%		Ile		90	86			87	86	66	71		
391B	Clyde-Floyd complex, 1 to 4 percent slopes	36.32	29.6%		Ilw		87	74			89	87	70	86		
171B	Bassett loam, 2 to 5 percent slopes	15.58	12.7%		Ile		85	81	215	62	85	85	68	73		
198B	Floyd loam, 1 to 4 percent slopes	5.19	4.2%		Ilw		89	75			88	83	63	88		
110B	Lamont fine sandy loam, 2 to 5 percent slopes	4.21	3.4%		Ille		52	47			67	67	61	50		
109C	Backbone fine sandy loam, 5 to 9 percent slopes	3.93	3.2%		IVs		31	15			58	58	49	43		
241B	Burkhardt-Saude complex, 2 to 5 percent slopes	3.65	3.0%		IVs	Ile	35	40			61	61	55	36		
499D	Nordness silt loam, 5 to 14 percent slopes	3.42	2.8%		VIs		5	5			50	50	43	34		
213B	Rockton loam, 30 to 40 inches to limestone, 2 to 5 percent	1.65	1.3%		Ile		53	74			71	71	69	60		
Weighted Average							2.27	*-	80.7	74	27.3	7.9	*n 83.7	*n 82.5	*n 65.7	*n 72.6

**IA has updated the CSR values for each county to CSR2.

*n: The aggregation method is "Weighted Average using all components"

*c: Using Capabilities Class Dominant Condition Aggregation Method

*- Irr Class weighted average cannot be calculated on the current soils data due to missing data.

Soils data provided by USDA and NRCS.