

Soils Map

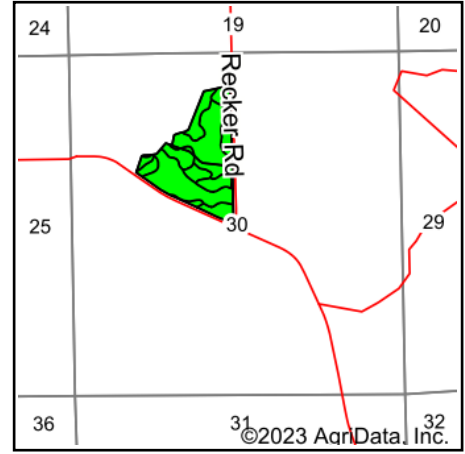

State: **Iowa**
 County: **Dubuque**
 Location: **30-87N-2W**
 Township: **Cascade**
 Acres: **40.77**
 Date: **9/18/2023**

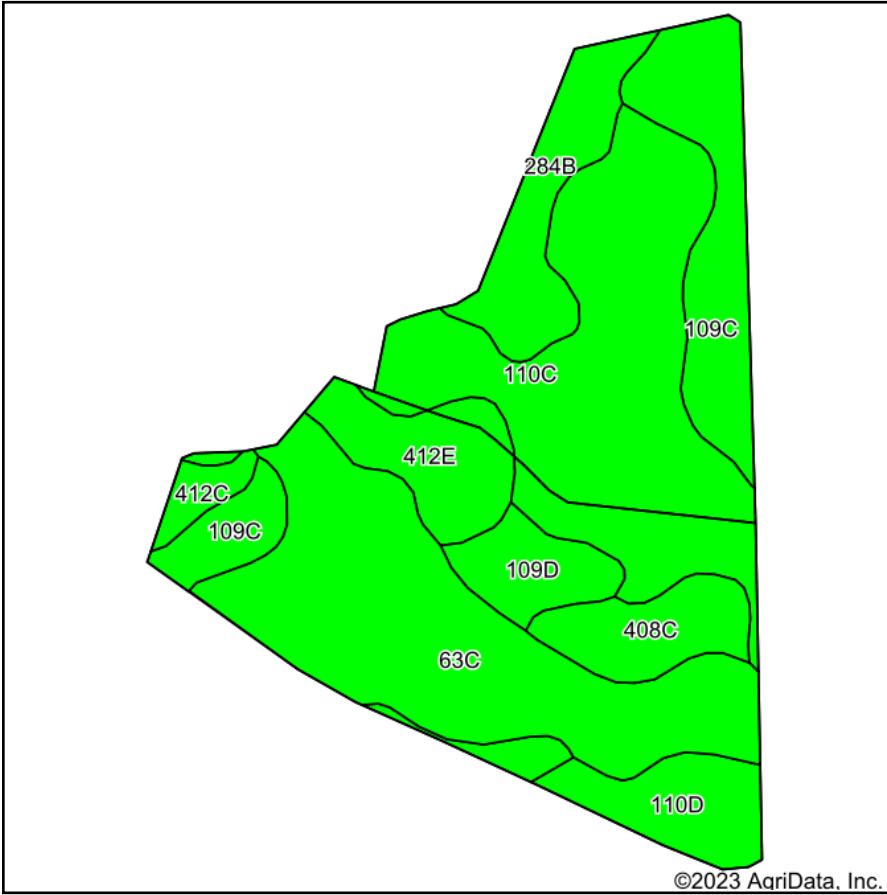

Maps Provided By:

 © AgriData, Inc. 2023 www.AgriDataInc.com



Soils data provided by USDA and NRCS.

Area Symbol: IA061, Soil Area Version: 24

Code	Soil Description	Acres	Percent of field	CSR2 Legend	Non-Irr Class *c	CSR2**	CSR	*n NCCPI Overall	*n NCCPI Corn	*n NCCPI Small Grains	*n NCCPI Soybeans	
110C	Lamont fine sandy loam, 5 to 9 percent slopes	11.89	29.2%		IIIe	47	32	67	67	61	50	
63C	Chelsea loamy fine sand, 5 to 9 percent slopes	10.77	26.4%		IVs	14	21	32	32	30	29	
109C	Backbone fine sandy loam, 5 to 9 percent slopes	5.77	14.2%		IVs	31	15	58	58	49	43	
284B	Flagler sandy loam, 2 to 5 percent slopes	3.00	7.4%		IIIe	51	45	61	61	53	35	
412E	Emeline loam, 9 to 18 percent slopes	2.69	6.6%		VI s	5		24	23	24	16	
110D	Lamont fine sandy loam, 9 to 14 percent slopes	2.22	5.4%		IVe	22	22	64	64	58	46	
408C	Olin sandy loam, 5 to 9 percent slopes	2.13	5.2%		IIe	59	53	70	70	51	55	
109D	Backbone fine sandy loam, 9 to 14 percent slopes	1.68	4.1%		VI s	5	5	53	53	45	39	
412C	Sogn loam, 2 to 9 percent slopes	0.62	1.5%		IVs	5	20	34	34	29	24	
Weighted Average						3.74	30.4	*-	*n 52.1	*n 52.1	*n 46.3	*n 39.3

**IA has updated the CSR values for each county to CSR2.

*- CSR weighted average cannot be calculated on the current soils data, use prior data version for csr values.

*n: The aggregation method is "Weighted Average using all components"

*c: Using Capabilities Class Dominant Condition Aggregation Method

Soils data provided by USDA and NRCS.