

Soils Map

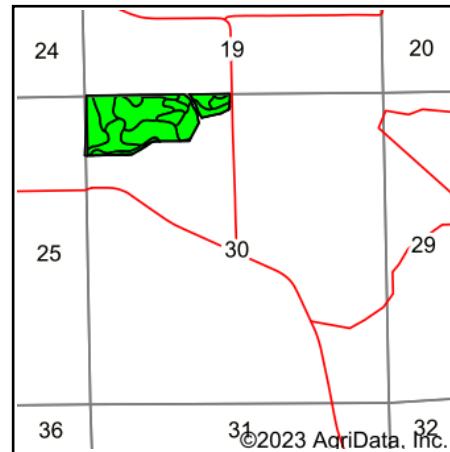

State: **Iowa**
 County: **Dubuque**
 Location: **30-87N-2W**
 Township: **Cascade**
 Acres: **44.26**
 Date: **9/18/2023**

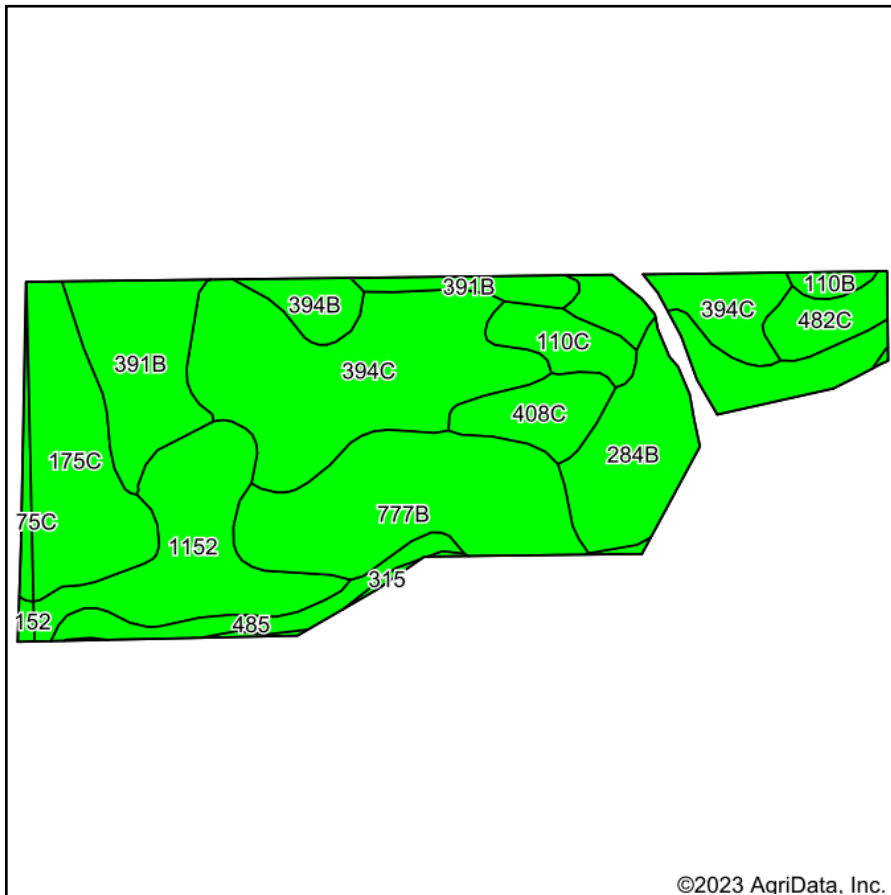

Maps Provided By:



Soils data provided by USDA and NRCS.

©2023 AgriData, Inc.

© AgriData, Inc. 2023

www.AgriDataInc.com

Area Symbol: IA055, Soil Area Version: 29
 Area Symbol: IA061, Soil Area Version: 24

Code	Soil Description	Acres	Percent of field	CSR2 Legend	Non-Irr Class *c	CSR2**	CSR	*n NCCPI Overall	*n NCCPI Corn	*n NCCPI Small Grains	*n NCCPI Soybeans	
394C	Ostrander loam, 5 to 9 percent slopes	10.54	23.8%		IIIe	83	71	74	74	69	64	
777B	Wapsie loam, 2 to 7 percent slopes	6.74	15.2%		Ile	42	46	65	65	59	41	
284B	Flagler sandy loam, 2 to 5 percent slopes	5.18	11.7%		IIIe	51	45	61	61	53	35	
1152	Marshan clay loam, 0 to 2 percent slopes, rarely flooded	4.94	11.2%		IIw	54	68	81	81	65	60	
175C	Dickinson fine sandy loam, 5 to 12 percent slopes	4.68	10.6%		IIIe	29	37	53	53	49	30	
391B	Clyde-Floyd complex, 1 to 4 percent slopes	4.36	9.9%		IIw	87	72	89	87	70	86	
408C	Olin sandy loam, 5 to 9 percent slopes	1.69	3.8%		Ile	59	53	70	70	51	55	
485	Spillville loam, 0 to 2 percent slopes, occasionally flooded	1.46	3.3%		IIw	76	93	87	87	51	74	
110C	Lamont fine sandy loam, 5 to 9 percent slopes	1.35	3.1%		IIIe	47	32	67	67	61	50	
482C	Racine loam, 5 to 9 percent slopes	1.21	2.7%		IIIe	75	66	88	88	74	76	
394B	Ostrander loam, 2 to 5 percent slopes	0.95	2.1%		Ile	88	86	75	75	69	66	
175C	Dickinson fine sandy loam, 5 to 9 percent slopes	0.43	1.0%		IIIe	45	40	60	60	52	36	
110B	Lamont fine sandy loam, 2 to 5 percent slopes	0.34	0.8%		IIIe	52	48	67	67	61	50	
315	Udifluvents, loamy, 0 to 2 percent slopes	0.27	0.6%		Vw	5	5	22	13	22	9	
1152	Marshan clay loam, 0 to 2 percent slopes, rarely flooded	0.12	0.3%		IIw	54	68	81	81	65	60	
Weighted Average						2.55	60.9	58.5	*n 71.1	*n 70.9	*n 61.2	*n 54.4

**IA has updated the CSR values for each county to CSR2.
*n: The aggregation method is "Weighted Average using all components"
*c: Using Capabilities Class Dominant Condition Aggregation Method
Soils data provided by USDA and NRCS.