

# Soils Map

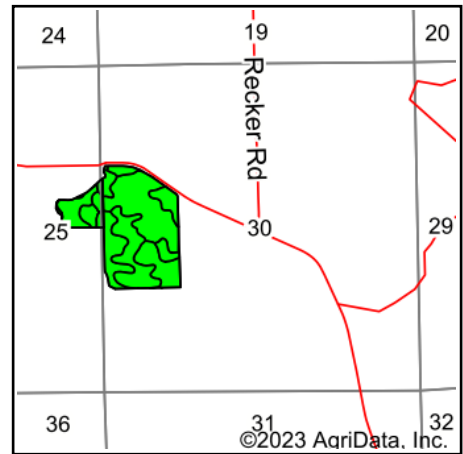

State: **Iowa**  
 County: **Dubuque**  
 Location: **30-87N-2W**  
 Township: **Cascade**  
 Acres: **60.39**  
 Date: **9/18/2023**

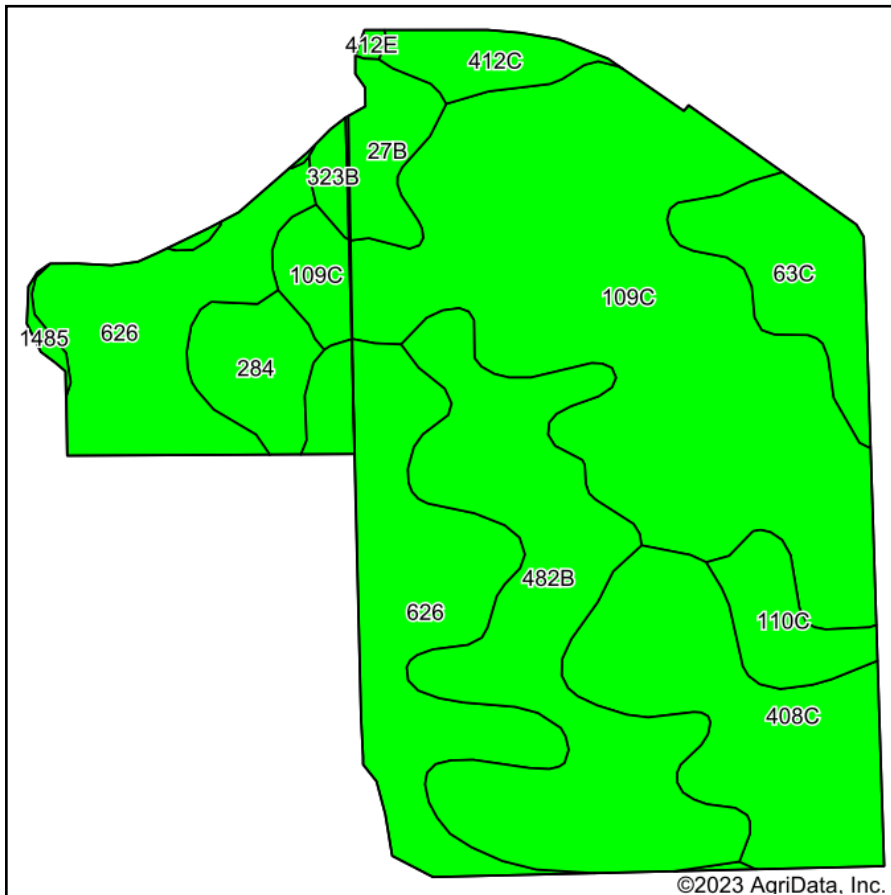

Maps Provided By:



Soils data provided by USDA and NRCS.

Area Symbol: IA055, Soil Area Version: 29  
 Area Symbol: IA061, Soil Area Version: 24

Code	Soil Description	Acres	Percent of field	CSR2 Legend	Non-Irr Class *c	CSR2**	CSR	*n NCCPI Overall	*n NCCPI Corn	*n NCCPI Small Grains	*n NCCPI Soybeans	*n NCCPI Cotton
109C	Backbone fine sandy loam, 5 to 9 percent slopes	18.81	31.1%		IVs	31	15	58	58	49	43	
482B	Racine loam, 2 to 5 percent slopes	10.79	17.9%		Ile	76	81	65	65	46	55	
626	Hayfield loam, 0 to 2 percent slopes, rarely flooded	6.96	11.5%		Ils	53	72	81	81	68	55	1
408C	Olin sandy loam, 5 to 9 percent slopes	6.87	11.4%		Ile	59	53	70	70	51	55	
626	Hayfield loam, 0 to 2 percent slopes, rarely flooded	5.53	9.2%		Ils	53	67	81	81	68	55	1
63C	Chelsea loamy fine sand, 5 to 9 percent slopes	3.09	5.1%		IVs	14	21	32	32	30	29	
284	Flagler fine sandy loam, 0 to 2 percent slopes	1.93	3.2%		IIIs	56	50	63	63	53	37	
110C	Lamont fine sandy loam, 5 to 9 percent slopes	1.72	2.8%		IIIle	47	32	67	67	61	50	
27B	Terril loam, 2 to 5 percent slopes	1.53	2.5%		Ile	89	83	96	96	69	88	
412C	Sogn loam, 2 to 9 percent slopes	1.36	2.3%		IVs	5	20	34	34	29	24	
109C	Backbone fine sandy loam, 5 to 9 percent slopes	1.04	1.7%		IVs	31	15	58	58	49	43	
323B	Fort Dodge loam, 2 to 5 percent slopes	0.44	0.7%		Ile	79	72	95	95	67	81	
1485	Spillville loam, channeled, 0 to 2 percent slopes	0.23	0.4%		Vw	41	25	59	59	32	49	
412E	Emeline loam, 9 to 18 percent slopes	0.09	0.1%		VIIs	5		24	23	24	16	



<b>Weighted Average</b>	<b>2.88</b>	<b>48.4</b>	<b>*-</b>	<b>*n 65.1</b>	<b>*n 65.1</b>	<b>*n 52.2</b>	<b>*n 49.3</b>	<b>*n 0.2</b>
-------------------------	-------------	-------------	-----------	----------------	----------------	----------------	----------------	---------------

\*\*IA has updated the CSR values for each county to CSR2.

\*- CSR weighted average cannot be calculated on the current soils data, use prior data version for csr values.

\*n: The aggregation method is "Weighted Average using all components"

\*c: Using Capabilities Class Dominant Condition Aggregation Method

Soils data provided by USDA and NRCS.