

Soils Map

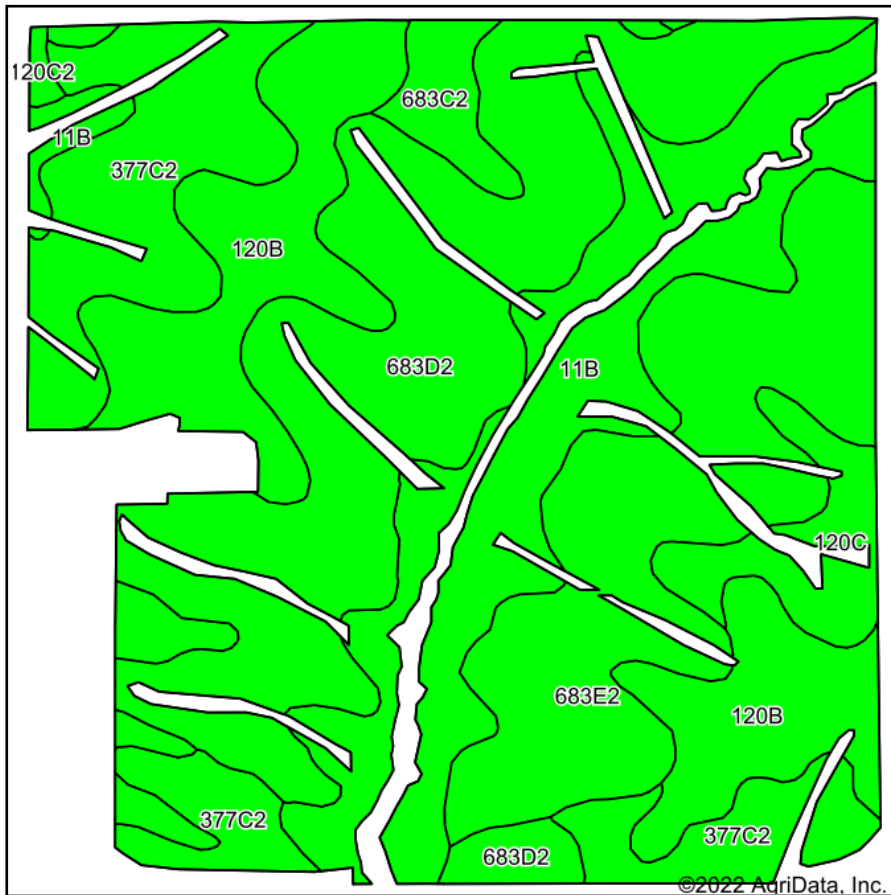

Soils data provided by USDA and NRCS.

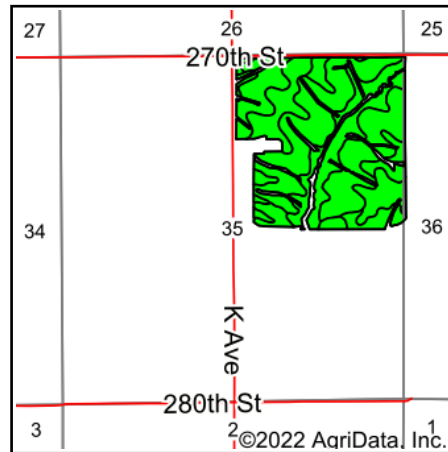

State: **Iowa**
 County: **Tama**
 Location: **35-84N-15W**
 Township: **Howard**
 Acres: **132.64**
 Date: **9/6/2022**



Maps Provided By:



© AgriData, Inc. 2021

www.AgriDataInc.com



Area Symbol: IA171, Soil Area Version: 26

Code	Soil Description	Acres	Percent of field	CSR2 Legend	Non-Irr Class *c	CSR2**	CSR	*n NCCPI Overall	*n NCCPI Corn	*n NCCPI Small Grains	*n NCCPI Soybeans	
683D2	Liscomb loam, 9 to 14 percent slopes, eroded	35.32	26.6%		IIIe	55	59	68	68	59	56	
683E2	Liscomb loam, 14 to 18 percent slopes, eroded	24.11	18.2%		IVe	43	49	64	64	55	51	
11B	Colo-Ely complex, 0 to 5 percent slopes	23.26	17.5%		IIw	86	68	92	92	65	76	
120B	Tama silty clay loam, 2 to 5 percent slopes	22.59	17.0%		Ile	95	95	97	97	79	80	
377C2	Dinsdale silty clay loam, 5 to 9 percent slopes, eroded	19.51	14.7%		IIIe	85	73	80	80	64	63	
120C	Tama silty clay loam, 5 to 9 percent slopes	4.66	3.5%		IIIe	90	80	93	93	78	77	
683C2	Liscomb loam, 5 to 9 percent slopes, eroded	2.82	2.1%		IIIe	83	69	73	73	63	62	
120C2	Tama silty clay loam, 5 to 9 percent slopes, eroded	0.37	0.3%		IIIe	87	78	91	91	72	71	
Weighted Average						2.84	71.4	68	*n 79.2	*n 79.2	*n 64.3	*n 64.6

**IA has updated the CSR values for each county to CSR2.

*n: The aggregation method is "Weighted Average using all components"

*c: Using Capabilities Class Dominant Condition Aggregation Method

Soils data provided by USDA and NRCS.