

Soils Map

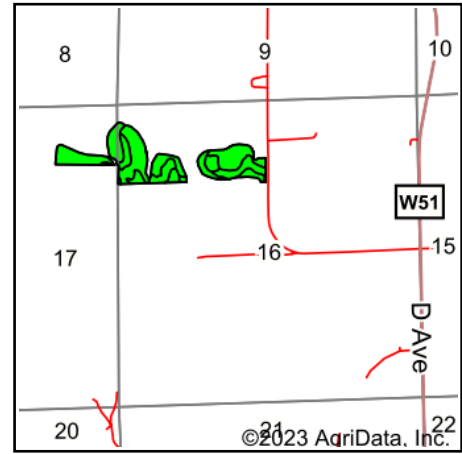

State: **Iowa**
 County: **Fayette**
 Location: **16-92N-7W**
 Township: **Fairfield**
 Acres: **36.3**
 Date: **7/26/2023**

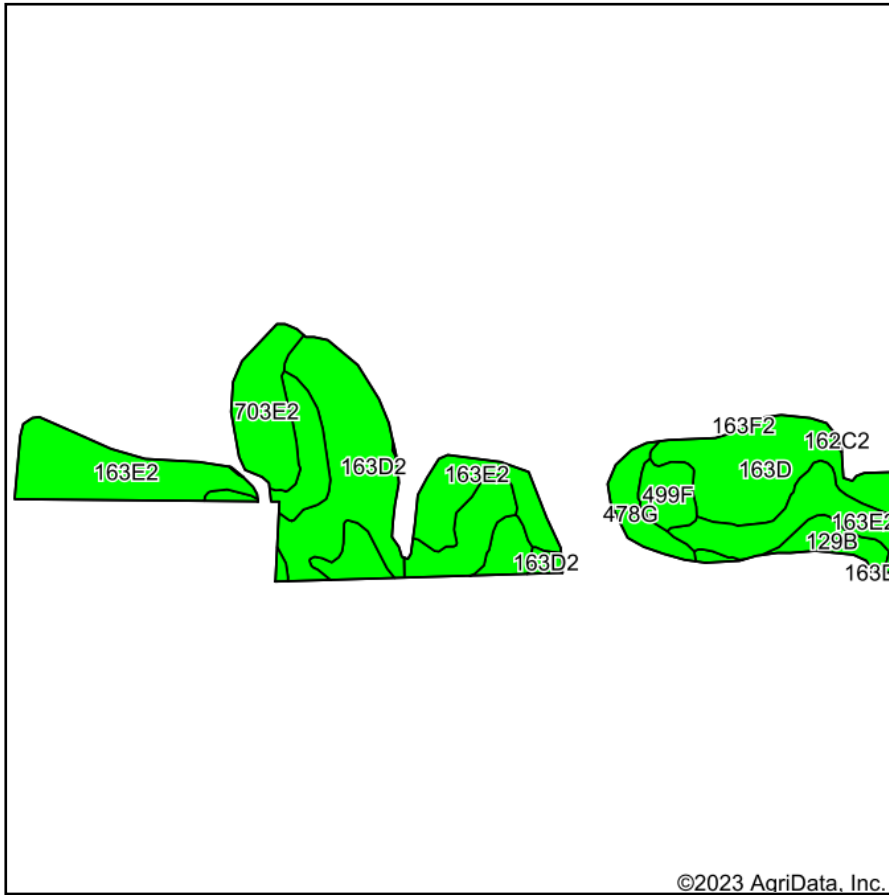

Maps Provided By:



Soils data provided by USDA and NRCS.

Area Symbol: IA065, Soil Area Version: 27

Code	Soil Description	Acres	Percent of field	CSR2 Legend	Non-Irr Class *c	CSR2**	CSR	*n NCCPI Overall	*n NCCPI Corn	*n NCCPI Small Grains	*n NCCPI Soybeans		
163E2	Fayette silt loam, 14 to 18 percent slopes, moderately eroded	12.22	33.7%		IVe	35	48	74	74	61	58		
163D2	Fayette silt loam, 9 to 14 percent slopes, moderately eroded	9.28	25.6%		IIIe	46	58	78	78	66	62		
163D	Fayette silt loam, 9 to 14 percent slopes	5.62	15.5%		IIIe	49	60	82	82	71	70		
703E2	Dubuque silt loam, 14 to 18 percent slopes, moderately eroded	3.20	8.8%		IVe	8		48	48	47	41		
163C	Fayette silt loam, 5 to 9 percent slopes	1.91	5.3%		IIIe	75	70	86	86	74	74		
478G	Rock outcrop-Nordness complex, 25 to 60 percent slopes	1.47	4.0%			5	5	10	10	6	3		
129B	Arenzville-Chaseburg complex, 1 to 5 percent slopes	1.30	3.6%		IIw	73		85	85	71	83		
499F	Nordness silt loam, 14 to 25 percent slopes	1.30	3.6%		VIIIs	5	5	41	41	32	25		
Weighted Average							*-	38.8	*-	*n 71.2	*n 71.2	*n 60.4	*n 57.7

**IA has updated the CSR values for each county to CSR2.

*- CSR weighted average cannot be calculated on the current soils data, use prior data version for csr values.

*n: The aggregation method is "Weighted Average using all components"

*c: Using Capabilities Class Dominant Condition Aggregation Method

*- Non Irr Class weighted average cannot be calculated on the current soils data due to missing data.

Soils data provided by USDA and NRCS.