

Soils Map

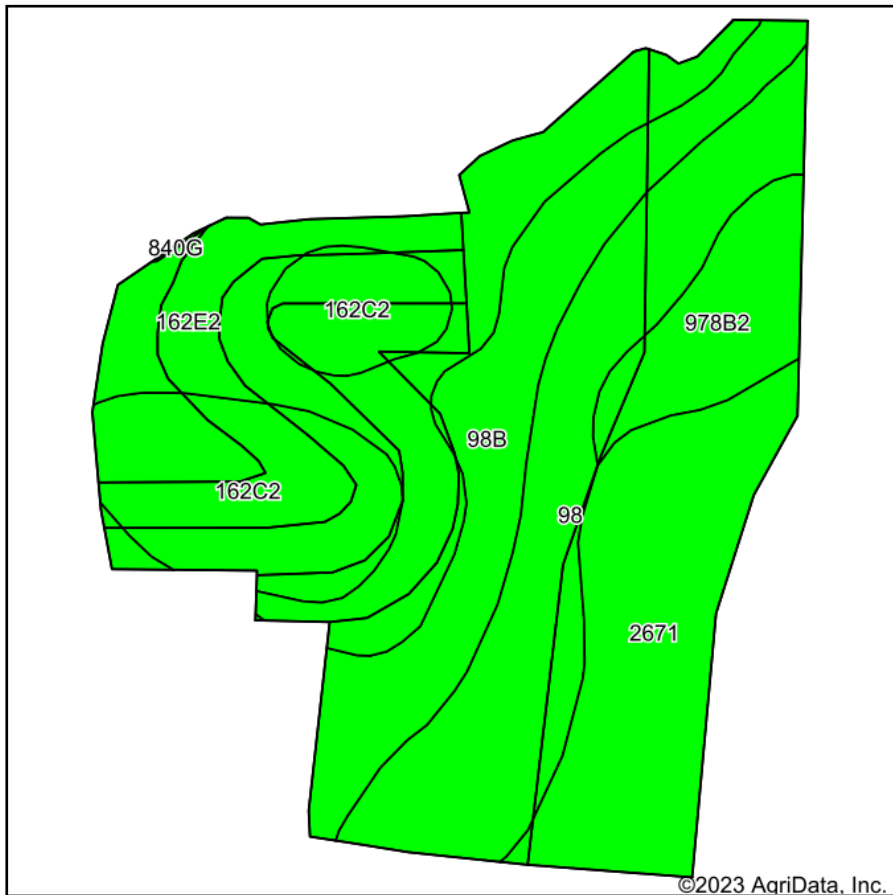

Soils data provided by USDA and NRCS.

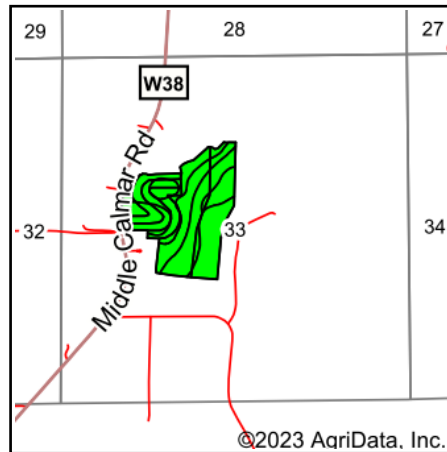

State: **Iowa**
 County: **Winneshiek**
 Location: **33-98N-8W**
 Township: **Decorah**
 Acres: **54.27**
 Date: **8/22/2023**



Maps Provided By:



© AgriData, Inc. 2023

www.AgriDataInc.com



Area Symbol: IA191, Soil Area Version: 31

Code	Soil Description	Acres	Percent of field	CSR2 Legend	Non-Irr Class *c	CSR2**	CSR	*n NCCPI Overall	*n NCCPI Corn	*n NCCPI Small Grains	*n NCCPI Soybeans	
162E2	Downs silt loam, 14 to 18 percent slopes, moderately eroded	11.69	21.5%		IVe	42	51	76	76	63	62	
98	Huntsville silt loam, 0 to 2 percent slopes, occasionally flooded	10.91	20.1%		IIw	93	95	89	89	67	88	
2671	Ion-Eitzen complex, 0 to 2 percent slopes, occasionally flooded	9.72	17.9%		IIw	76	88	74	74	63	73	
162C2	Downs silt loam, 5 to 9 percent slopes, moderately eroded	9.15	16.9%		IIIe	80		85	85	71	72	
98B	Huntsville silt loam, 2 to 5 percent slopes, occasionally flooded	8.93	16.5%		IIe	88	90	88	88	67	86	
978B2	Festina silt loam, 1 to 6 percent slopes, moderately eroded	3.87	7.1%		IIe	84		81	81	71	72	
Weighted Average						2.60	75.3	*-	*n 82.1	*n 82.1	*n 66.4	*n 75.5

**IA has updated the CSR values for each county to CSR2.

*- CSR weighted average cannot be calculated on the current soils data, use prior data version for csr values.

*n: The aggregation method is "Weighted Average using all components"

*c: Using Capabilities Class Dominant Condition Aggregation Method

Soils data provided by USDA and NRCS.