

Soils Map

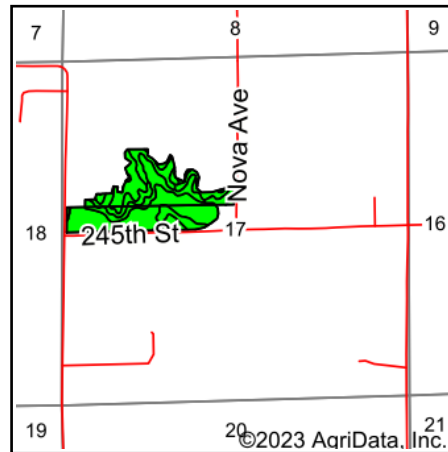

State: **Iowa**
 County: **Van Buren**
 Location: **17-68N-9W**
 Township: **Vernon**
 Acres: **43.48**
 Date: **5/29/2023**

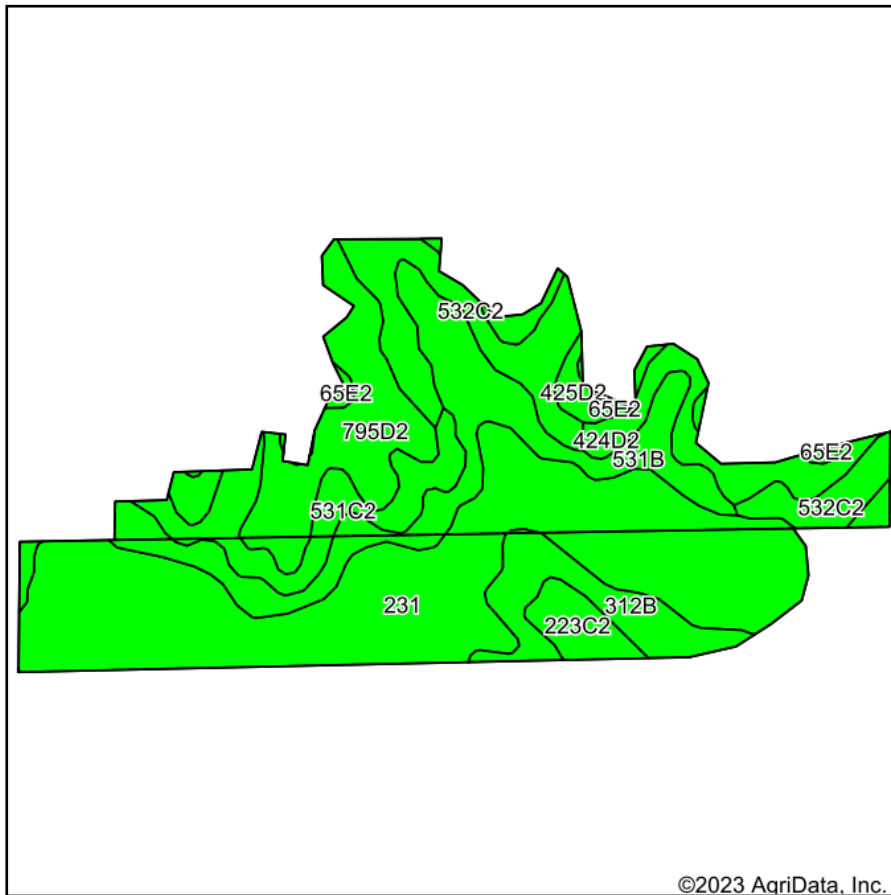

Maps Provided By:



Soils data provided by USDA and NRCS.

Area Symbol: IA177, Soil Area Version: 30

Code	Soil Description	Acres	Percent of field	CSR2 Legend	Non-Irr Class *c	CSR2**	CSR	*n NCCPI Overall	*n NCCPI Corn	*n NCCPI Small Grains	*n NCCPI Soybeans	
231	Edina silt loam, 0 to 2 percent slopes	17.31	39.8%		IIIw	59	63	70	70	69	64	
531B	Kniffin silt loam, 2 to 5 percent slopes	6.34	14.6%		IIIe	55	54	71	64	71	66	
795D2	Ashgrove silty clay loam, 9 to 14 percent slopes, moderately eroded	5.06	11.6%		IVe	7	8	50	50	46	39	
532C2	Rathbun silty clay loam, 5 to 9 percent slopes, moderately eroded	4.54	10.4%		IIIe	44	28	71	71	61	51	
531C2	Kniffin silty clay loam, 5 to 9 percent slopes, moderately eroded	3.03	7.0%		IIIe	48	31	62	56	61	60	
312B	Seymour silt loam, 2 to 5 percent slopes	2.62	6.0%		IIIe	64	60	70	70	70	64	
424D2	Lindley-Keswick loams, 9 to 14 percent slopes, moderately eroded	2.15	4.9%		IVe	27	15	62	62	56	48	
223C2	Rinda silty clay loam, 5 to 9 percent slopes, moderately eroded	1.11	2.6%		IVw	45	22	60	60	52	46	
425D2	Keswick clay loam, 9 to 14 percent slopes, moderately eroded	0.80	1.8%		IVe	8	12	52	51	52	38	
65E2	Lindley loam, 14 to 18 percent slopes, moderately eroded	0.52	1.2%		VIe	29	28	66	66	56	53	
Weighted Average						3.25	47.1	44.4	*n 66.3	*n 64.9	*n 63.7	*n 57.9

**IA has updated the CSR values for each county to CSR2.

*n: The aggregation method is "Weighted Average using all components"

*c: Using Capabilities Class Dominant Condition Aggregation Method

Soils data provided by USDA and NRCS.