

# Soils Map

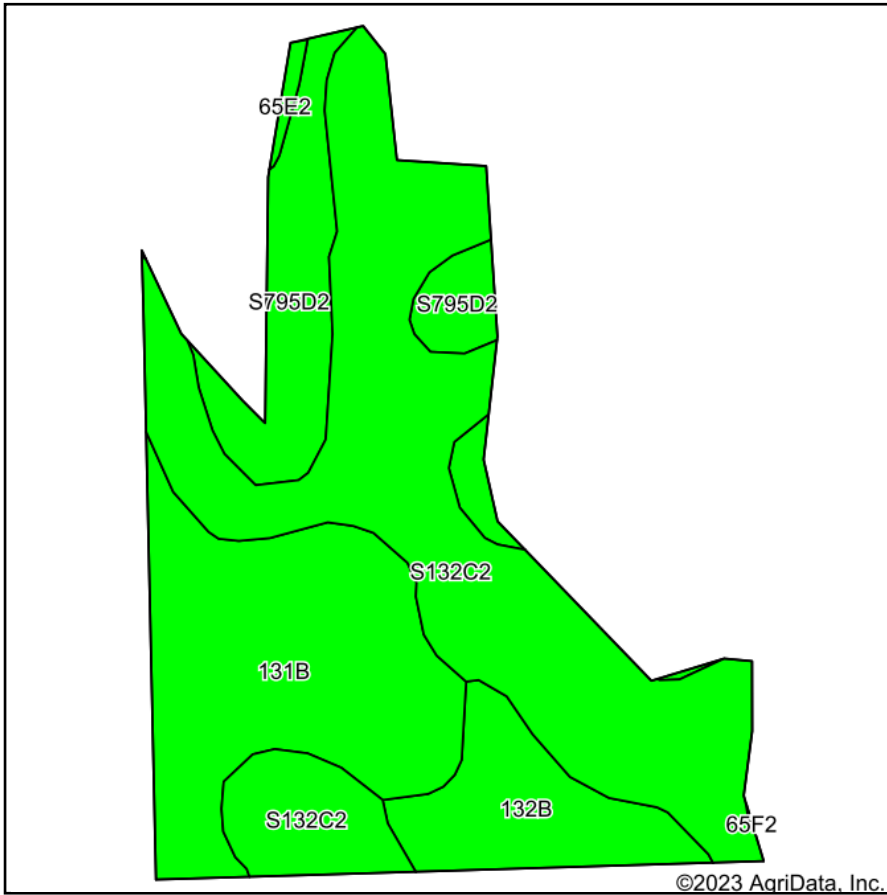

Soils data provided by USDA and NRCS.

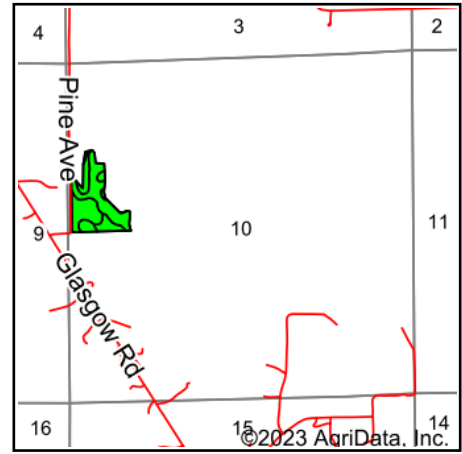

State: **Iowa**  
 County: **Jefferson**  
 Location: **10-71N-9W**  
 Township: **Cedar**  
 Acres: **15.12**  
 Date: **8/5/2023**



Maps Provided By:



Area Symbol: IA101, Soil Area Version: 30

Code	Soil Description	Acres	Percent of field	CSR2 Legend	Non-Irr Class *c	CSR2**	CSR	*n NCCPI Overall	*n NCCPI Corn	*n NCCPI Small Grains	*n NCCPI Soybeans	
S132C2	Weller silty clay loam, 5 to 9 percent slopes, moderately eroded	7.45	49.3%		IIIe	59		81	81	70	67	
131B	Pershing silt loam, 2 to 5 percent slopes	4.02	26.6%		IIIe	70	67	74	74	71	59	
S795D2	Ashgrove silty clay loam, 9 to 14 percent slopes, moderately eroded	2.06	13.6%		IVe	7		50	50	46	39	
132B	Weller silt loam, 2 to 5 percent slopes	1.51	10.0%		IIIe	67	60	89	89	78	80	
65E2	Lindley loam, 14 to 18 percent slopes, moderately eroded	0.08	0.5%		VIe	29	28	66	66	56	53	
<b>Weighted Average</b>						<b>3.15</b>	<b>55.5</b>	<b>*-</b>	<b>*n 75.6</b>	<b>*n 75.6</b>	<b>*n 67.7</b>	<b>*n 62.3</b>

\*\*IA has updated the CSR values for each county to CSR2.

\*- CSR weighted average cannot be calculated on the current soils data, use prior data version for csr values.

\*n: The aggregation method is "Weighted Average using all components"

\*c: Using Capabilities Class Dominant Condition Aggregation Method

Soils data provided by USDA and NRCS.