

Soils Map

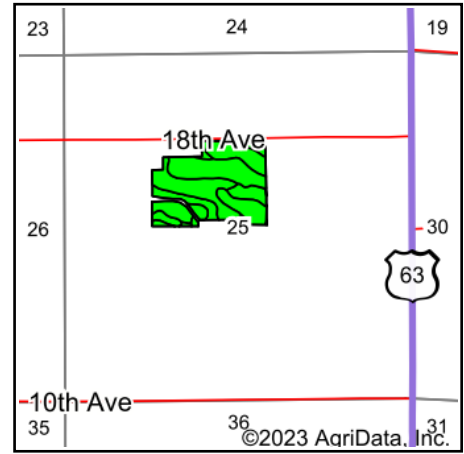

State: **Wisconsin**
 County: **St. Croix**
 Location: **25-28N-17W**
 Township: **Rush River**
 Acres: **44.01**
 Date: **3/15/2023**

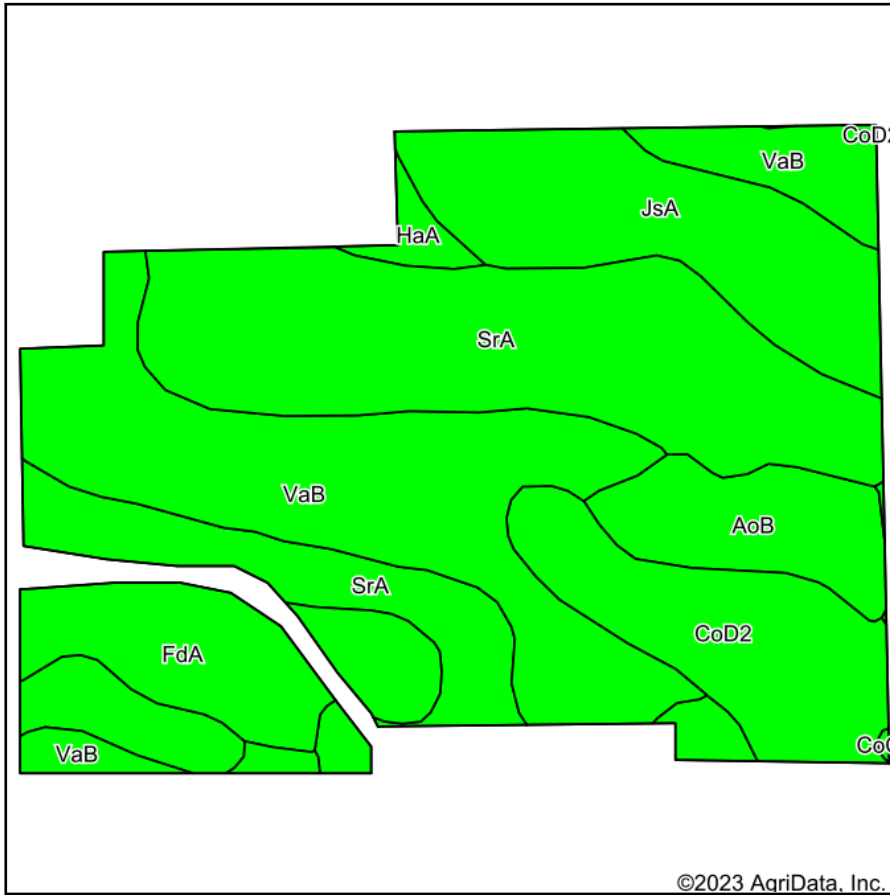

Maps Provided By:



Soils data provided by USDA and NRCS.

Area Symbol: WI109, Soil Area Version: 18

Code	Soil Description	Acres	Percent of field	Non-Irr Class Legend	Non-Irr Class *c	Corn Bu	Soybeans Bu	*n NCCPI Overall	*n NCCPI Corn	*n NCCPI Small Grains	*n NCCPI Soybeans
SrA	Skyberg silt loam, 0 to 3 percent slopes	15.31	34.8%		llw	115	38	72	51	50	72
VaB	Vlasaty silt loam, 2 to 6 percent slopes	11.34	25.8%		lle	130	43	80	80	57	66
JsA	Jewett silt loam, sandy substratum, 0 to 2 percent slopes	5.64	12.8%		lls	95	31	65	65	54	53
CoD2	Chetek-Onamia complex, 12 to 20 percent slopes, eroded	4.57	10.4%		Vle			43	43	34	25
FdA	Floyd silt loam, 0 to 3 percent slopes	3.97	9.0%		llw	125	41	86	54	54	86
AoB	Antigo silt loam, 2 to 6 percent slopes	2.72	6.2%		lle			54	54	50	41
HaA	Halder silt loam, 0 to 3 percent slopes	0.46	1.0%		llw	85	28	64	64	47	49
Weighted Average					2.42	97.8	32.3	*n 70.2	*n 60	*n 51	*n 62.2

*n: The aggregation method is "Weighted Average using all components"

*c: Using Capabilities Class Dominant Condition Aggregation Method

Soils data provided by USDA and NRCS.