

Soils Map

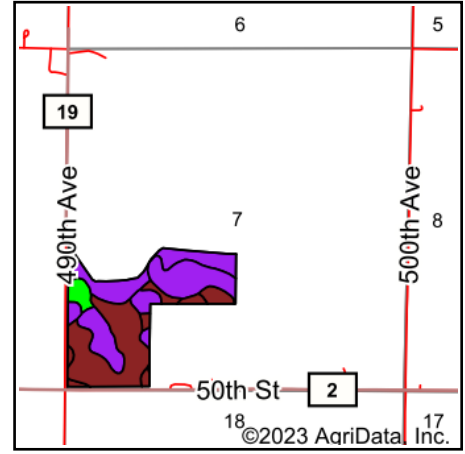

State: **Minnesota**
 County: **Faribault**
 Location: **7-101N-25W**
 Township: **Seely**
 Acres: **76.03**
 Date: **7/5/2023**

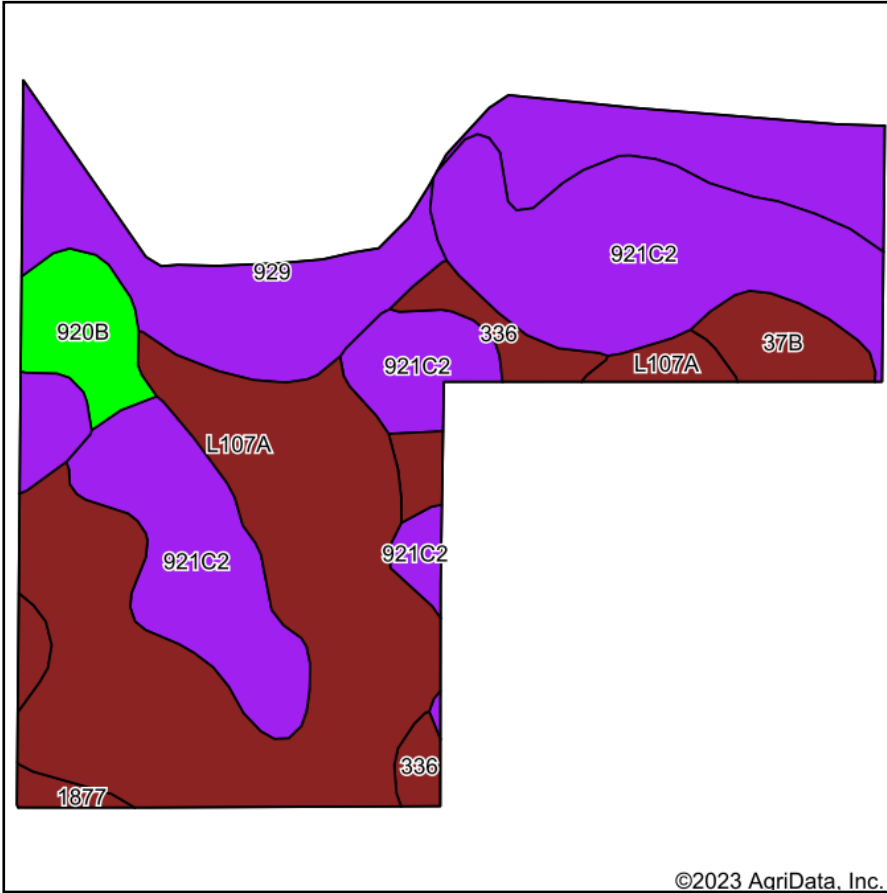

Maps Provided By:



Soils data provided by USDA and NRCS.

Area Symbol: MN043, Soil Area Version: 19

Code	Soil Description	Acres	Percent of field	PI Legend	Non-Irr Class *c	Productivity Index	*n NCCPI Overall	*n NCCPI Corn	*n NCCPI Small Grains	*n NCCPI Soybeans
L107A	Canisteo-Glencoe complex, 0 to 2 percent slopes	25.60	33.7%		llw	91	81	72	56	81
921C2	Clarion-Storden complex, 6 to 10 percent slopes, moderately eroded	24.23	31.9%		llle	87	71	69	52	71
929	Fieldon-Canisteo complex	16.42	21.6%		llw	83	73	68	48	69
920B	Clarion-Estherville complex, 2 to 6 percent slopes	3.22	4.2%		lle	76	68	66	53	63
336	Delft clay loam, 0 to 2 percent slopes	3.05	4.0%		llw	94	79	77	59	79
37B	Farrar fine sandy loam, 1 to 6 percent slopes	2.39	3.1%		lle	99	77	77	54	63
1877	Fostoria loam	1.12	1.5%		I	100	84	80	61	84
Weighted Average					2.30	87.9	*n 75.4	*n 70.4	*n 53	*n 73.9

*n: The aggregation method is "Weighted Average using all components"

*c: Using Capabilities Class Dominant Condition Aggregation Method

Soils data provided by USDA and NRCS.