

FEMA Report

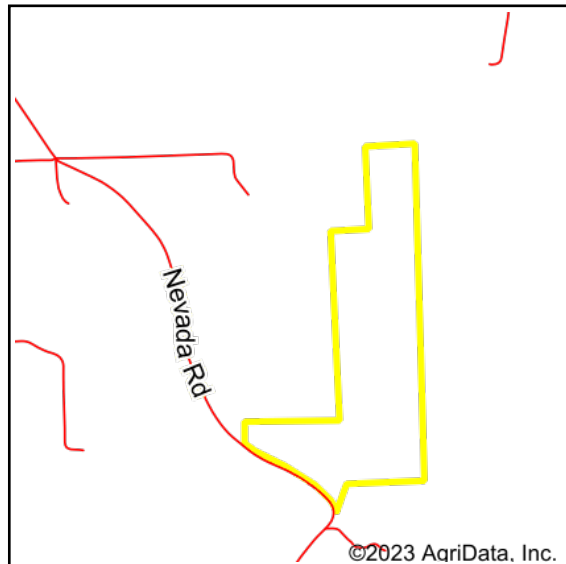

Map Center: 43° 45' 33.29, -90° 40' 23.52
 State: WI Acres: 150.69
 County: Monroe Date: 2/22/2023
 Location: 24-15N-3W
 Township: Jefferson

Maps Provided By:

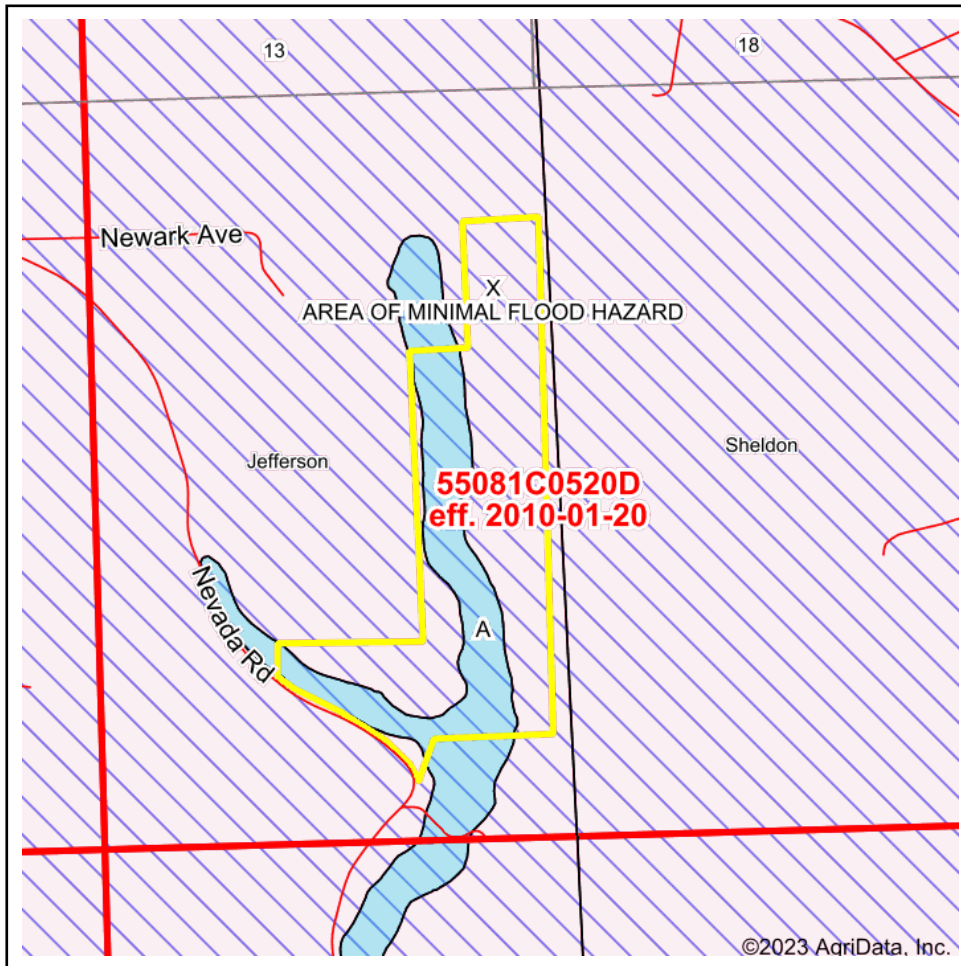

HIGH POINT
LAND COMPANY



surety
CUSTOMIZED ONLINE MAPPING

© AgriData, Inc. 2021 www.AgriDataInc.com



Name	Number	County	NFIP Participation	Acres	Percent
Monroe County	550571	Monroe	Regular	150.69	100%
Total				150.69	100%

Map Change	Date	Case No.	Acres	Percent
No			0	0%

Zone	SubType	Description	Acres	Percent
X	AREA OF MINIMAL FLOOD HAZARD	Outside 500-year Floodplain	101.15	67.1%
A		100-year Floodplain	49.54	32.9%
Total			150.69	100%

Panel	Effective Date	Acres	Percent
55081C0520D	1/20/2010	150.69	100%
Total		150.69	100%