

Soils Map

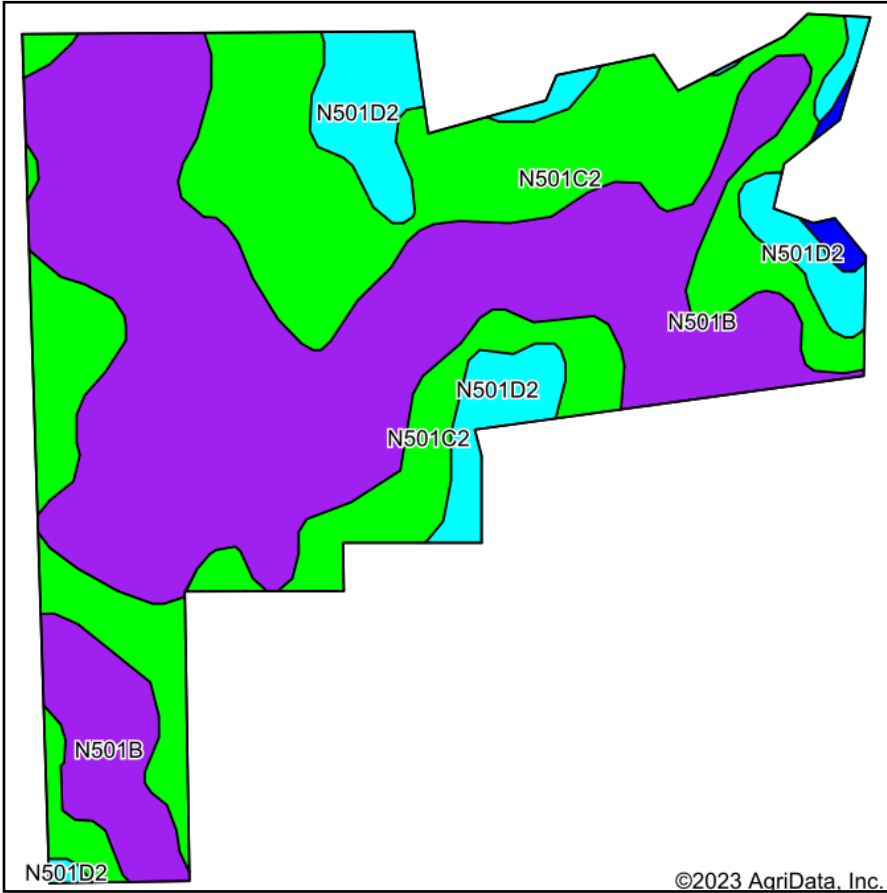

Soils data provided by USDA and NRCS.

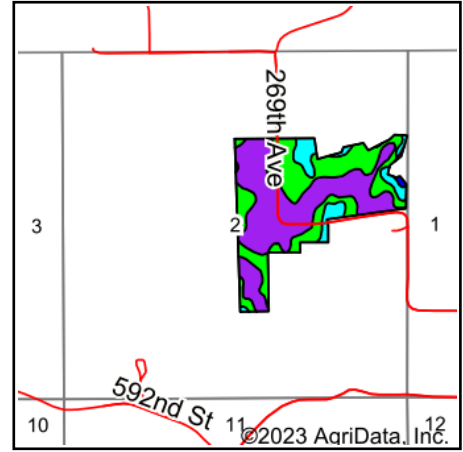

State: **Minnesota**
 County: **Wabasha**
 Location: **2-109N-12W**
 Township: **Oakwood**
 Acres: **88.68**
 Date: **5/30/2023**



Maps Provided By:



© AgriData, Inc. 2023

www.AgriDataInc.com



Area Symbol: MN157, Soil Area Version: 19

Code	Soil Description	Acres	Percent of field	PI Legend	Non-Irr Class *c	Productivity Index	*n NCCPI Overall	*n NCCPI Corn	*n NCCPI Small Grains	*n NCCPI Soybeans
N501B	Downs silt loam, 2 to 6 percent slopes	45.47	51.3%		Ile	90	90	90	77	82
N501C2	Downs silt loam, 6 to 12 percent slopes, moderately eroded	34.20	38.6%		IIle	80	84	84	70	71
N501D2	Downs silt loam, 12 to 18 percent slopes, moderately eroded	8.50	9.6%		IVe	69	77	77	65	64
DnD2	Dubuque silt loam, 12 to 18 percent slopes, moderately eroded	0.51	0.6%		IVe	39	48	48	42	31
Weighted Average					2.59	83.8	*n 86.2	*n 86.2	*n 72.9	*n 75.7

*n: The aggregation method is "Weighted Average using all components"

*c: Using Capabilities Class Dominant Condition Aggregation Method

Soils data provided by USDA and NRCS.