

Soils Map

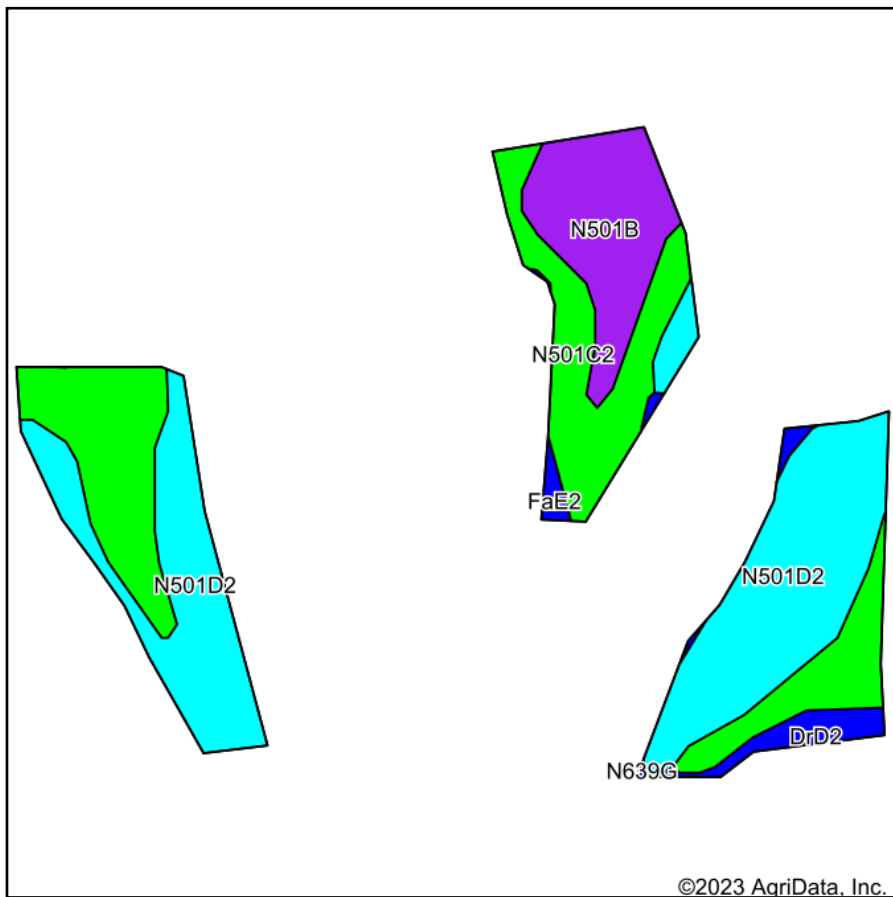

Soils data provided by USDA and NRCS.

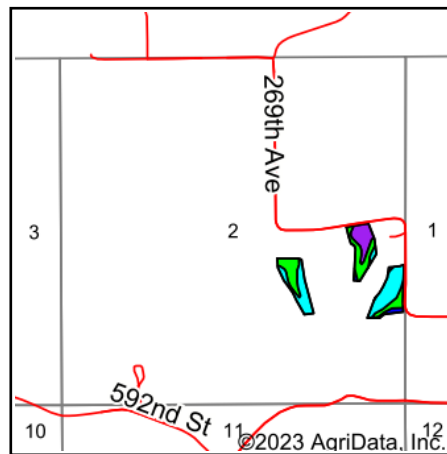

State: **Minnesota**
 County: **Wabasha**
 Location: **2-109N-12W**
 Township: **Oakwood**
 Acres: **17**
 Date: **5/30/2023**



HIGH POINT
 LAND COMPANY

Maps Provided By:



© AgriData, Inc. 2023

www.AgriDataInc.com



Area Symbol: MN157, Soil Area Version: 19

Code	Soil Description	Acres	Percent of field	PI Legend	Non-Irr Class *c	Productivity Index	*n NCCPI Overall	*n NCCPI Corn	*n NCCPI Small Grains	*n NCCPI Soybeans
N501D2	Downs silt loam, 12 to 18 percent slopes, moderately eroded	7.46	43.9%		IVe	69	77	77	65	64
N501C2	Downs silt loam, 6 to 12 percent slopes, moderately eroded	6.20	36.5%		IIIe	80	84	84	70	71
N501B	Downs silt loam, 2 to 6 percent slopes	2.55	15.0%		Ile	90	90	90	77	82
DrD2	Dubuque silt loam, shallow, 12 to 18 percent slopes, moderately eroded	0.52	3.1%		VIe	28	44	44	37	23
FaE2	Fayette silt loam, 18 to 35 percent slopes, moderately eroded	0.27	1.6%		VIe	27	19	19	16	9
Weighted Average						3.43	*n 79.6	*n 79.6	*n 67	*n 67.1

*n: The aggregation method is "Weighted Average using all components"

*c: Using Capabilities Class Dominant Condition Aggregation Method

Soils data provided by USDA and NRCS.