

# Soils Map

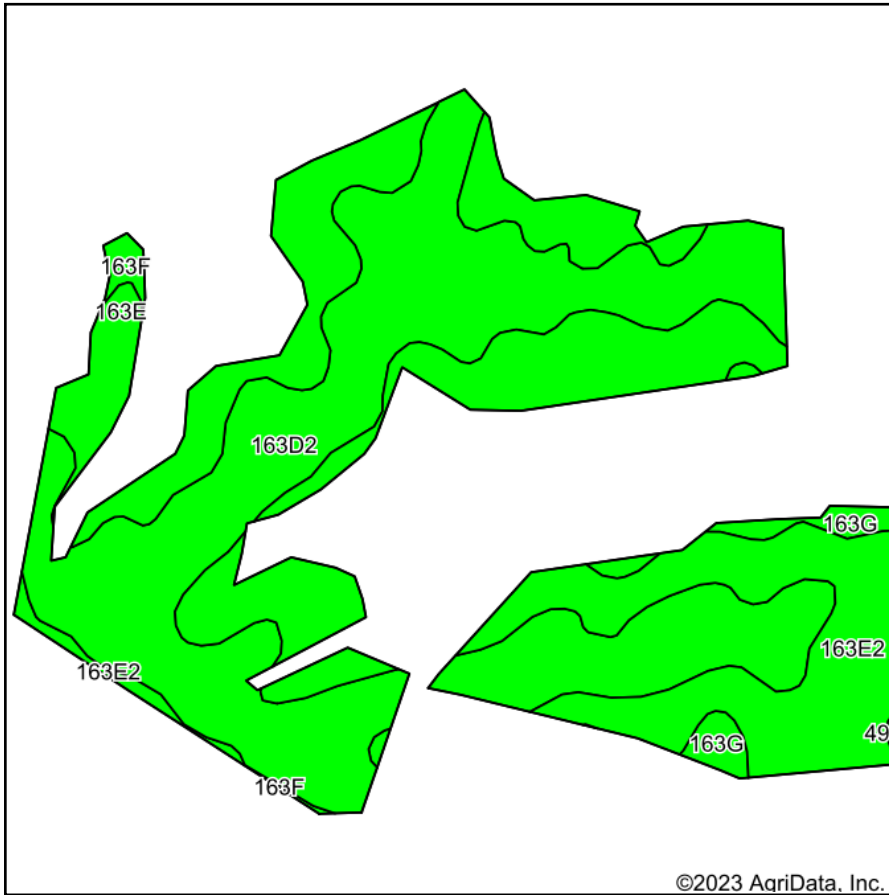

Soils data provided by USDA and NRCS.

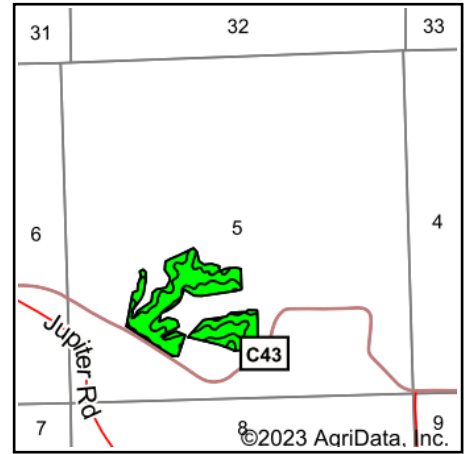

State: **Iowa**  
 County: **Clayton**  
 Location: **5-91N-3W**  
 Township: **Mallory**  
 Acres: **36.57**  
 Date: **9/28/2023**



Maps Provided By:



Area Symbol: IA043, Soil Area Version: 26

Code	Soil Description	Acres	Percent of field	CSR2 Legend	Non-Irr Class *c	CSR2**	CSR	*n NCCPI Overall	*n NCCPI Corn	*n NCCPI Small Grains	*n NCCPI Soybeans	
163D2	Fayette silt loam, 9 to 14 percent slopes, moderately eroded	18.04	49.3%		IIle	46	58	78	78	66	62	
163E2	Fayette silt loam, 14 to 18 percent slopes, moderately eroded	11.68	31.9%		IVe	35	48	74	74	61	58	
163E	Fayette silt loam, 14 to 18 percent slopes	5.64	15.4%		IVe	38	50	78	78	66	65	
163G	Fayette silt loam, 25 to 40 percent slopes	0.95	2.6%		VIIe	5	20	20	20	17	10	
163F	Fayette silt loam, 18 to 25 percent slopes	0.26	0.7%		Vle	21	30	62	62	43	48	
<b>Weighted Average</b>						<b>3.60</b>	<b>40</b>	<b>52.4</b>	<b>*n 75.1</b>	<b>*n 75.1</b>	<b>*n 63</b>	<b>*n 59.7</b>

\*\*IA has updated the CSR values for each county to CSR2.

\*n: The aggregation method is "Weighted Average using all components"

\*c: Using Capabilities Class Dominant Condition Aggregation Method

Soils data provided by USDA and NRCS.