

Soils Map

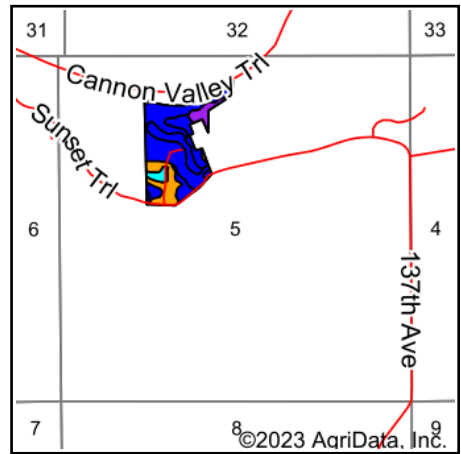

State: **Minnesota**
 County: **Goodhue**
 Location: **5-112N-16W**
 Township: **Vasa**
 Acres: **30.94**
 Date: **5/4/2023**

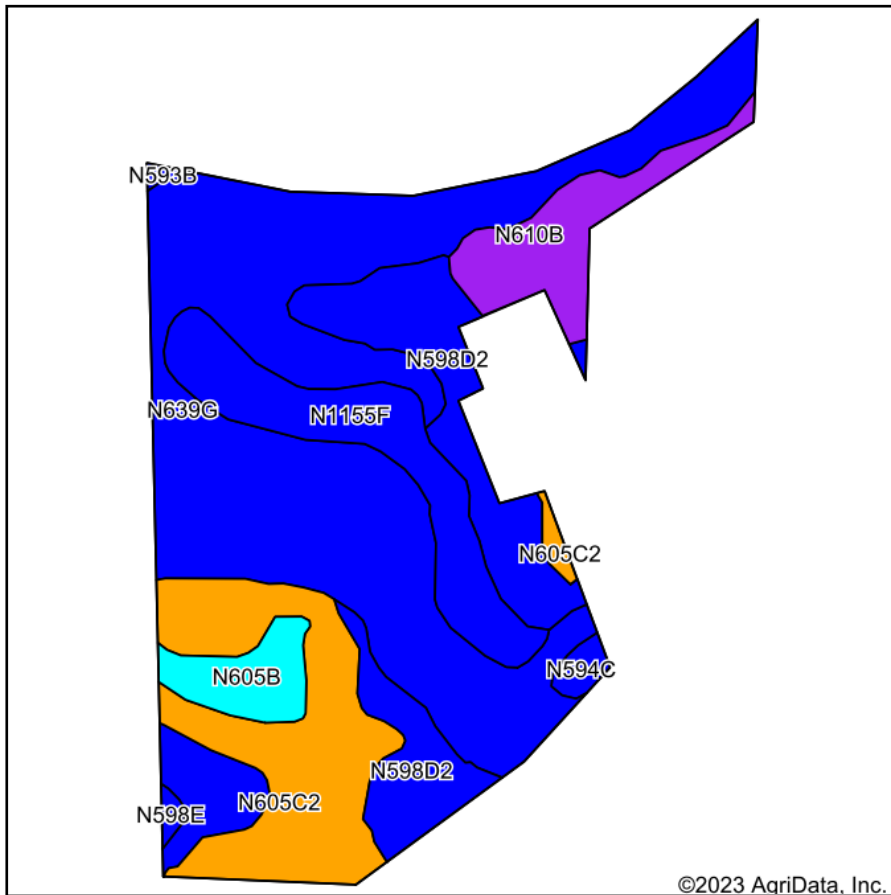

Maps Provided By:



Soils data provided by USDA and NRCS.

©2023 AgriData, Inc.

© AgriData, Inc. 2023

www.AgriDataInc.com

Area Symbol: MN049, Soil Area Version: 18

Code	Soil Description	Acres	Percent of field	PI Legend	Non-Irr Class *c	Productivity Index	*n NCCPI Overall	*n NCCPI Corn	*n NCCPI Small Grains	*n NCCPI Soybeans	
N639G	Frontenac-Lacrescent complex, 30 to 70 percent slopes, rocky	13.86	44.8%		Vlle	4	16	16	13	8	
N605C2	Rasset sandy loam, strath terrace, 6 to 12 percent slopes, moderately eroded	4.88	15.8%		IIle	53	50	50	45	27	
N598D2	Winneshiek-Waucoma complex, 12 to 18 percent slopes, moderately eroded	4.48	14.5%		IVe	45	52	52	45	38	
N1155F	Brodale-Bellechester complex, 30 to 60 percent slopes, rocky	3.22	10.4%		Vlls	4	6	6	2	1	
N610B	Waucoma loam, 2 to 6 percent slopes	1.99	6.4%		Ile	89	74	74	66	66	
N605B	Rasset sandy loam, strath terrace, 2 to 6 percent slopes	1.11	3.6%		IIIs	61	53	53	50	29	
N594E	Chelsea loamy sand, 12 to 35 percent slopes	0.98	3.2%		Vlls	23	25	25	22	21	
N594C	Chelsea loamy sand, 6 to 12 percent slopes	0.25	0.8%		IVs	45	33	32	32	28	
N598E	Winneshiek-Waucoma complex, 18 to 35 percent slopes	0.10	0.3%		Vle	24	43	43	31	31	
N593B	Sparta loamy sand, 0 to 6 percent slopes	0.07	0.2%		IVs	39	30	30	30	27	
Weighted Average						5.44	26.3	*n 31.1	*n 31.1	*n 26.8	*n 19.8

*n: The aggregation method is "Weighted Average using all components"

*c: Using Capabilities Class Dominant Condition Aggregation Method

Soils data provided by USDA and NRCS.