

Soils Map

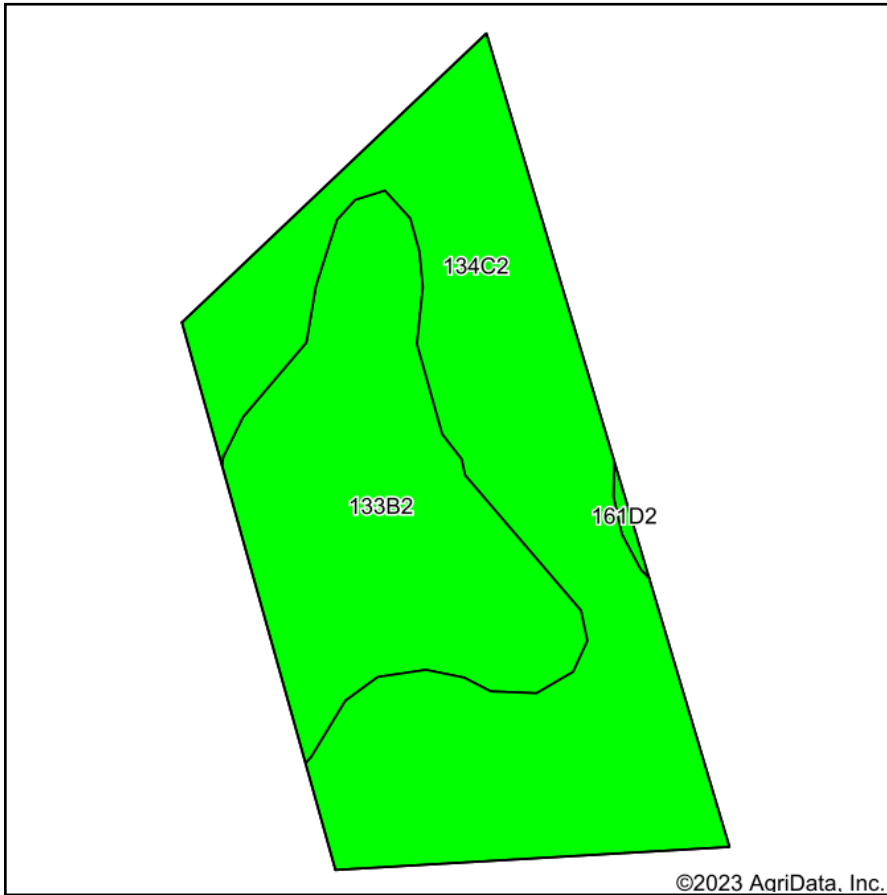

Soils data provided by USDA and NRCS.

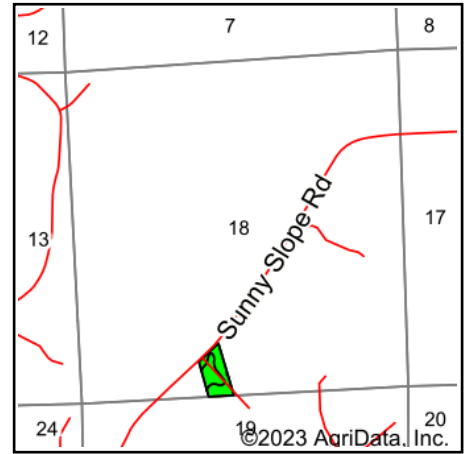

State: **Wisconsin**
 County: **Richland**
 Location: **18-12N-2E**
 Township: **Westford**
 Acres: **6.25**
 Date: **5/11/2023**



Maps Provided By:



© AgriData, Inc. 2023

www.AgriDataInc.com



Area Symbol: WI103, Soil Area Version: 18

Code	Soil Description	Acres	Percent of field	Non-Irr Class Legend	Non-Irr Class *c	Corn Bu	Soybeans Bu	*n NCCPI Overall	*n NCCPI Corn	*n NCCPI Small Grains	*n NCCPI Soybeans
134C2	Lamoille silt loam, 6 to 12 percent slopes, moderately eroded	3.91	62.6%		IVe			64	64	58	64
133B2	Valton silt loam, 2 to 6 percent slopes, moderately eroded	2.34	37.4%		Ile	4	1	72	72	67	70
Weighted Average					3.25	1.5	0.4	*n 67	*n 67	*n 61.4	*n 66.2

*n: The aggregation method is "Weighted Average using all components"

*c: Using Capabilities Class Dominant Condition Aggregation Method

Soils data provided by USDA and NRCS.