

# Soils Map

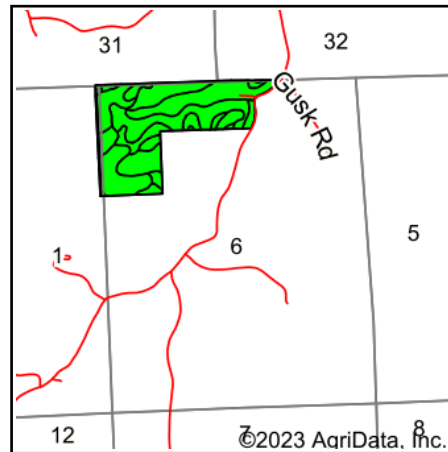

State: **Wisconsin**  
 County: **Jackson**  
 Location: **6-20N-6W**  
 Township: **Franklin**  
 Acres: **98.41**  
 Date: **2/14/2023**

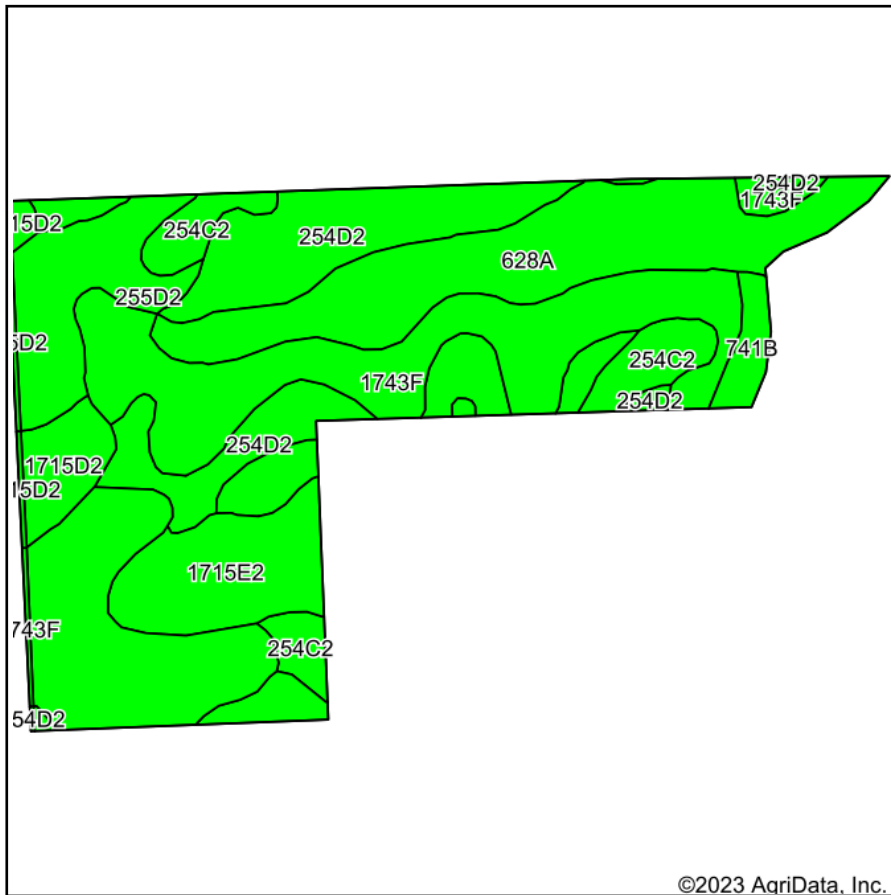

Maps Provided By:



Soils data provided by USDA and NRCS.

©2023 AgriData, Inc.

© AgriData, Inc. 2021

www.AgriDataInc.com

Area Symbol: WI053, Soil Area Version: 21  
 Area Symbol: WI121, Soil Area Version: 15

Code	Soil Description	Acres	Percent of field	Non-Irr Class Legend	Non-Irr Class *c	Corn Bu	Soybeans Bu	*n NCCPI Overall	*n NCCPI Corn	*n NCCPI Small Grains	*n NCCPI Soybeans
1743F	Council-Elevasil-Norden complex, 20 to 45 percent slopes, rocky	32.59	33.1%		Vlls			13	13	11	6
628A	Orion silt loam, 0 to 3 percent slopes, occasionally flooded	17.92	18.2%		llw			89	79	54	89
254D2	Norden silt loam, 12 to 20 percent slopes, moderately eroded	17.45	17.7%		IVe			56	56	49	46
1715E2	Council and Seaton soils, 20 to 30 percent slopes, moderately eroded	9.33	9.5%		Vle			53	53	35	41
254C2	Norden silt loam, 6 to 12 percent slopes, moderately eroded	7.62	7.7%		llle			61	61	54	53
255D2	Urne fine sandy loam, 12 to 20 percent slopes, moderately eroded	7.52	7.6%		IVe	65	20	49	49	40	36
1715D2	Council and Seaton soils, 12 to 20 percent slopes, moderately eroded	3.50	3.6%		IVe	115	37	69	69	57	59
741B	Sebbo loam, 1 to 6 percent slopes	1.67	1.7%		lle	150	50	76	76	66	65
255D2	Urne fine sandy loam, 12 to 20 percent slopes, moderately eroded	0.29	0.3%		IVe	65	20	49	49	40	36
1715D2	Council and Seaton soils, 12 to 20 percent slopes, moderately eroded	0.28	0.3%		IVe	115	37	69	69	57	59
1743F	Council-Elevasil-Norden complex, 20 to 45 percent slopes, rocky	0.24	0.2%		Vlls			13	13	11	6
<b>Weighted Average</b>					<b>4.71</b>	<b>12.1</b>	<b>3.9</b>	<b>*n 48.1</b>	<b>*n 46.2</b>	<b>*n 36.2</b>	<b>*n 40.6</b>

\*n: The aggregation method is "Weighted Average using all components"

\*c: Using Capabilities Class Dominant Condition Aggregation Method

Soils data provided by USDA and NRCS.