

Soils Map

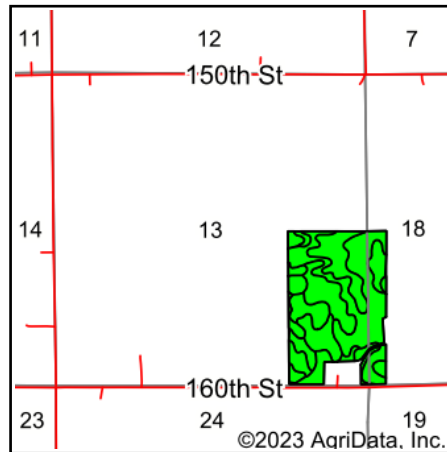

State: **Iowa**
 County: **Chickasaw**
 Location: **13-96N-14W**
 Township: **Deerfield**
 Acres: **91.82**
 Date: **2/21/2023**

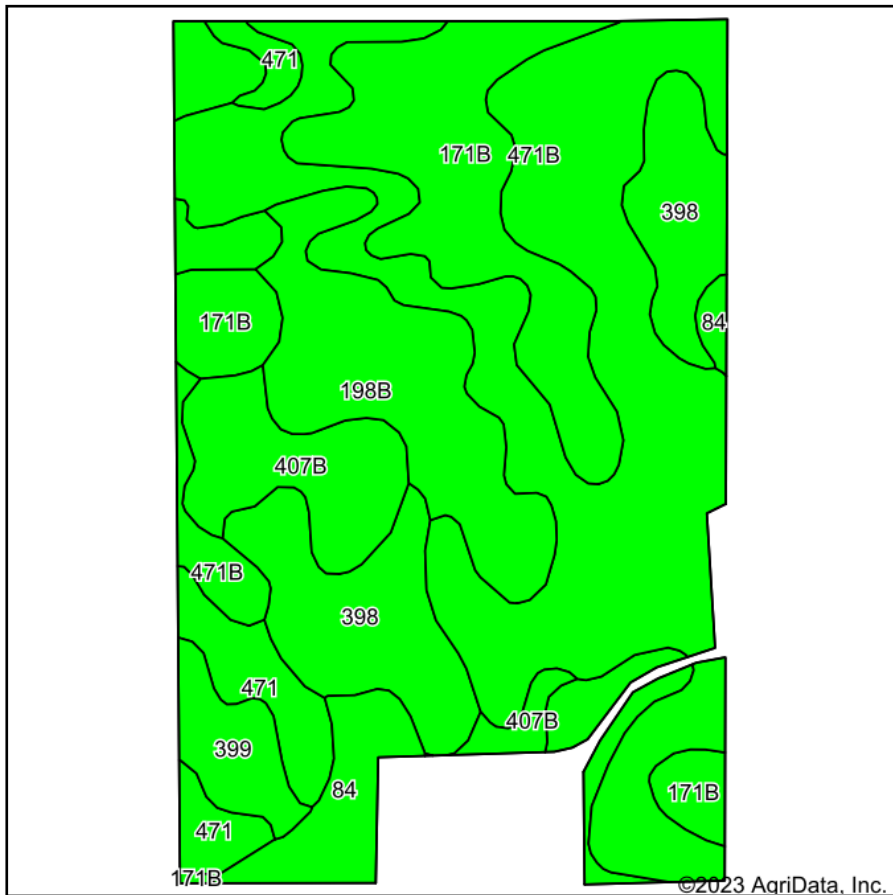

Maps Provided By:



Soils data provided by USDA and NRCS.

Area Symbol: IA037, Soil Area Version: 28

Code	Soil Description	Acres	Percent of field	CSR2 Legend	Non-Irr Class *c	CSR2**	CSR	Corn Bu	Soybeans Bu	*n NCCPI Overall	*n NCCPI Corn	*n NCCPI Small Grains	*n NCCPI Soybeans	
471B	Oran loam, 2 to 5 percent slopes	34.44	37.5%		Iw	74	79			77	77	52	57	
171B	Bassett loam, 2 to 5 percent slopes	14.35	15.6%		Ile	85	79	215	62	85	85	68	73	
398	Tripoli clay loam, 0 to 2 percent slopes	11.00	12.0%		IIw	82	79			67	67	44	62	
198B	Floyd loam, 1 to 4 percent slopes	10.08	11.0%		IIw	89	74			88	83	63	88	
84	Clyde clay loam, 0 to 3 percent slopes	8.17	8.9%		IIw	88	74			90	90	75	85	
407B	Schley loam, 1 to 4 percent slopes	6.29	6.9%		IIw	81	69			94	94	79	85	
471	Oran loam, 0 to 2 percent slopes	4.80	5.2%		Iw	79	84			78	78	52	58	
399	Readlyn silt loam, 1 to 3 percent slopes	2.69	2.9%		Iw	91	89			79	79	54	65	
Weighted Average						1.54	80.8	77.9	33.6	9.7	*n 80.7	*n 80.1	*n 58.7	*n 68.2

**IA has updated the CSR values for each county to CSR2.

*n: The aggregation method is "Weighted Average using all components"

*c: Using Capabilities Class Dominant Condition Aggregation Method

Soils data provided by USDA and NRCS.