

Soils Map

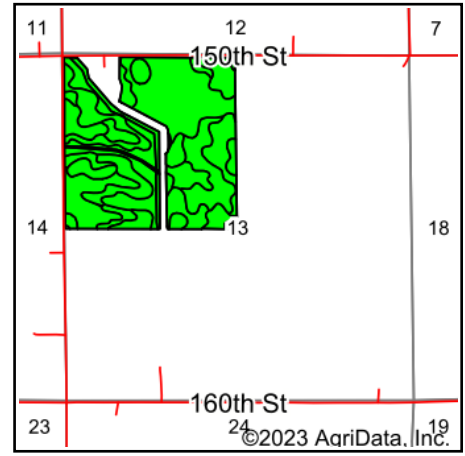

State: **Iowa**
 County: **Chickasaw**
 Location: **13-96N-14W**
 Township: **Deerfield**
 Acres: **144.21**
 Date: **2/9/2023**

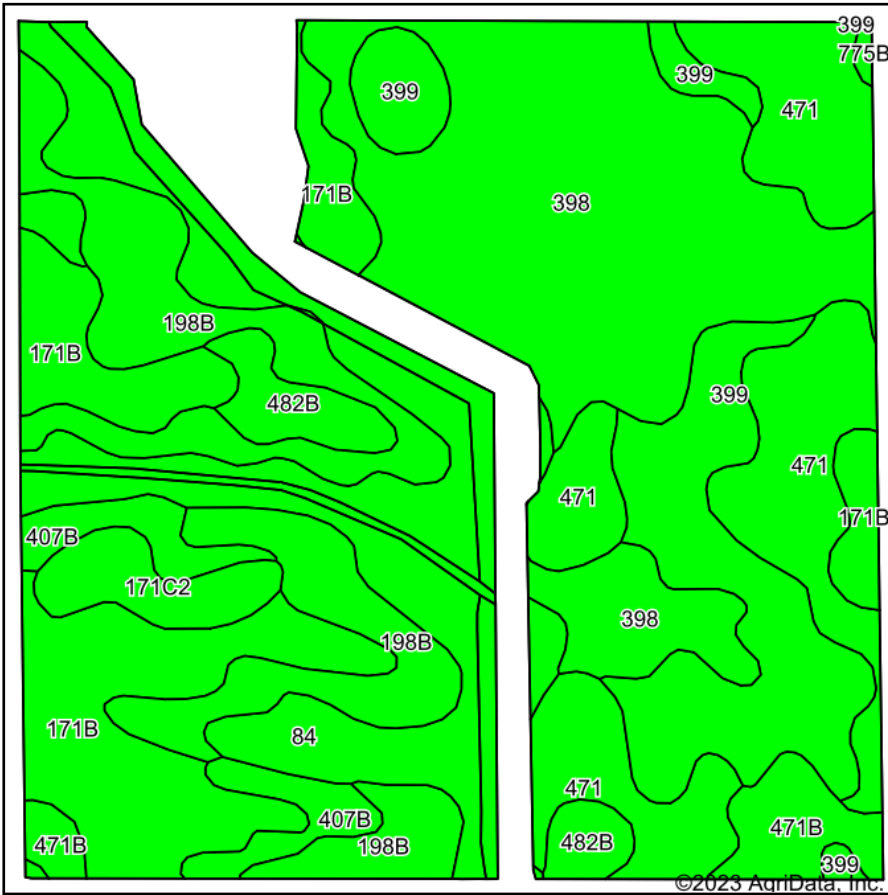

Maps Provided By:



© AgriData, Inc. 2021

www.AgriDataInc.com



Soils data provided by USDA and NRCS.

Area Symbol: IA037, Soil Area Version: 28

Code	Soil Description	Acres	Percent of field	CSR2 Legend	Non-Irr Class *c	CSR2**	CSR	Corn Bu	Soybeans Bu	*n NCCPI Overall	*n NCCPI Corn	*n NCCPI Small Grains	*n NCCPI Soybeans	
398	Tripoli clay loam, 0 to 2 percent slopes	32.64	22.6%		llw	82	79			67	67	44	62	
84	Clyde clay loam, 0 to 3 percent slopes	21.69	15.0%		llw	88	74			90	90	75	85	
471	Oran loam, 0 to 2 percent slopes	20.22	14.0%		lw	79	84			78	78	52	58	
171B	Bassett loam, 2 to 5 percent slopes	19.28	13.4%		lle	85	79	215	62	85	85	68	73	
198B	Floyd loam, 1 to 4 percent slopes	18.77	13.0%		llw	89	74			88	83	63	88	
399	Readlyn silt loam, 1 to 3 percent slopes	15.92	11.0%		lw	91	89			79	79	54	65	
471B	Oran loam, 2 to 5 percent slopes	4.41	3.1%		lw	74	79			77	77	52	57	
407B	Schley loam, 1 to 4 percent slopes	4.21	2.9%		llw	81	69			94	94	79	85	
482B	Racine loam, 2 to 5 percent slopes	3.71	2.6%		lle	76	79			65	65	46	55	
171C2	Bassett loam, 5 to 9 percent slopes, eroded	3.16	2.2%		llle	77	62	174	50	79	79	61	63	
775B	Billet sandy loam, 2 to 5 percent slopes	0.20	0.1%		llls	67	50			60	60	55	40	
Weighted Average						1.74	84.2	78.7	32.6	9.4	*n 79.8	*n 79.1	*n 58.3	*n 70.4

**IA has updated the CSR values for each county to CSR2.

*n: The aggregation method is "Weighted Average using all components"

*c: Using Capabilities Class Dominant Condition Aggregation Method

Soils data provided by USDA and NRCS.