

Soils Map

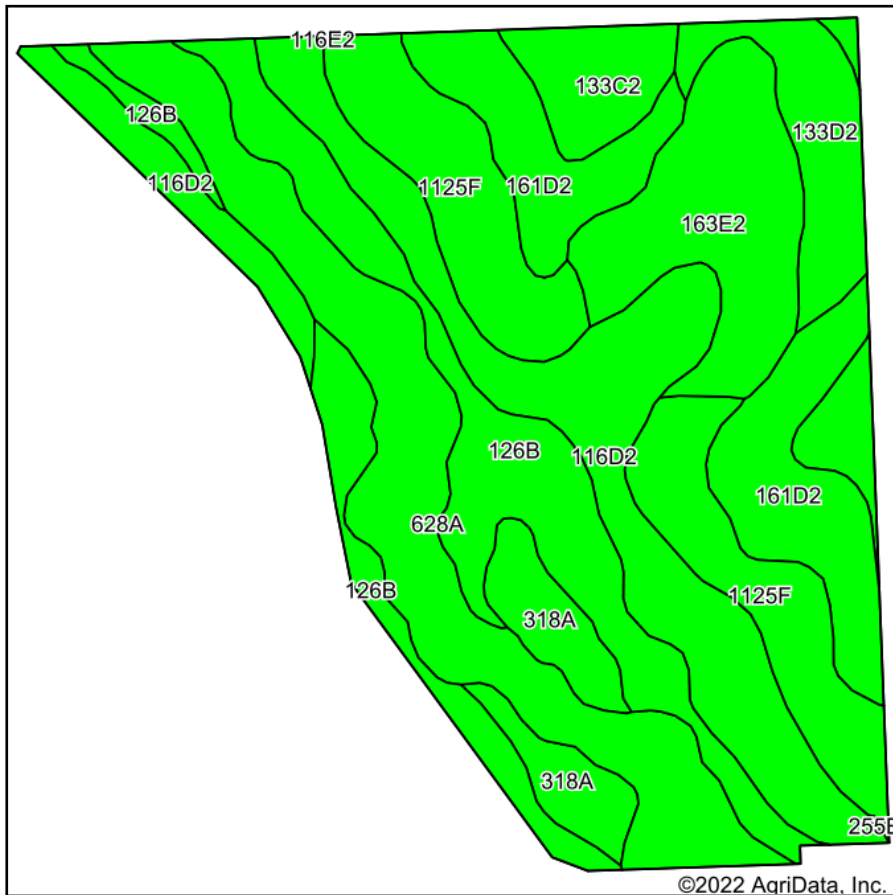

Soils data provided by USDA and NRCS.

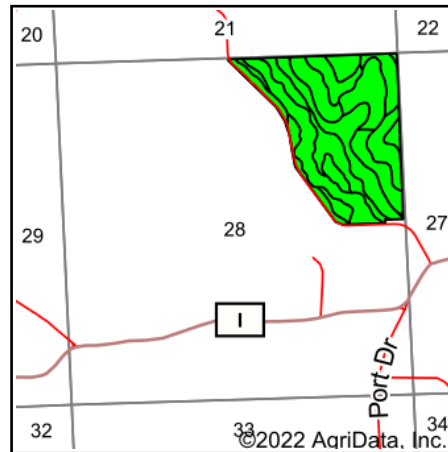

State: **Wisconsin**
 County: **Richland**
 Location: **28-12N-1W**
 Township: **Bloom**
 Acres: **102.99**
 Date: **11/25/2022**



Maps Provided By:



© AgriData, Inc. 2021

www.AgriDataInc.com



Area Symbol: WI103, Soil Area Version: 18

| Code | Soil Description | Acres | Percent of field | Non-Irr Class Legend | Non-Irr Class *c | Corn Bu | Soybeans Bu | *n NCCPI Overall | *n NCCPI Corn | *n NCCPI Small Grains | *n NCCPI Soybeans |
|-------------------------|--|-------|------------------|----------------------|------------------|---------|-------------|------------------|---------------|-----------------------|-------------------|
| 116D2 | Churchtown silt loam, 12 to 20 percent slopes, moderately eroded | 18.30 | 17.8% | | IVe | | | 75 | 75 | 62 | 67 |
| 628A | Orion silt loam, 0 to 3 percent slopes, occasionally flooded | 16.51 | 16.0% | | IIw | | | 89 | 79 | 54 | 89 |
| 126B | Barremills silt loam, 1 to 6 percent slopes | 16.44 | 16.0% | | Ie | 150 | 54 | 91 | 91 | 79 | 90 |
| 1125F | Dorerton, very stony-Elbaville complex, 30 to 60 percent slopes | 14.30 | 13.9% | | VIIe | | | 13 | 13 | 11 | 5 |
| 161D2 | Fivepoints silt loam, 12 to 20 percent slopes, moderately eroded | 12.34 | 12.0% | | VIe | | | 51 | 51 | 45 | 43 |
| 163E2 | Elbaville silt loam, 20 to 30 percent slopes, moderately eroded | 9.90 | 9.6% | | VIe | | | 17 | 17 | 15 | 10 |
| 133C2 | Valton silt loam, 6 to 12 percent slopes, moderately eroded | 5.34 | 5.2% | | IIe | | | 70 | 70 | 66 | 68 |
| 133D2 | Valton silt loam, 12 to 20 percent slopes, moderately eroded | 5.01 | 4.9% | | IIIe | | | 65 | 65 | 59 | 60 |
| 318A | Bearpen silt loam, 0 to 3 percent slopes, rarely flooded | 4.85 | 4.7% | | IIw | | | 89 | 89 | 75 | 89 |
| Weighted Average | | | | | | | | *n 62.7 | *n 61 | *n 50.5 | *n 58 |

*n: The aggregation method is "Weighted Average using all components"

*c: Using Capabilities Class Dominant Condition Aggregation Method

Soils data provided by USDA and NRCS.