

# Soils Map

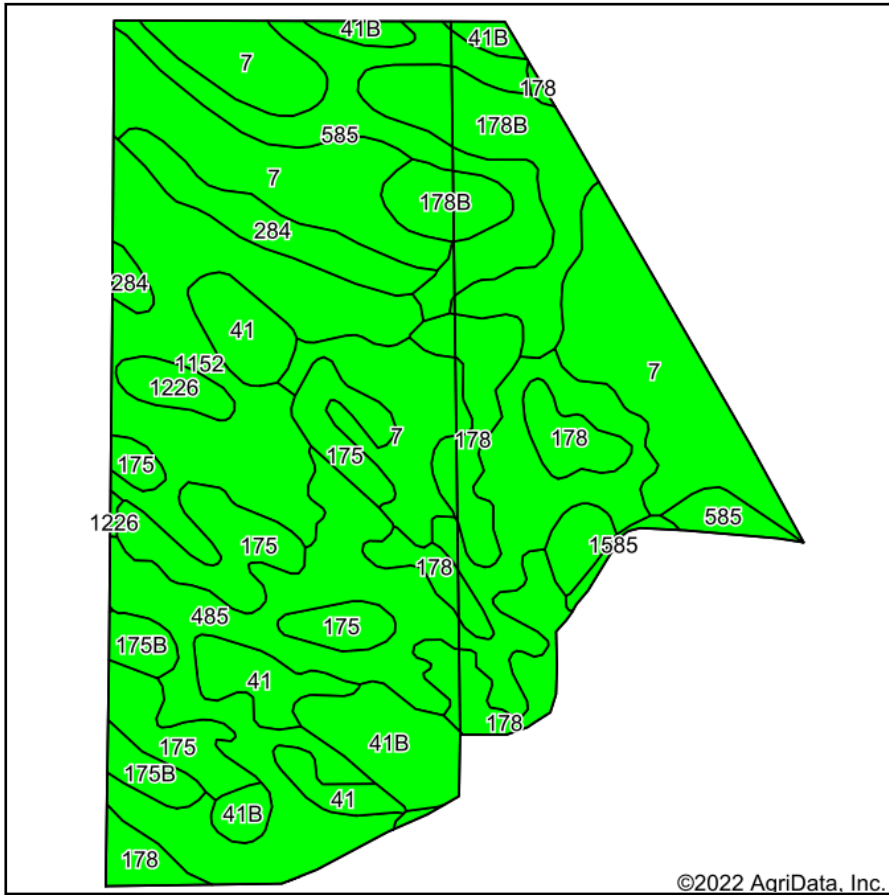

Soils data provided by USDA and NRCS.

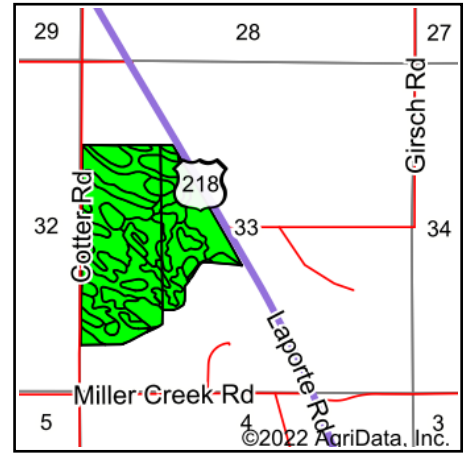

State: **Iowa**  
 County: **Black Hawk**  
 Location: **33-88N-12W**  
 Township: **Cedar**  
 Acres: **127.8**  
 Date: **7/17/2022**



**HIGH POINT**  
 LAND COMPANY

Maps Provided By:



© AgriData, Inc. 2021

www.AgriDataInc.com



Area Symbol: IA013, Soil Area Version: 29

Code	Soil Description	Acres	Percent of field	CSR2 Legend	Non-Irr Class *c	Irr Class *c	CSR2**	CSR	Corn Bu	Soybeans Bu	*n NCCPI Overall	*n NCCPI Corn	*n NCCPI Small Grains	*n NCCPI Soybeans	*n NCCPI Cotton
7	Wiota silty clay loam, 0 to 2 percent slopes	25.41	19.9%		Is		97	95			95	95	77	84	
485	Spillville loam, 0 to 2 percent slopes, occasionally flooded	24.51	19.2%		Ilw		76	92			87	87	51	74	
1152	Marshan clay loam, 0 to 2 percent slopes, rarely flooded	15.08	11.8%		Ilw		54	68	90	30	82	82	66	61	
178	Waukee loam, 0 to 2 percent slopes	11.71	9.2%		Ils		69	79			84	84	71	71	
175	Dickinson fine sandy loam, 0 to 2 percent slopes	10.39	8.1%		IIIs		55	60			65	65	55	38	
585	Coland-Spillville complex, 0 to 2 percent slopes, occasionally flooded	9.87	7.7%		Ilw		70	86			77	77	33	68	
178B	Waukee loam, 2 to 5 percent slopes	9.59	7.5%		Ils		64	74			82	82	71	69	
41	Sparta loamy fine sand, 0 to 2 percent slopes	6.96	5.4%		IVs	Ile	44	45			57	57	45	32	
41B	Sparta loamy fine sand, 2 to 5 percent slopes	5.94	4.6%		IVs	Ile	39	40			56	56	46	32	



284	Flagler sandy loam, 0 to 2 percent slopes	4.14	3.2%		Ills		55	50			61	61	49	38		
175B	Dickinson fine sandy loam, 2 to 5 percent slopes	2.20	1.7%		Ille		50	55			63	63	54	37		
1226	Lawler loam, 0 to 2 percent slopes, rarely flooded	1.48	1.2%		Ils		59	72			83	83	70	61	1	
1585	Spillville-Coland-Shandep complex, 0 to 2 percent slopes, frequently flooded	0.52	0.4%		Vw		5	5			11	6	11	2		
<b>Weighted Average</b>						<b>2.15</b>	<b>*-</b>	<b>68.8</b>	<b>76.6</b>	<b>10.6</b>	<b>3.5</b>	<b>*n 80.1</b>	<b>*n 80.1</b>	<b>*n 59.7</b>	<b>*n 63.9</b>	<b>*n *-</b>

\*\*IA has updated the CSR values for each county to CSR2.

\*n: The aggregation method is "Weighted Average using all components"

\*c: Using Capabilities Class Dominant Condition Aggregation Method

\*- Irr Class weighted average cannot be calculated on the current soils data due to missing data.

Soils data provided by USDA and NRCS.