

Soils Map

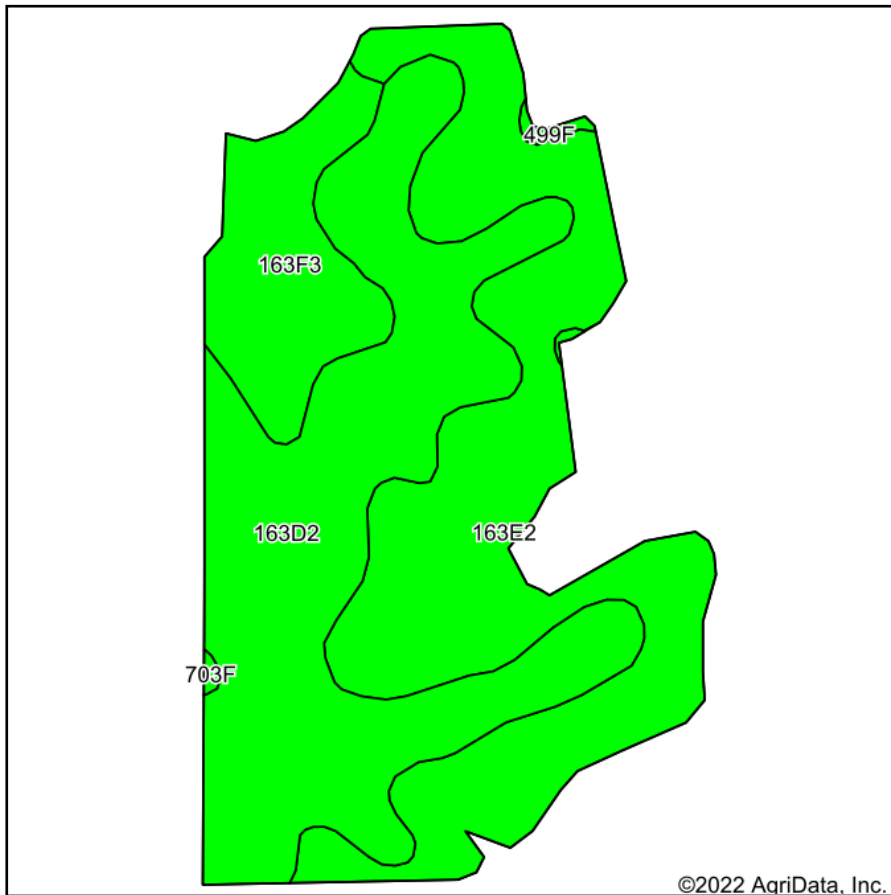

Soils data provided by USDA and NRCS.

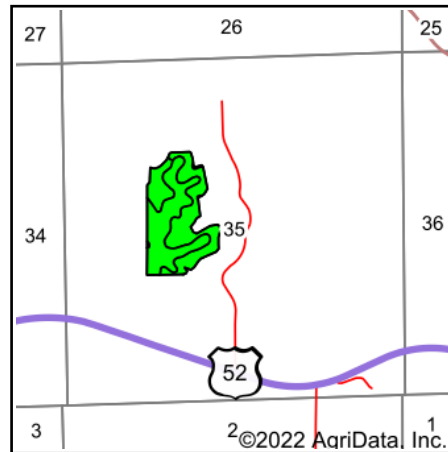

State: **Iowa**
 County: **Clayton**
 Location: **35-93N-3W**
 Township: **Jefferson**
 Acres: **36.07**
 Date: **10/18/2022**



Maps Provided By:



Area Symbol: IA043, Soil Area Version: 25

Code	Soil Description	Acres	Percent of field	CSR2 Legend	Non-Irr Class *c	CSR2**	CSR	*n NCCPI Overall	*n NCCPI Corn	*n NCCPI Small Grains	*n NCCPI Soybeans
163D2	Fayette silt loam, 9 to 14 percent slopes, moderately eroded	16.07	44.6%		IIle	46	58	80	80	67	64
163E2	Fayette silt loam, 14 to 18 percent slopes, moderately eroded	15.24	42.3%		IVe	35	48	76	76	62	59
163F3	Fayette silty clay loam, 18 to 25 percent slopes, severely eroded	4.53	12.6%		VIIe	12	25	57	57	37	37
499F	Nordness silt loam, 14 to 25 percent slopes	0.17	0.5%		VIIIs	5	5	42	42	33	27
703F	Dubuque silt loam, 18 to 25 percent slopes	0.06	0.2%		VIe	6		42	42	35	30
Weighted Average						3.95	36.8	*n 75.2	*n 75.2	*n 60.9	*n 58.3

**IA has updated the CSR values for each county to CSR2.

*- CSR weighted average cannot be calculated on the current soils data, use prior data version for csr values.

*n: The aggregation method is "Weighted Average using all components"

*c: Using Capabilities Class Dominant Condition Aggregation Method

Soils data provided by USDA and NRCS.