

# Soils Map

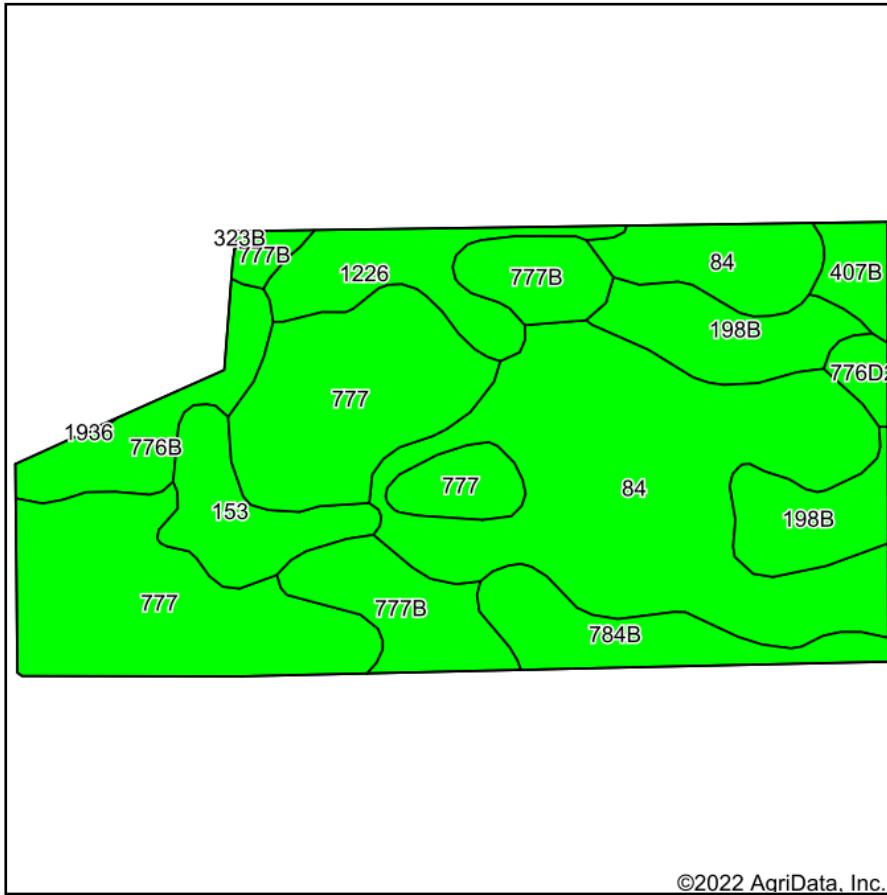

Soils data provided by USDA and NRCS.

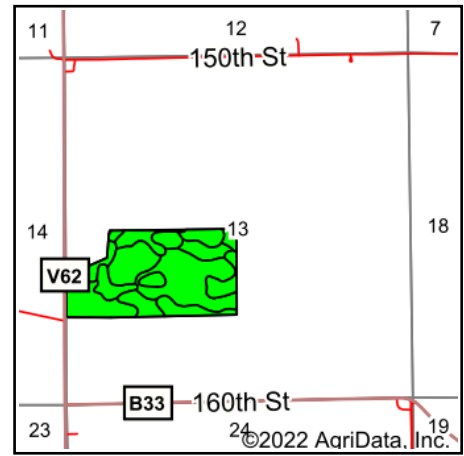

State: **Iowa**  
 County: **Chickasaw**  
 Location: **13-96N-11W**  
 Township: **Utica**  
 Acres: **72**  
 Date: **10/19/2022**



Maps Provided By:



Area Symbol: IA037, Soil Area Version: 27

Code	Soil Description	Acres	Percent of field	CSR2 Legend	Non-Irr Class *c	CSR2**	CSR	*n NCCPI Overall	*n NCCPI Corn	*n NCCPI Small Grains	*n NCCPI Soybeans	*n NCCPI Cotton
84	Clyde clay loam, 0 to 3 percent slopes	22.91	31.8%		IIw	88	74	90	90	75	85	
777	Wapsie loam, 0 to 2 percent slopes	19.21	26.7%		IIs	55	57	69	69	65	45	
198B	Floyd loam, 1 to 4 percent slopes	6.48	9.0%		IIw	89	74	85	81	63	85	
777B	Wapsie loam, 2 to 5 percent slopes	6.47	9.0%		Ile	50	52	68	68	65	44	
784B	Riceville loam, 1 to 4 percent slopes	3.98	5.5%		Ile	68	51	77	77	69	73	
1226	Lawler loam, 0 to 2 percent slopes, rarely flooded	3.86	5.4%		IIs	59	71	83	83	70	61	1
153	Shandep clay loam, 0 to 1 percent slopes	3.53	4.9%		IIIw	50	25	84	73	32	84	
776B	Lilah sandy loam, 2 to 5 percent slopes	3.43	4.8%		IVs	5	28	44	43	44	25	
407B	Schley loam, 1 to 4 percent slopes	1.35	1.9%		IIw	81	69	95	95	79	86	
776D2	Lilah sandy loam, 5 to 14 percent slopes, moderately eroded	0.78	1.1%		VIIs	5	5	40	40	38	21	
Weighted Average					2.19	66.4	60.6	*n 77.9	*n 77	*n 65.8	*n 65.1	*n 0.1

\*\*IA has updated the CSR values for each county to CSR2.

\*n: The aggregation method is "Weighted Average using all components"

\*c: Using Capabilities Class Dominant Condition Aggregation Method

Soils data provided by USDA and NRCS.