

Iowa
Dubuque

U.S. Department of Agriculture
Farm Service Agency
Abbreviated 156 Farm Record

FARM: 4739
Prepared: 7/1/22 7:12 AM
Crop Year: 2022
Page: 1 of 2

Report ID: FSA-156EZ

DISCLAIMER: This is data extracted from the web farm database. Because of potential messaging failures in MIDAS, this data is not guaranteed to be an accurate and complete representation of data contained in the MIDAS system, which is the system of record for Farm Records.

Operator Name Farm Identifier

Farms Associated with Operator:

908, 2602, 4465, 4738, 4813, 4814, 4844, 5782, 5783, 5837, 5838, 6895

ARC/PLC G//F Eligibility: Eligible

CRP Contract Number(s): 10185B, 10184B

Farmland	Cropland	DCP Cropland	WBP	WRP	EWP	CRP Cropland	GRP	Farm Status	Number of Tracts
130.35	127.44	127.44	0.0	0.0	0.0	7.27	0.0	Active	2
State Conservation	Other Conservation	Effective DCP Cropland	Double Cropped	MPL/FWP	Native Sod				
0.0	0.0	120.17	0.0	0.0	0.0				

ARC/PLC

PLC	ARC-CO	ARC-IC	PLC-Default	ARC-CO-Default	ARC-IC-Default
NONE	OATS , CORN	NONE	NONE	NONE	NONE

Crop	Base Acreage	PLC Yield	CCC-505 CRP Reduction
OATS	13.1	60	0.00
CORN	84.3	206	0.00
Total Base Acres:	97.4		

Tract Number: 10441 Description Concord 30

FSA Physical Location : Dubuque, IA ANSI Physical Location: Dubuque, IA

BIA Range Unit Number:

HEL Status: HEL: conservation system is being actively applied

Wetland Status: Wetland determinations not complete

WL Violations: None

Farmland	Cropland	DCP Cropland	WBP	WRP	EWP	CRP Cropland	GRP
16.05	15.52	15.52	0.0	0.0	0.0	0.87	0.0
State Conservation	Other Conservation	Effective DCP Cropland	Double Cropped	MPL/FWP	Native Sod		
0.0	0.0	14.65	0.0	0.0	0.0		

Crop	Base Acreage	PLC Yield	CCC-505 CRP Reduction
OATS	1.7	60	0.00
CORN	10.8	206	0.00
Total Base Acres:	12.5		

Owners: PAUL AND MARY KLUESNER IRREVOCABLE TRUST

Iowa
Dubuque

U.S. Department of Agriculture
Farm Service Agency
Abbreviated 156 Farm Record

FARM: 4739
Prepared: 7/1/22 7:12 AM
Crop Year: 2022
Page: 2 of 2

Report ID: FSA-156EZ

DISCLAIMER: This is data extracted from the web farm database. Because of potential messaging failures in MIDAS, this data is not guaranteed to be an accurate and complete representation of data contained in the MIDAS system, which is the system of record for Farm Records.

Other Producers: None

Tract Number: 10442 Description Concord 30

FSA Physical Location : Dubuque, IA ANSI Physical Location: Dubuque, IA

BIA Range Unit Number:

HEL Status: HEL: conservation system is being actively applied

Wetland Status: Wetland determinations not complete

WL Violations: None

Farmland	Cropland	DCP Cropland	WBP	WRP	EWP	CRP Cropland	GRP
114.3	111.92	111.92	0.0	0.0	0.0	6.4	0.0
State Conservation	Other Conservation	Effective DCP Cropland	Double Cropped	MPL/FWP	Native Sod		
0.0	0.0	105.52	0.0	0.0	0.0		

Crop	Base Acreage	PLC Yield	CCC-505 CRP Reduction
OATS	11.4	60	0.00
CORN	73.5	206	0.00
Total Base Acres:	84.9		

Owners: PAUL AND MARY KLUESNER IRREVOCABLE TRUST

Other Producers: None

CRP-1 (10-22-15)	U.S. DEPARTMENT OF AGRICULTURE Commodity Credit Corporation	1. ST. & CO CODE & ADMIN. LOCATION 19 061	2. SIGN-UP NUMBER 44
		3. CONTRACT NUMBER 10184B	4. ACRES FOR ENROLLMENT 0.87
CONSERVATION RESERVE PROGRAM CONTRACT		5. FARM NUMBER 4739	6. TRACT NUMBER(S) 10441
		8. OFFER (Select one) GENERAL <input type="checkbox"/> ENVIRONMENTAL PRIORITY <input checked="" type="checkbox"/>	9. CONTRACT PERIOD FROM: (MM-DD-YYYY) 10-01-2013 TO: (MM-DD-YYYY) 09-30-2023
7A. COUNTY OFFICE ADDRESS (Include Zip Code) DUBUQUE COUNTY FARM SERVICE AGENCY 210 BIERMAN RD EPWORTH, IA 52045-0000		7B. TELEPHONE NUMBER (Include Area Code): (563) 876-3328	

THIS CONTRACT is entered into between the Commodity Credit Corporation (referred to as "CCC") and the undersigned owners, operators, or tenants (referred to as "the Participant"). The Participant agrees to place the designated acreage into the Conservation Reserve Program ("CRP") or other use set by CCC for the stipulated contract period from the date the Contract is executed by the CCC. The Participant also agrees to implement on such designated acreage the Conservation Plan developed for such acreage and approved by the CCC and the Participant. Additionally, the Participant and CCC agree to comply with the terms and conditions contained in this Contract, including the Appendix to this Contract, entitled Appendix to CRP-1, Conservation Reserve Program Contract (referred to as "Appendix"). By signing below, the Participant acknowledges that a copy of the Appendix for the applicable sign-up period has been provided to such person. Such person also agrees to pay such liquidated damages in an amount specified in the Appendix if the Participant withdraws prior to CCC acceptance or rejection. The terms and conditions of this contract are contained in this Form CRP-1 and in the CRP-1 Appendix and any addendum thereto. BY SIGNING THIS CONTRACT PRODUCERS ACKNOWLEDGE RECEIPT OF THE FOLLOWING FORMS: CRP-1; CRP-1 Appendix and any addendum thereto; CRP-2; CRP-2C; or CRP-2G.

10A. Rental Rate Per Acre	\$ 334.80	11. Identification of CRP Land (See Page 2 for additional space)				
10B. Annual Contract Payment	\$ 291	A. Tract No	B. Field No.	C. Practice No.	D. Acres	E. Total Estimated Cost-Share
10C. First Year Payment	\$	10441	0003	CP8A	0.61	\$ 77
(Item 10C applicable only to continuous signup when the first year payment is prorated.)		10441	0004	CP8A	0.26	\$ 33

12. PARTICIPANTS (If more than three individuals are signing, see Page 3.)			
A(1) PARTICIPANT'S NAME AND ADDRESS (Zip Code): PAUL AND MARY KLUESNER IRREVOCABLE TRUST 305 COUNTRYSIDE DR EPWORTH, IA 52045-9523	(2) SHARE 100.00%	(3) SIGNATURE <i>Paul and Mary Kluesner Irrevocable Trust By Paul Kluesner Trustee</i>	(4) DATE (MM-DD-YYYY) 2-26-2018
B(1) PARTICIPANT'S NAME AND ADDRESS (Zip Code):	(2) SHARE %	(3) SIGNATURE	(4) DATE (MM-DD-YYYY)
C(1) PARTICIPANT'S NAME AND ADDRESS (Zip Code):	(2) SHARE %	(3) SIGNATURE	(4) DATE (MM-DD-YYYY)

13. CCC USE ONLY	A. SIGNATURE OF CCC REPRESENTATIVE 	B. DATE (MM-DD-YYYY) 02-28-2018
------------------	--	------------------------------------

NOTE: The following statement is made in accordance with the Privacy Act of 1974 (5 USC 552a - as amended). The authority for requesting the information identified on this form is 7 CFR Part 1410, the Commodity Credit Corporation Charter Act (15 U.S.C. 714 et seq.), the Food Security Act of 1985 (16 U.S.C. 3801 et seq.), and the Agricultural Act of 2014 (Pub. L. 113-79). The information will be used to determine eligibility to participate in and receive benefits under the Conservation Reserve Program. The information collected on this form may be disclosed to other Federal, State, Local government agencies, Tribal agencies, and nongovernmental entities that have been authorized access to the information by statute or regulation and/or as described in applicable Routine Uses identified in the System of Records Notice for USDA/FSA-2, Farm Records File (Automated). Providing the requested information is voluntary. However, failure to furnish the requested information will result in a determination of ineligibility to participate in and receive benefits under the Conservation Reserve Program.

This information collection is exempted from the Paperwork Reduction Act as specified in the Agricultural Act of 2014 (Pub. L. 113-79, Title I, Subtitle F, Administration). The provisions of appropriate criminal and civil fraud, privacy, and other statutes may be applicable to the information provided. RETURN THIS COMPLETED FORM TO YOUR COUNTY FSA OFFICE.

The U.S. Department of Agriculture (USDA) prohibits discrimination against its customers, employees, and applicants for employment on the basis of race, color, national origin, age, disability, sex, gender identity, religion, reprisal, and where applicable, political beliefs, marital status, familial or parental status, sexual orientation, or all or part of an individual's income is derived from any public assistance program, or protected genetic information in employment or in any program or activity conducted or funded by the Department. (Not all prohibited bases will apply to all programs and/or employment activities.) Persons with disabilities, who wish to file a program complaint, write to the address below or if you require alternative means of communication for program information (e.g., Braille, large print, audiotape, etc.) please contact USDA's TARGET Center at (202) 720-2600 (voice and TDD). Individuals who are deaf, hard of hearing, or have speech disabilities and wish to file either an EEO or program complaint, please contact USDA through the Federal Relay Service at (800) 877-8339 or (800) 845-6136 (in Spanish).

If you wish to file a Civil Rights program complaint of discrimination, complete the USDA Program Discrimination Complaint Form, found online at http://www.ascr.usda.gov/complaint_filing_cust.html, or at any USDA office, or call (866) 632-9992 to request the form. You may also write a letter containing all the information requested in the form. Send your completed complaint form or letter by mail to U.S. Department of Agriculture, Director, Office of Adjudication, 1400 Independence Avenue, S.W., Washington, D.C. 20250-9410, by fax (202) 690-7442 or email at program.intake@usda.gov. USDA is an equal opportunity provider and employer.

Original - County Office Copy
 Owner's Copy
 Operator's Copy

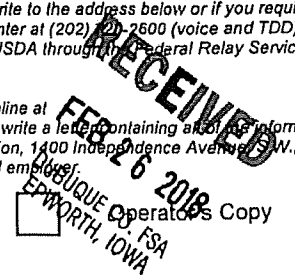

CRP-1 (10-22-15) U.S. DEPARTMENT OF AGRICULTURE Commodity Credit Corporation CONSERVATION RESERVE PROGRAM CONTRACT	1. ST. & CO CODE & ADMIN. LOCATION 19 061	2. SIGN-UP NUMBER 44
	3. CONTRACT NUMBER 10185B	4. ACRES FOR ENROLLMENT 6.40
7A. COUNTY OFFICE ADDRESS (Include Zip Code) DUBUQUE COUNTY FARM SERVICE AGENCY 210 BIERMAN RD EPWORTH, IA 52045-0000	5. FARM NUMBER 4739	6. TRACT NUMBER(S) 10442
7B. TELEPHONE NUMBER (Include Area Code): (563) 876-3328	8. OFFER (Select one) GENERAL <input type="checkbox"/> ENVIRONMENTAL PRIORITY <input checked="" type="checkbox"/>	9. CONTRACT PERIOD FROM: (MM-DD-YYYY) 10-01-2013 TO: (MM-DD-YYYY) 09-30-2023

THIS CONTRACT is entered into between the Commodity Credit Corporation (referred to as "CCC") and the undersigned owners, operators, or tenants (referred to as "the Participant"). The Participant agrees to place the designated acreage into the Conservation Reserve Program ("CRP") or other use set by CCC for the stipulated contract period from the date the Contract is executed by the CCC. The Participant also agrees to implement on such designated acreage the Conservation Plan developed for such acreage and approved by the CCC and the Participant. Additionally, the Participant and CCC agree to comply with the terms and conditions contained in this Contract, including the Appendix to this Contract, entitled Appendix to CRP-1, Conservation Reserve Program Contract (referred to as "Appendix"). By signing below, the Participant acknowledges that a copy of the Appendix for the applicable sign-up period has been provided to such person. Such person also agrees to pay such liquidated damages in an amount specified in the Appendix if the Participant withdraws prior to CCC acceptance or rejection. The terms and conditions of this contract are contained in this Form CRP-1 and in the CRP-1 Appendix and any addendum thereto. **BY SIGNING THIS CONTRACT PRODUCERS ACKNOWLEDGE RECEIPT OF THE FOLLOWING FORMS: CRP-1; CRP-1 Appendix and any addendum thereto; CRP-2; CRP-2C; or CRP-2G.**

10A. Rental Rate Per Acre	\$ 325.20	11. Identification of CRP Land (See Page 2 for additional space)				
10B. Annual Contract Payment	\$ 2,081	A. Tract No.	B. Field No.	C. Practice No.	D. Acres	E. Total Estimated Cost-Share
10C. First Year Payment	\$ <i>PK</i>	10442	0003	CP8A	1.88	\$ 237
(Item 10C applicable only to continuous signup when the first year payment is prorated.)		10442	0004	CP8A	0.73	\$ 92
		10442	0005	CP8A	0.54	\$ 68

12. PARTICIPANTS (If more than three individuals are signing, see Page 3.)			
A(1) PARTICIPANT'S NAME AND ADDRESS (Zip Code): PAUL AND MARY KLUESNER IRREVOCABLE TRUST 305 COUNTRYSIDE DR EPWORTH, IA 52045-9523	(2) SHARE 100.00%	(3) SIGNATURE <i>Paul and Mary Kluesner Irrevocable Trust by Paul Kluesner Trustee</i>	(4) DATE (MM-DD-YYYY) 2-26-2018
B(1) PARTICIPANT'S NAME AND ADDRESS (Zip Code):	(2) SHARE %	(3) SIGNATURE	(4) DATE (MM-DD-YYYY)
C(1) PARTICIPANT'S NAME AND ADDRESS (Zip Code):	(2) SHARE %	(3) SIGNATURE	(4) DATE (MM-DD-YYYY)

13. CCC USE ONLY	A. SIGNATURE OF CCC REPRESENTATIVE <i>[Signature]</i>	B. DATE (MM-DD-YYYY) 02-26-2018
-------------------------	--	------------------------------------

NOTE: The following statement is made in accordance with the Privacy Act of 1974 (5 U.S.C. 552a - as amended), the authority for requesting the information identified on this form is 7 CFR Part 1410, the Commodity Credit Corporation Charter Act (15 U.S.C. 711 et seq.), the Food Security Act of 1985 (16 U.S.C. 3801 et seq.), and the Agricultural Act of 2014 (Pub. L. 113-79). The information will be used to determine eligibility to participate in and receive benefits under the Conservation Reserve Program. The information collected on this form may be disclosed to other Federal, State, Local government agencies, Tribal agencies, and nongovernmental entities that have been authorized access to the information by statute or regulation and/or as described in applicable Routine Uses identified in the System of Records Notice for USDA/FSA-2, Farm Records File (Automated). Providing the requested information is voluntary. However, failure to furnish the requested information will result in a determination of ineligibility to participate in and receive benefits under the Conservation Reserve Program.

This information collection is exempted from the Paperwork Reduction Act as specified in the Agricultural Act of 2014 (Pub. L. 113-79, Title I, Subtitle F, Administration). The provisions of appropriate criminal and civil fraud, privacy, and other statutes may be applicable to the information provided. **RETURN THIS COMPLETED FORM TO YOUR COUNTY FSA OFFICE.**

The U.S. Department of Agriculture (USDA) prohibits discrimination against its customers, employees, and applicants for employment on the basis of race, color, national origin, age, disability, sex, gender identity, religion, reprisal, and where applicable, political beliefs, marital status, familial or parental status, sexual orientation, or all or part of an individual's income is derived from any public assistance program, or protected genetic information in employment or in any program or activity conducted or funded by the Department. (Not all prohibited bases will apply to all programs and/or employment activities.) Persons with disabilities, who wish to file a program complaint, write to the address below or if you require alternative means of communication for program information (e.g., Braille, large print, audiotape, etc.) please contact USDA's TARGET Center at (202) 720-2600 (voice and TDD). Individuals who are deaf, hard of hearing, or have speech disabilities and wish to file either an EEO or program complaint, please contact USDA through the Federal Relay Service at (800) 877-8339 or (800) 845-6136 (in Spanish).

If you wish to file a Civil Rights program complaint of discrimination, complete the USDA Program Discrimination Complaint Form, found online at http://www.ascr.usda.gov/complaint_filing_cust.html, or at any USDA office, or call (866) 632-9992 to request the form. You may also write a letter containing all of the information requested in the form. Send your completed complaint form or letter by mail to U.S. Department of Agriculture, Director, Office of Adjudication, 1400 Independence Avenue, S.W., Washington, D.C. 20250-9410, by fax (202) 690-7442 or email at program.intake@usda.gov. USDA is an equal opportunity provider and employer.

Original - County Office Copy
 Owner's Copy
 Operator's Copy

FILED
 FEB 26 2018
 DUBUQUE CO. FSA
 EPWORTH, IOWA



United States
Department of
Agriculture

Dubuque County, Iowa



Legend

- Non-Cropland
- CRP
- Iowa PLSS
- Wetland Determination
- Tract Boundary
- Iowa Roads
- Restricted Use
- Limited Restrictions
- Exempt from Conservation Compliance Provisions

2022 Program Year

Map Created February 18, 2022

Farm 4739

Tract 10441

Tract Cropland Total: 15.52 acres

United States Department of Agriculture (USDA) Farm Service Agency (FSA) maps are for FSA Program administration only. This map does not represent a legal survey or reflect actual ownership; rather it depicts the information provided directly from the producer and/or National Agricultural Imagery Program (NAIP) imagery. The producer accepts the data 'as is' and assumes all risks associated with its use. USDA-FSA assumes no responsibility for actual or consequential damage incurred as a result of any user's reliance on this data outside FSA Programs. Wetland identifiers do not represent the size, shape, or specific determination of the area. Refer to your original determination (CPA-026 and attached maps) for exact boundaries and determinations or contact USDA Natural Resources Conservation Service (NRCS).

USDA is an equal opportunity provider employer and lender



United States
Department of
Agriculture

Dubuque County, Iowa

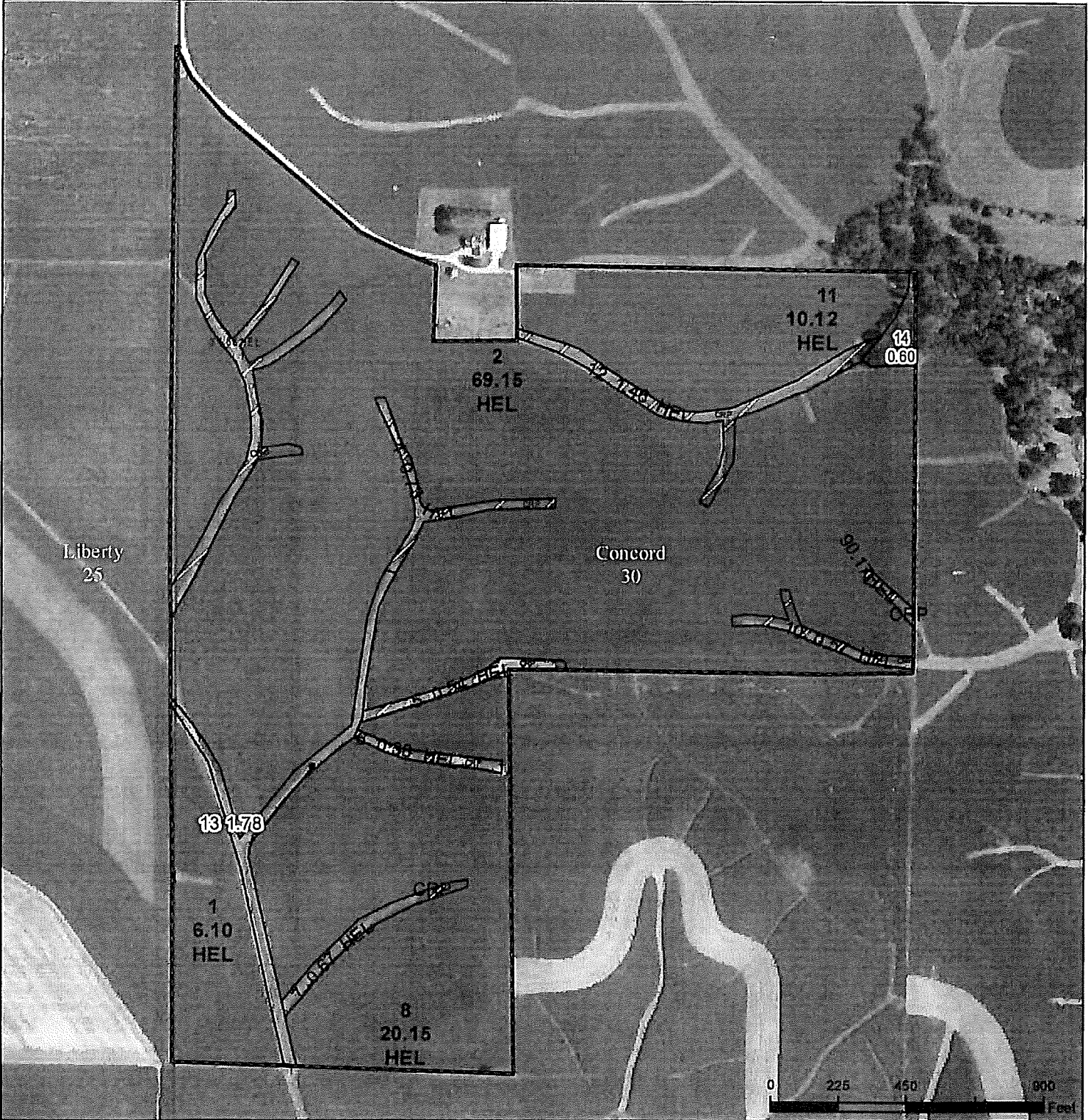

Legend

- Non-Cropland
- CRP
- Iowa PLSS
- Wetland Determination Identifiers
- Iowa Roads

- Restricted Use
- Limited Restrictions
- Exempt from Conservation
- Compliance Provisions

Tract Cropland Total: 111.92 acres

2022 Program Year

Map Created February 18, 2022

Farm **4739**
Tract **10442**

United States Department of Agriculture (USDA) Farm Service Agency (FSA) maps are for FSA Program administration only. This map does not represent a legal survey or reflect actual ownership; rather it depicts the information provided directly from the producer and/or National Agricultural Imagery Program (NAIP) imagery. The producer accepts the data 'as is' and assumes all risks associated with its use. USDA-FSA assumes no responsibility for actual or consequential damage incurred as a result of any user's reliance on this data outside FSA Programs. Wetland Identifiers do not represent the size, shape, or specific determination of the area. Refer to your original determination (CPA-026 and attached maps) for exact boundaries and determinations or contact USDA Natural Resources Conservation Service (NRCS).

USDA is an equal opportunity provider employer and lender