

# Soils Map

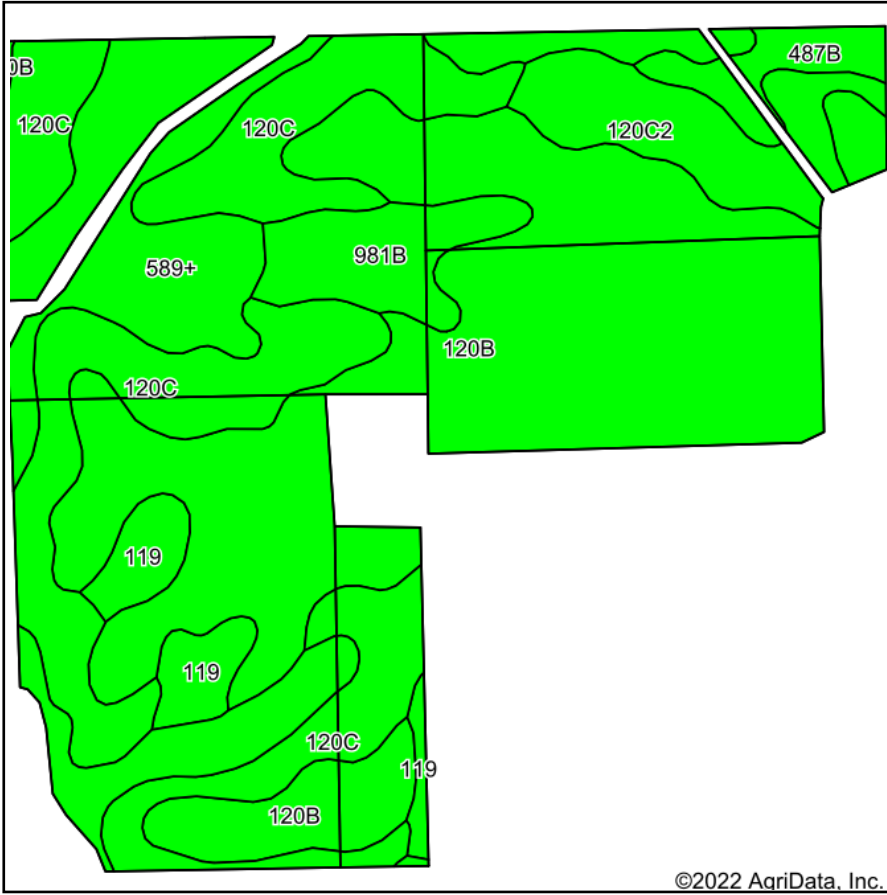

Soils data provided by USDA and NRCS.

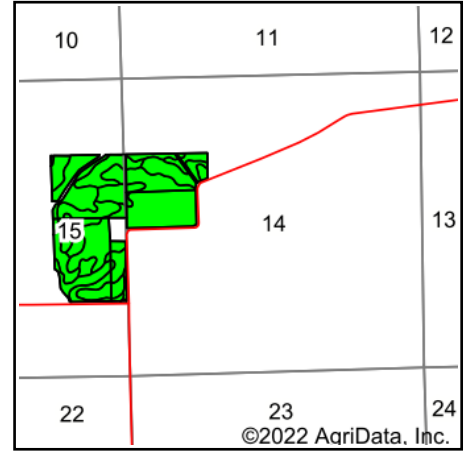

State: **Iowa**  
 County: **Dubuque**  
 Location: **15-88N-2W**  
 Township: **Dodge**  
 Acres: **112.22**  
 Date: **5/5/2022**



Maps Provided By:



© AgriData, Inc. 2021

www.AgriDataInc.com



Area Symbol: IA061, Soil Area Version: 23

Code	Soil Description	Acres	Percent of field	CSR2 Legend	Non-Irr Class *c	CSR2**	CSR	
120B	Tama silt loam, driftless, 2 to 6 percent slopes	47.77	42.6%		Ile	95	95	
120C	Tama silt loam, driftless, 5 to 9 percent slopes	27.48	24.5%		IIle	90	80	
589+	Otter silt loam, overwash, 0 to 2 percent slopes	18.36	16.4%		IIw	61	85	
120C2	Tama silt loam, driftless, 5 to 9 percent slopes, moderately eroded	6.93	6.2%		IIle	87	78	
981B	Worthen silt loam, 2 to 5 percent slopes	4.94	4.4%		Ile	94	90	
119	Muscatine silt loam, 1 to 3 percent slopes	4.12	3.7%		Ile	95	98	
487B	Otter-Worthen silt loams, 2 to 5 percent slopes	2.62	2.3%		IVw	77	69	
<b>Weighted Average</b>						<b>2.35</b>	<b>87.3</b>	<b>87.9</b>

\*\*IA has updated the CSR values for each county to CSR2.

\*c: Using Capabilities Class Dominant Condition Aggregation Method  
 Soils data provided by USDA and NRCS.