

Soils Map

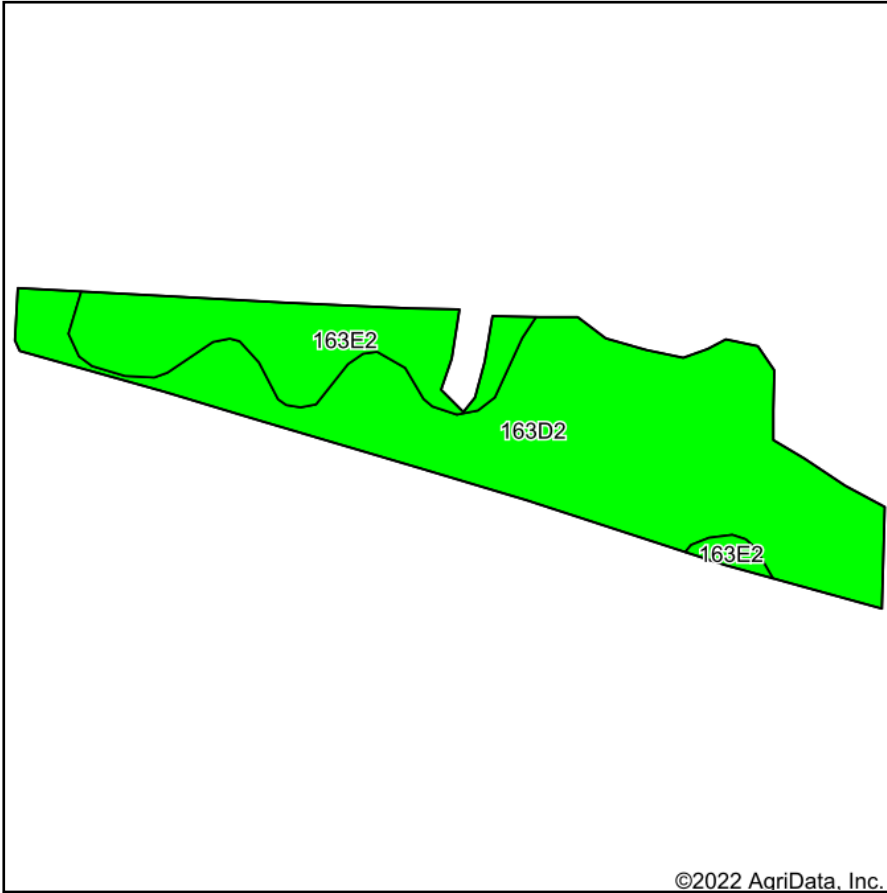

Soils data provided by USDA and NRCS.

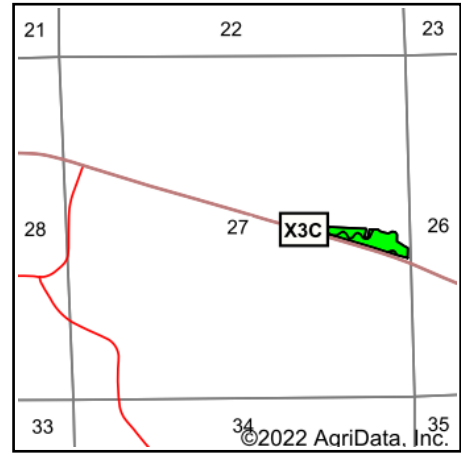

State: **Iowa**
 County: **Clayton**
 Location: **27-92N-4W**
 Township: **Volga**
 Acres: **6.62**
 Date: **5/12/2022**



Maps Provided By:



Area Symbol: IA043, Soil Area Version: 25

Code	Soil Description	Acres	Percent of field	CSR2 Legend	Non-Irr Class *c	CSR2**	CSR	
163D2	Fayette silt loam, 9 to 14 percent slopes, moderately eroded	4.91	74.2%		IIIe	46	58	
163E2	Fayette silt loam, 14 to 18 percent slopes, moderately eroded	1.71	25.8%		IVe	35	48	
Weighted Average						3.26	43.2	55.4

**IA has updated the CSR values for each county to CSR2.

*c: Using Capabilities Class Dominant Condition Aggregation Method

Soils data provided by USDA and NRCS.