

Soils Map

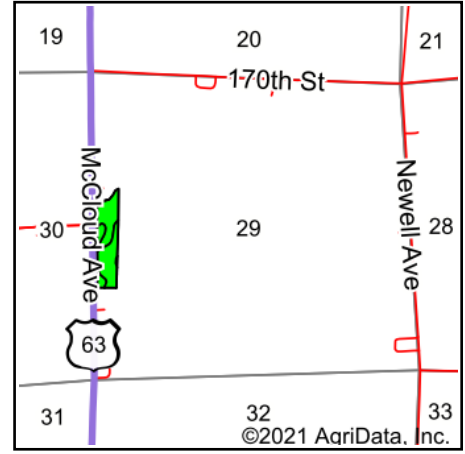

State: **Iowa**
 County: **Chickasaw**
 Location: **29-96N-12W**
 Township: **Jacksonville**
 Acres: **11.38**
 Date: **10/2/2021**

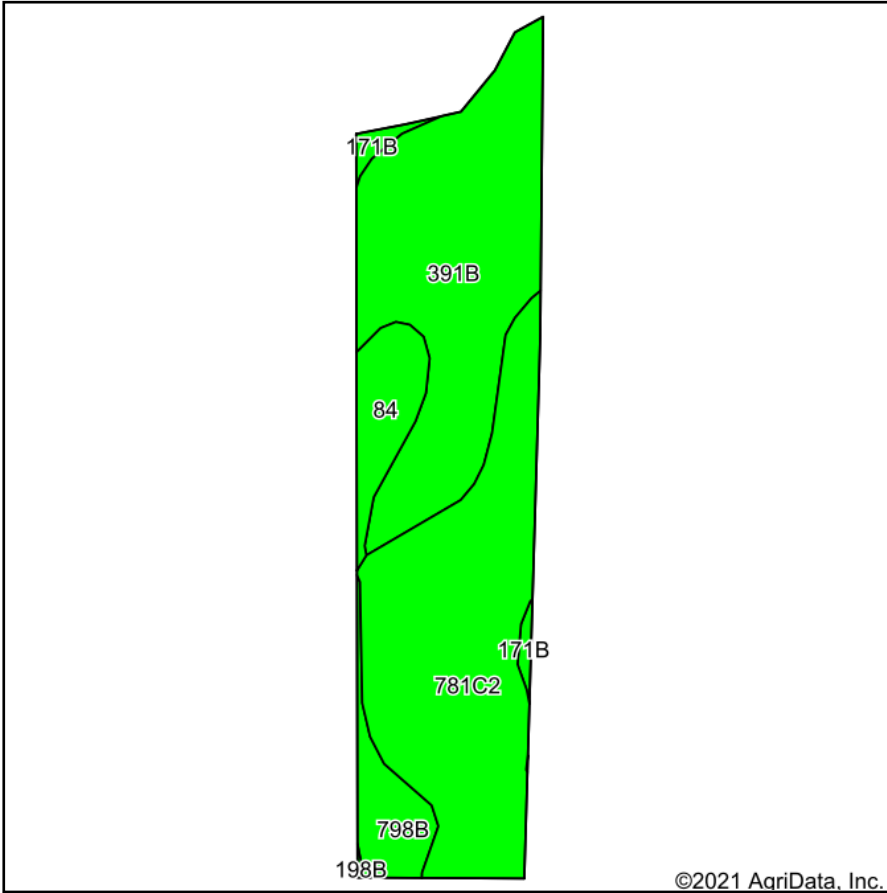

Maps Provided By:
surety
 CUSTOMIZED ONLINE MAPPING
 © AgriData, Inc. 2021 www.AgriDataInc.com



Soils data provided by USDA and NRCS.

Area Symbol: IA037, Soil Area Version: 26

Code	Soil Description	Acres	Percent of field	CSR2 Legend	Non-Irr Class *c	CSR2**	CSR	Bromegrass alfalfa	Bromegrass alfalfa hay	Corn	Kentucky bluegrass	Oats	Smooth brome	Soybeans
781C2	Lourdes loam, 5 to 9 percent slopes, moderately eroded	4.97	43.7%		Ille	67	36							
391B	Clyde-Floyd complex, 1 to 4 percent slopes	4.72	41.5%		Ilw	87	72							
84	Clyde clay loam, 0 to 3 percent slopes	0.80	7.0%		Ilw	88	74							
798B	Protivin loam, 1 to 4 percent slopes	0.71	6.2%		Ile	61	56							
171B	Bassett loam, 2 to 5 percent slopes	0.18	1.6%		Ile	85	79	10.7	6.4	215	3.9	92	6.4	62
Weighted Average						76.7	55.5	0.2	0.1	3.4	0.1	1.5	0.1	1

**IA has updated the CSR values for each county to CSR2.

*c: Using Capabilities Class Dominant Condition Aggregation Method

Soils data provided by USDA and NRCS.