

Soils Map

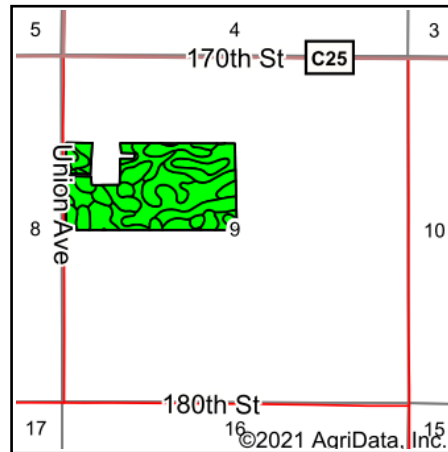

State: **Iowa**
 County: **Wright**
 Location: **9-92N-23W**
 Township: **Iowa**
 Acres: **72.04**
 Date: **9/17/2021**

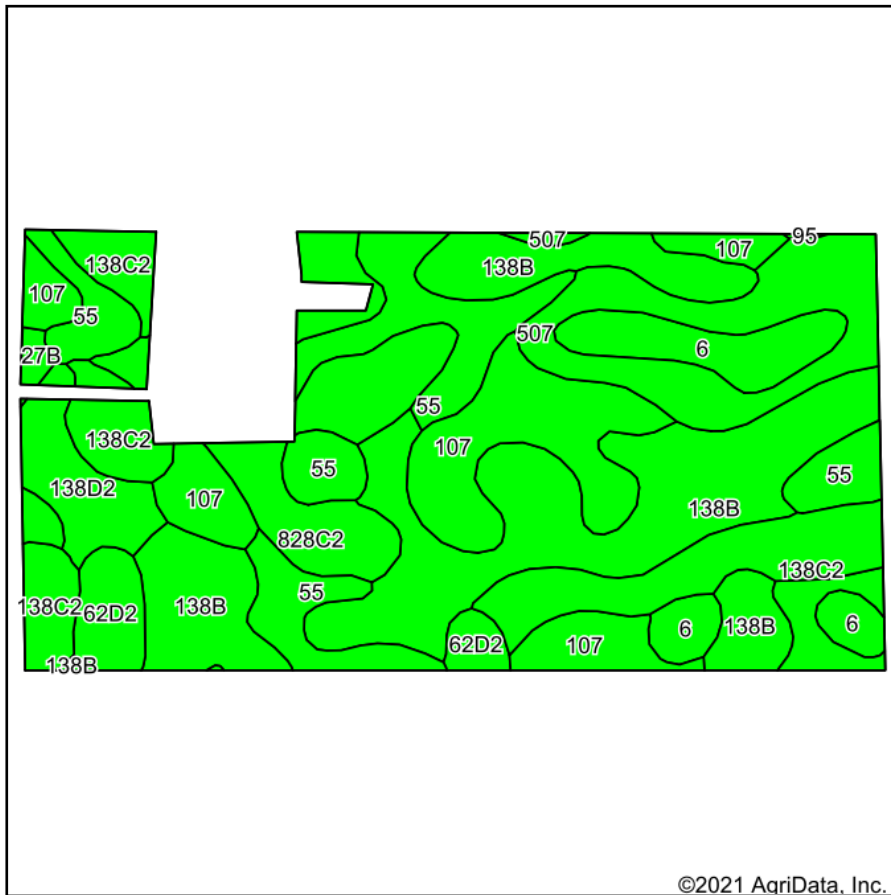

Maps Provided By:



© AgriData, Inc. 2021

www.AgriDataInc.com



Soils data provided by USDA and NRCS.

Area Symbol: IA197, Soil Area Version: 29

Code	Soil Description	Acres	Percent of field	CSR2 Legend	Non-Irr Class *c	CSR2**	CSR
138B	Clarion loam, 2 to 6 percent slopes	19.76	27.4%		Ile	89	80
107	Webster clay loam, 0 to 2 percent slopes	11.27	15.6%		Ilw	86	83
55	Nicollet clay loam, 1 to 3 percent slopes	9.42	13.1%		Iw	89	88
138C2	Clarion loam, 6 to 10 percent slopes, moderately eroded	8.59	11.9%		IIIle	83	63
507	Canisteo clay loam, 0 to 2 percent slopes	6.58	9.1%		Ilw	84	78
828C2	Zenor sandy loam, 5 to 9 percent slopes, moderately eroded	6.40	8.9%		IIIle	43	32
6	Okoboji silty clay loam, 0 to 1 percent slopes	4.34	6.0%		IIIw	59	57
138D2	Clarion loam, 9 to 14 percent slopes, moderately eroded	2.69	3.7%		IIIle	57	54
62D2	Storden loam, 10 to 16 percent slopes, moderately eroded	2.32	3.2%		IVe	41	41
27B	Terril loam, 2 to 6 percent slopes	0.67	0.9%		Ile	87	80
Weighted Average						78.7	71.4

**IA has updated the CSR values for each county to CSR2.

*c: Using Capabilities Class Dominant Condition Aggregation Method

Soils data provided by USDA and NRCS.