

Soils data provided by USDA and NRCS.

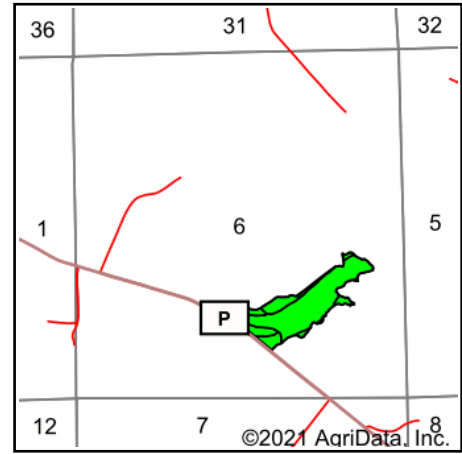

State: **Wisconsin**  
 County: **Jackson**  
 Location: **6-22N-6W**  
 Township: **Curran**  
 Acres: **26.85**  
 Date: **8/18/2021**



Maps Provided By:



© AgriData, Inc. 2021

www.AgriDataInc.com



Area Symbol: WI053, Soil Area Version: 19

Code	Soil Description	Acres	Percent of field	Non-Irr Class Legend	Non-Irr Class *c	Alfalfa hay	Bluegrass white clover	Corn	Corn silage	Grass clover	Oats	Orchardgrass alsike	Orchardgrass red clover	Red clover hay	Smooth bromegrass
1715D2	Council and Seaton soils, 12 to 20 percent slopes, moderately eroded	19.04	70.9%		Ive	4.4		115	19	6.9	60				3.6
1224F	Boone-Elevasil complex, 15 to 50 percent slopes	3.37	12.6%		Vlls		1					1.6	1.8		
628A	Orion silt loam, 0 to 3 percent slopes, occasionally flooded	1.56	5.8%		llw										
1743F	Council-Elevasil-Norden complex, 30 to 60 percent slopes	1.48	5.5%		Vlle		1.6					2.4	2.6		
9A	Houghton and Palms mucks, 0 to 1 percent slopes, frequently flooded	1.40	5.2%		Vllw	4.8	3.4	120	17		75	4.2	4.4	3.8	
<b>Weighted Average</b>						<b>3.4</b>	<b>0.4</b>	<b>87.8</b>	<b>14.4</b>	<b>4.9</b>	<b>46.5</b>	<b>0.6</b>	<b>0.6</b>	<b>0.2</b>	<b>2.6</b>

\*c: Using Capabilities Class Dominant Condition Aggregation Method  
 Soils data provided by USDA and NRCS.